

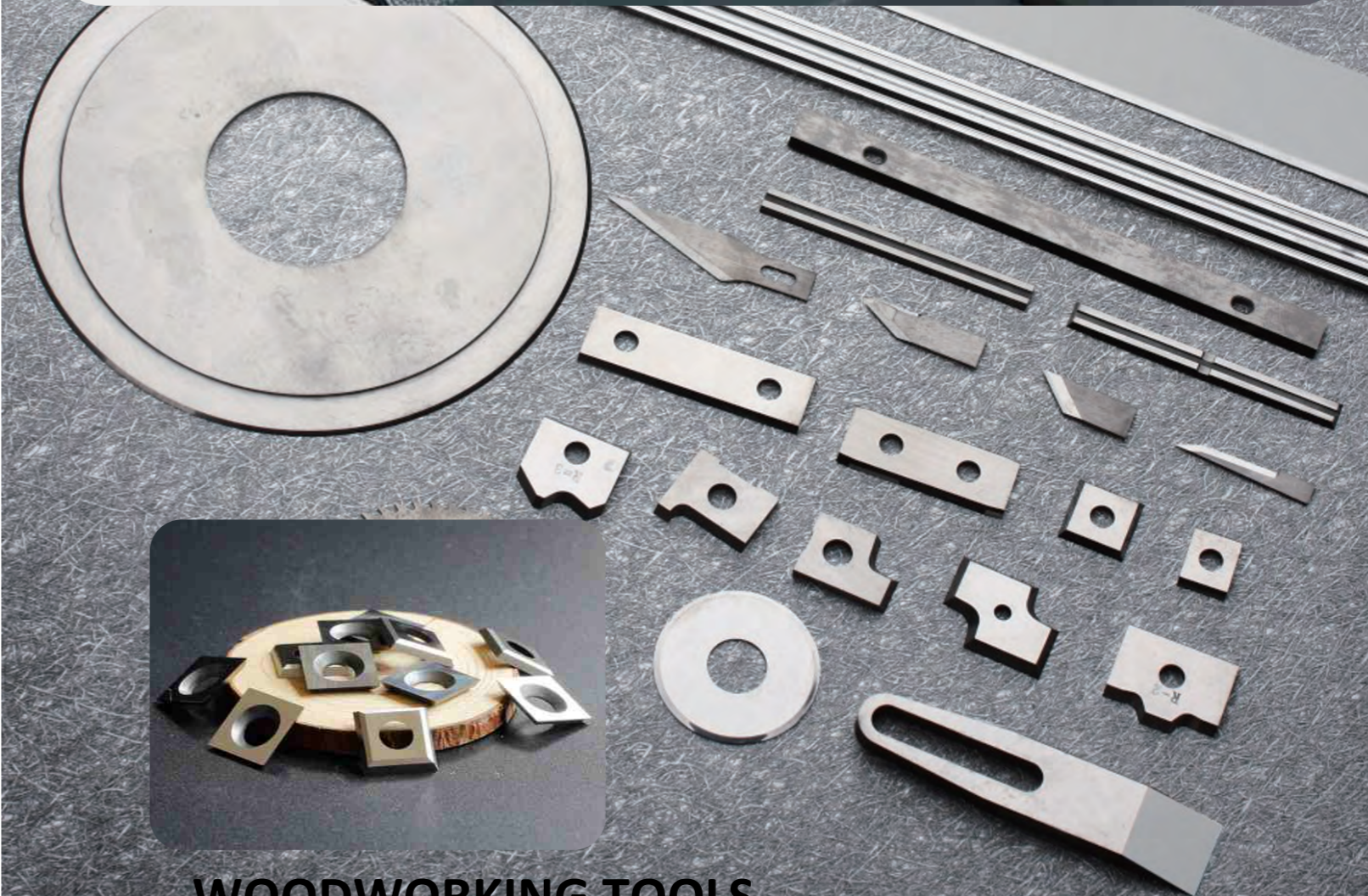

Head Office- Le sede centrale  
Corso Ventidue Marzo 33 20129  
Milano MI ITALIA  
Tel: +39 02 89732118



**WOODWORKING TOOLS**

## Woodworking Carbide Grades And Their Applications



### Woodworking Carbide Grades

Grade	ISO-Code	Binder %	Hardness	TRS (N/mm <sup>2</sup> )
EUK10UF	K05-K10	6.0	92.5	2060
EUK30UF	K20	10.0	91.5	2520
EY6X	K10	6.0	91.5	1860
EY6	K20	6.0	90.5	1800
EY8	K30	8.0	90.0	1950
EUT20	K10-K20	8.0	91.0	1920

### Woodworking Carbide Grade Selection Table

Grade	HDF/MDF	Chipboard	Hardwood	Softwood	Plywood
EUK10UF	++	++	++	-	+
EUK30UF	+	++	++	+	+
EY6X	-	+	++	++	++
EY6	-	-	++	++	+
EY8	-	-	+	++	-
EUT20	+	++	++	+	+
++	Excellent	非常好			
+	Good	好			



- Inserts for Woodworking ..... 03 – 08
- Sealing Cutters ..... 09 – 14
- Planer Knives ..... 15 – 18
- Blanks for Profiling ..... 19 – 24
- Round Cutters & Saw Cutters.... 25 – 26
- Non-Standard Parts Series ..... 27 – 28

## INSERTS FOR WOODWORKING

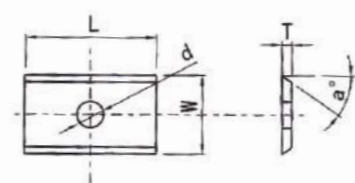

Type	Dimension					Carbide Grade			
	L	W	T	d	a	EY8	EY6X	EUK10UF	EUK30UF
8.6×12×1.5	8.6	12	1.5	4.1	35°	▲		▲▲	
9.0×12×1.5	9	12	1.5	4.1	35°	▲		▲▲	
9.6×12×1.5	9.6	12	1.5	4.1	35°	▲		▲▲	
10×12×1.5	10	12	1.5	4.1	35°	▲		▲▲	
15×12×1.5	15	12	1.5	4.1	35°	▲		▲▲	
20×12×1.5	20	12	1.5	4.1	35°	▲		▲▲	
25×12×1.5	25	12	1.5	4.1	35°	▲		▲▲	

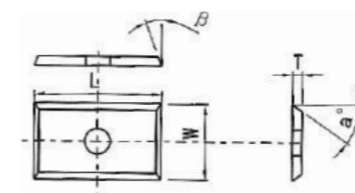

Type	Dimension					Carbide Grade			
	L	W	T	d	a	EY8	EY6X	EUK10UF	EUK30UF
8.6×12×1.5-4	8.6	12	1.5	4.1	35°	▲		▲▲	
9.0×12×1.5-4	9	12	1.5	4.1	35°	▲		▲▲	
9.6×12×1.5-4	9.6	12	1.5	4.1	35°	▲		▲▲	
10×12×1.5-4	10	12	1.5	4.1	35°	▲		▲▲	
15×12×1.5-4	15	12	1.5	4.1	35°	▲		▲▲	
20×12×1.5-4	20	12	1.5	4.1	35°	▲		▲▲	
25×12×1.5-4	25	12	1.5	4.1	35°	▲		▲▲	

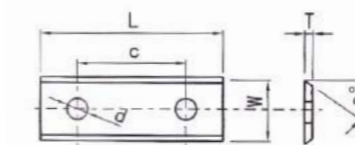

Type	Dimension						Carbide Grade			
	L	W	T	c	d	a	EY8	EY6X	EUK10UF	EUK30UF
24.7×12×1.5	24.7	12	1.5	14.00	4.1	35°	▲	▲	▲▲	
25×12×1.5	25	12	1.5	14.00	4.1	35°	▲	▲	▲▲	
29.5×12×1.5	29	12	1.5	14.00	4.1	35°	▲	▲	▲▲	
30×12×1.5	30	12	1.5	14.00	4.1	35°	▲	▲	▲▲	
40×12×1.5	40	12	1.5	26.00	4.1	35°	▲	▲	▲▲	
50×12×1.5	50	12	1.5	26.00	4.1	35°	▲	▲	▲▲	
60×12×1.5	60	12	1.5	26.00	4.1	35°	▲	▲	▲▲	
63.5×12×1.5	63.5	12	1.5	26.00	4.1	35°	▲	▲	▲▲	
70×12×1.5	70	12	1.5	34.00	4.1	35°	▲	▲	▲▲	

### INSERTS FOR WOODWORKING

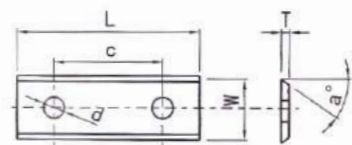

Type	Dimension						Carbide Grade			
	L	W	T	c	a	β	EY8	EY6X	EUK10UF	EUK30UF
29.5×12×1.5-4	29.5	12	1.5	14.00	35°	35°	▲		▲▲	
39.5×12×1.5-4	39.5	12	1.5	26.00	35°	35°	▲		▲▲	
49.5×12×1.5-4	49.5	12	1.5	26.00	35°	35°	▲		▲▲	
59.5×12×1.5-4	59.5	12	1.5	26.00	35°	35°	▲		▲▲	
70×12×1.5-4	70	12	1.5	34.00	35°	35°	▲		▲▲	

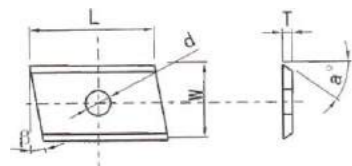

Type	STYLE CTKFC. . .						Carbide Grade			
	L	W	T	a	β		EY8	EY6X	EUK10UF	EUK30UF
18×12×1.5Y-5°	18	12	1.5	35°	5°			▲	▲▲	
19.4×12×1.5Y-10°	19.4	12	1.5	35°	10°			▲	▲▲	
19.5×12×1.5Y-15°	19.5	12	1.5	35°	15°			▲	▲▲	

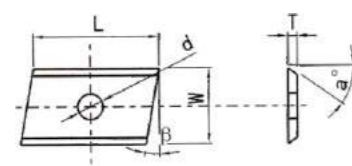

Type	STYLE CTKFC. . .						Carbide Grade			
	L	W	T	a	β		EY8	EY6X	EUK10UF	EUK30UF
18×12×1.5Y-5°	18	12	1.5	35°	5°			▲	▲▲	
19.4×12×1.5Y-10°	19.4	12	1.5	35°	10°			▲	▲▲	
19.5×12×1.5Y-15°	19.5	12	1.5	35°	15°			▲	▲▲	

### INSERTS FOR WOODWORKING

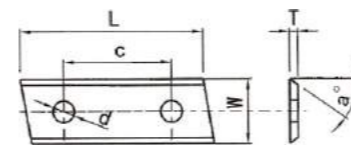

Type	STYLE CTKFC. . .						Carbide Grade			
	L	W	T	c	a	β	EY8	EY6X	EUK10UF	EUK30UF
29.5×12×1.5Y-5°	29.6	12	1.5	14	35°	5°		▲	▲▲	
30×12×1.5Y-5°	30	12	1.5	14	35°	5°		▲	▲▲	
40×12×1.5Y-5°	40	12	1.5	14	35°	5°		▲	▲▲	
49.5×12×1.5Y-5°	49.5	12	1.5	26	35°	5°		▲	▲▲	
50×12×1.5Y-5°	50	12	1.5	26	35°	5°		▲	▲▲	

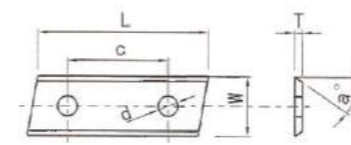

Type	STYLE CTKFC. . .						Carbide Grade			
	L	W	T	c	a	β	EY8	EY6X	EUK10UF	EUK30UF
29.5×12×1.5Z-5°	29.6	12	1.5	14	35°	5°		▲	▲▲	
30×12×1.5Z-5°	30	12	1.5	14	35°	5°		▲	▲▲	
40×12×1.5Z-5°	40	12	1.5	14	35°	5°		▲	▲▲	
49.5×12×1.5Z-5°	49.5	12	1.5	26	35°	5°		▲	▲▲	
50×12×1.5Z-5°	50	12	1.5	26	35°	5°		▲	▲▲	

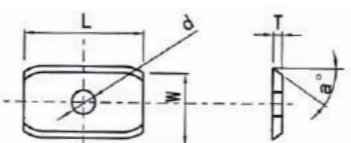

Type	Dimension					Carbide Grade			
	L	W	T	a	d	EY8	EY6X	EUK10UF	EUK30UF
20×12×1.5-R	20	12	1.5	35°	4.1	▲		▲▲	

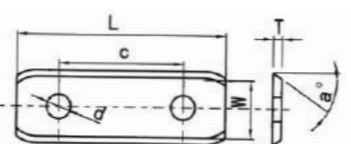

Type	Dimension						Carbide Grade			
	L	W	T	C	d	a	EY8	EY6X	EUK10UF	EUK30UF
30×12×1.5R	30	12	1.5	14.00	4.1	35°	▲		▲▲	
50×12×1.5R	50	12	1.5	26.00	4.1	35°	▲		▲▲	

### INSERTS FOR WOODWORKING

### INSERTS FOR WOODWORKING

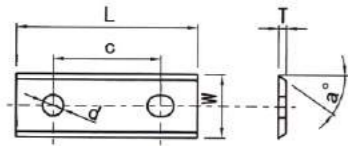

Type	Dimension					Carbide Grade			
	L	W	T	C	a	EY8	EY6X	EUK10UF	EUK30UF
50×9.2×1.6	50	9.2	1.6	26.15	24°	▲		▲▲	
79.85×13×2.2	79.85	13	2.2	60	35°	▲		▲▲	
80×12×2.2	80	12	2.2	60	35°	▲		▲▲	
100×12×2.2	100	12	2.2	60	35°	▲			▲
120×12×2.2	120	12	2.2	60	35°	▲			▲
80×13×2.2	80	13	2.2	60	35°	▲		▲▲	
100×13×2.2	100	13	2.2	60	35°	▲			▲
120×13×2.2	120	13	2.2	60	35°	▲			▲
130×13×2.2	130	13	2.2	60	35°	▲			▲
315×12×2.0	318	12	2	198	45°	▲			▲

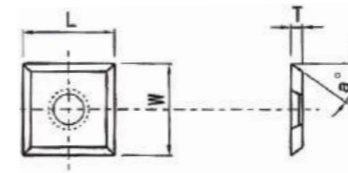

Type	Dimension					Carbide Grade			
	L	W	T	a	d	EY8	EY6X	EUK10UF	EUK30UF
14×14×1.2	14	14	1.2	30°	8.54	▲		▲▲	
14×14×1.7	14	14	1.7	30°	8.54	▲		▲▲	
14×14×2	14	14	2	30°	6.5	▲		▲▲	
14×14×2-35°	14	14	2	35°	6.5	▲		▲▲	
14×14×2-37°	14	14	2	37°	6.5	▲		▲▲	
13.6×13.6×2-35°	13.6	13.6	2	30°	6.5	▲		▲▲	
14.3×14.3×2.5-35°	14.3	14.3	2.5	35°	6.3	▲		▲▲	
14.6×14.6×2.5-35°	14.6	14.6	2.5	35°	6.3	▲		▲▲	
15×15×2.5-30°	15	15	2.5	35°	6.25	▲		▲▲	
15×15×2.5-35°	15	15	2.5	35°	6.25	▲		▲▲	

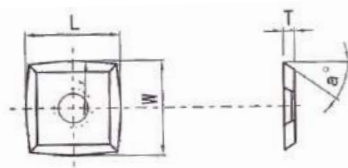

Type	Dimension					Carbide Grade			
	L	W	T	a	r	EY8	EY6X	EUK10UF	EUK30UF
15×15×2.5-R50	15	15	2.5	30°	50	▲		▲▲	
15×15×2.5-R150	15	15	2.5	30°	150	▲		▲▲	

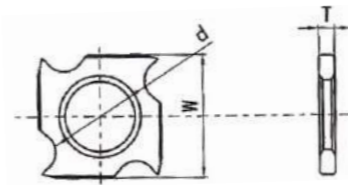

Type	Dimension				Carbide Grade			
	L	W	T	d	EY8	EY6X	EUK10UF	EUK30UF
14×14×-φ8.4	14	14	2	8.4	▲		▲▲	
18×18×1.95-φ10.3	18	18	1.95	10.3	▲		▲▲	
18×18×2.45-φ10.3	18	18	2.45	10.3	▲		▲▲	
18×18×2.95-φ10.3	18	18	2.95	10.3	▲		▲▲	
18×18×3.7-φ10.3	18	18	3.7	10.3	▲		▲▲	

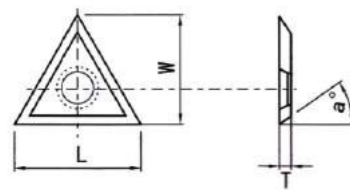

Type	Dimension				Carbide Grade			
	L	W	T	a	EY8	EY6X	EUK10UF	EUK30UF
22×19×2	22	19	2	30°	▲		▲▲	

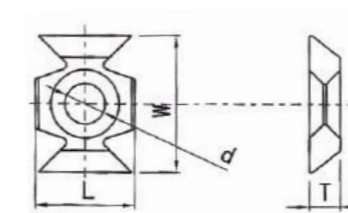

Type	Dimension					Carbide Grade			
	L	W	T	d	R	EY8	EY6X	EUK10UF	EUK30UF
YW22×16×5-R3	16	22	5	6.5	3			▲▲	

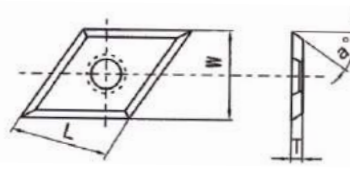

Type	Dimension				Carbide Grade			
	L	W	T	a	EY8	EY6X	EUK10UF	EUK30UF
D14×14×2-30°	14	14	2	30°	▲		▲▲	
D16×16×3-32°	16	14	3	32°	▲		▲▲	
D16×16×3-30°	16	16	3	30°	▲		▲▲	

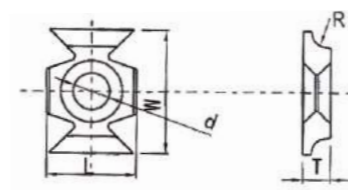

Type	Dimension					Carbide Grade			
	L	W	T	d	a°	EY8	EY6X	EUK10UF	EUK30UF
YW22×16×5-38°	16	22	5	6.5	38°			▲▲	

## SEALING CUTTERS

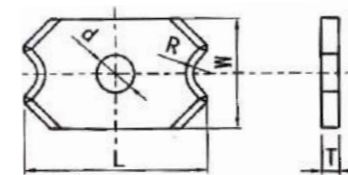

Type	Dimension					Carbide Grade			
	L	W	T	d	R	EY8	EY6X	EUK10UF	EUK30UF
S2012R1	20	12	2	4.00	1	▲		▲▲	
S2012R2	20	12	2	4.00	2	▲		▲▲	
S2012R3	20	12	2	4.00	3	▲		▲▲	
S2012R2.5	20	12	2	4.00	2.5	▲		▲▲	
S2012R4	20	12	2	4.00	4	▲		▲▲	
S2012R5	20	12	2	4.50	5	▲		▲▲	
S2018R3	20	17.5	2	4.00	3	▲		▲▲	

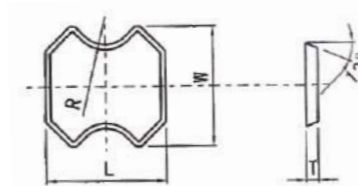

Type	Dimension				Carbide Grade			
	L	W	T	R	EY8	EY6X	EUK10UF	EUK30UF
M127R2	12.7	14	3.2	2	▲		▲▲	
M127R3	12.7	14	3.2	3	▲		▲▲	

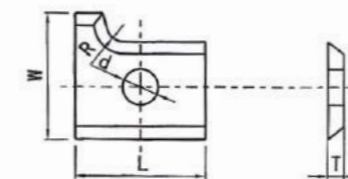

Type	Dimension					Carbide Grade			
	L	W	T	d	R	EY8	EY6X	EUK10UF	EUK30UF
L12×14.5R2R-1	12	14.5	2	4.10	2	▲		▲▲	
L12×14.5R2.5R-1	12	14.5	2	4.10	2.5	▲		▲▲	
L12×14.5R3R-1	12	14.5	2	4.10	3	▲		▲▲	
L20×14.5R1R-1	20	12	1.5	4.10	1	▲		▲▲	
L20×14.5R1.5R-1	20	12	1.5	4.10	1.5	▲		▲▲	
L20×14.5R3R-1	19.6	15.2	2	4.10	3	▲		▲▲	

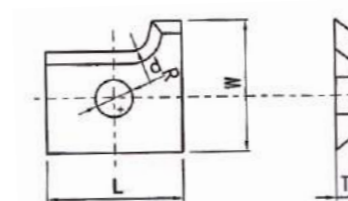

Type	Dimension					Carbide Grade			
	L	W	T	d	R	EY8	EY6X	EUK10UF	EUK30UF
L12×14.5R2L-1	12	14.5	2	4.10	2	▲		▲▲	
L12×14.5R2.5L-1	12	14.5	2	4.10	2.5	▲		▲▲	
L12×14.5R3L-1	12	14.5	2	4.10	3	▲		▲▲	
L20×14.5R1L-1	20	12	1.5	4.10	1	▲		▲▲	
L20×14.5R1.5L-1	20	12	1.5	4.10	1.5	▲		▲▲	
L20×14.5R3L-1	19.6	15.2	2	4.10	3	▲		▲▲	

SEALING CUTTERS

### SEALING CUTTERS

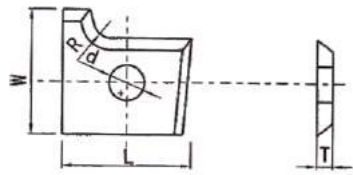

Type	Dimension					Carbide Grade			
	L	W	T	d	R	EY8	EY6X	EUK10UF	EUK30UF
L12×18R3R-2	12	18	2	4	2	▲		▲▲	
L12×18R2.5R-2	12	18	2	4	3	▲		▲▲	

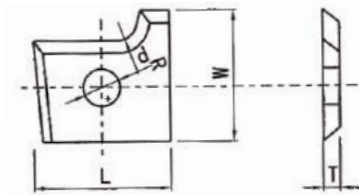

Type	Dimension					Carbide Grade			
	L	W	T	d	R	EY8	EY6X	EUK10UF	EUK30UF
L12×18R3L-2	12	18	2	4	2	▲		▲▲	
L12×18R2.5L-2	12	18	2	4	3	▲		▲▲	

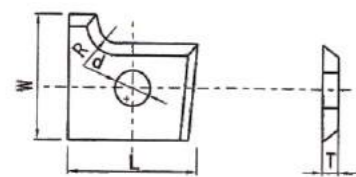

Type	Dimension					Carbide Grade			
	L	W	T	d	R	EY8	EY6X	EUK10UF	EUK30UF
L12×14.5R2R-3	15	14.5	2	4	2	▲		▲▲	
L12×14.5R2.5R-3	15	14.5	2	4	2.5	▲		▲▲	
L12×14.5R3R-3	15	14.5	2	4	3	▲		▲▲	

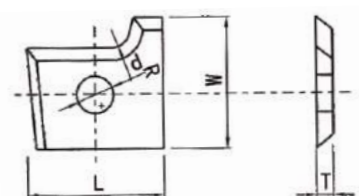

Type	Dimension					Carbide Grade			
	L	W	T	d	R	EY8	EY6X	EUK10UF	EUK30UF
L12×14.5R2L-3	15	14.5	2	4	2	▲		▲▲	
L12×14.5R2.5L-3	15	14.5	2	4	2.5	▲		▲▲	
L12×14.5R3L-3	15	14.5	2	4	3	▲		▲▲	

### SEALING CUTTERS

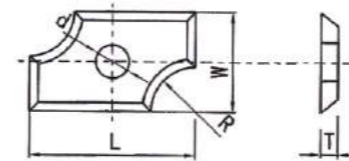

Type	Dimension					Carbide Grade			
	L	W	T	d	R	EY8	EY6X	EUK10UF	EUK30UF
N20×16R3R-1	20	18	2	3	2	▲		▲▲	
N19.8×11.6R3R-1	19.8	11.6	1.3	4.0	2	▲		▲▲	
N30×14R2R-1	30	14	2	4	2	▲		▲▲	
N30×14R2.5R-1	30	14	2	4	2.5	▲		▲▲	
N30×14R3R-1	30	14	2	4	2	▲		▲▲	

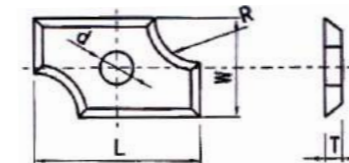

Type	Dimension					Carbide Grade			
	L	W	T	d	R	EY8	EY6X	EUK10UF	EUK30UF
N20×16R3L-1	20	18	2	3	2	▲		▲▲	
N19.8×11.6R3L-1	19.8	11.6	1.3	4.0	2	▲		▲▲	
N30×14R2L-1	30	14	2	4	2	▲		▲▲	
N30×14R2.5L-1	30	14	2	4	2.5	▲		▲▲	
N30×14R3L-1	30	14	2	4	2	▲		▲▲	

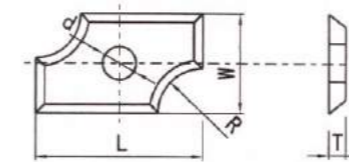

Type	Dimension					Carbide Grade			
	L	W	T	d	R	EY8	EY6X	EUK10UF	EUK30UF
N19.5×9R2R-2	19.5	9	1.5	4	2	▲		▲▲	
N19.5×9R3R-2	19.5	9	1.5	4	3	▲		▲▲	
N19.5×9R4R-2	19.5	9	1.5	4	4	▲		▲▲	
N19.5×9R5R-2	19.5	9	1.5	4	5	▲		▲▲	

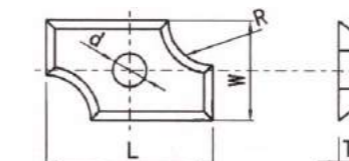

Type	Dimension					Carbide Grade			
	L	W	T	d	R	EY8	EY6X	EUK10UF	EUK30UF
N19.5×9R2L-2	19.5	9	1.5	4	2	▲		▲▲	
N19.5×9R3L-2	19.5	9	1.5	4	3	▲		▲▲	
N19.5×9R4L-2	19.5	9	1.5	4	4	▲		▲▲	
N19.5×9R5L-2	19.5	9	1.5	4	5	▲		▲▲	

### SEALING CUTTERS

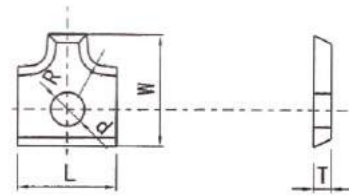

Type	Dimension					Carbide Grade			
	L	W	T	d	R	EY8	EY6X	EUK10UF	EUK30UF
R16×17R2(2.5/3)-Φ3	16	17	2	3.00	2/2.5/3	▲		▲▲	
R16×17R2(2.5/3)-Φ3.6	16	17	2	3.60	2/2.5/3	▲		▲▲	
R16×17R2(2.5/3)-Φ4	16	17	2	4.00	2/2.5/3	▲		▲▲	
R16×17R2(2.5/3)-Φ4.5	16	17	2	4.50	2/2.5/3	▲		▲▲	
R16×17.5R2(2.5/3)-Φ3	16	17.5	2	3.00	2/2.5/3	▲		▲▲	
R16×17.5R2(2.5/3)-Φ3.6	16	17.5	2	3.60	2/2.5/3	▲		▲▲	
R16×17.5R2(2.5/3)-Φ4	16	17.5	2	4.00	2/2.5/3	▲		▲▲	
R16×17.5R2(2.5/3)-Φ4.5	16	17.5	2	4.50	2/2.5/3	▲		▲▲	
R20×12R2(2.5/3)-Φ4	20	12	1.5	4.00	2/2.5/3	▲		▲▲	

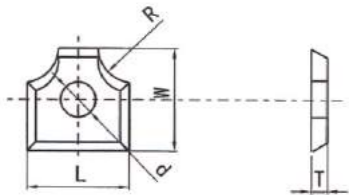

Type	Dimension					Carbide Grade			
	L	W	T	d	R	EY8	EY6X	EUK10UF	EUK30UF
R12×12R2	12	12	1.5	4	2	▲		▲▲	
R12×12R3	12	12	1.5	4	3	▲		▲▲	
R12×12R4	12	12	1.5	4	4	▲		▲▲	
R12×13R2	12	13	2	5	2	▲		▲▲	
R12×13R3	12	13	2	5	3	▲		▲▲	
R12×13R4	12	13	2	4	4	▲		▲▲	

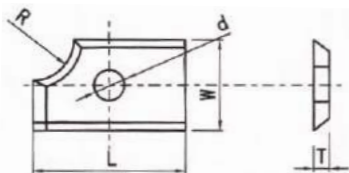

Type	Dimension					Carbide Grade			
	L	W	T	d	R	EY8	EY6X	EUK10UF	EUK30UF
N14.5×12R1.8R-2	14.5	12	1.5	4	2	▲		▲▲	
N14.5×12R3R-2	14.5	12	1.5	4	3	▲		▲▲	

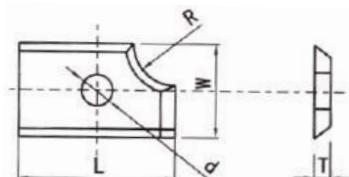

Type	Dimension					Carbide Grade			
	L	W	T	d	R	EY8	EY6X	EUK10UF	EUK30UF
N14.5×12R1.8L-2	14.5	12	1.5	4	2	▲		▲▲	
N14.5×12R3L-2	14.5	12	1.5	4	3	▲		▲▲	

### SEALING CUTTERS

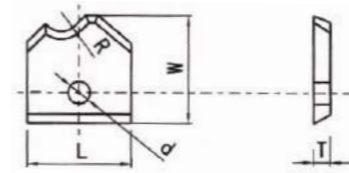

Type	Dimension					Carbide Grade			
	L	W	T	d	R	EY8	EY6X	EUK10UF	EUK30UF
X16×17R1.5R-Φ4.3	16	17	2	4.30	1.5	▲		▲▲	
X16×17R2R-Φ3.4	16	17	2	3.40	2	▲		▲▲	
X16×17R2R-Φ4	16	17	2	4.00	2	▲		▲▲	
X16×17R2R-Φ4.2	16	17	2	4.20	2	▲		▲▲	
X16×17R2R-Φ4.3	16	17	2	4.30	2	▲		▲▲	
X16×17R3R-Φ3.4	16	17	2	3.40	3	▲		▲▲	
X16×17R3R-Φ4	16	17	2	4.00	3	▲		▲▲	
X16×17R3R-Φ4.2	16	17	2	4.20	3	▲		▲▲	
X16×17R3R-Φ4.3	16	17	2	4.30	3	▲		▲▲	
X16×17R3R-Φ4.4	16	17	2	4.40	3	▲		▲▲	

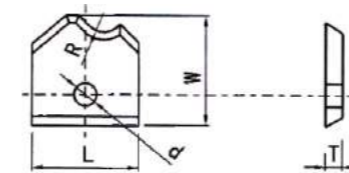

Type	Dimension					Carbide Grade			
	L	W	T	d	R	EY8	EY6X	EUK10UF	EUK30UF
X16×17R1.5L-Φ4.3	16	17	2	4.30	1.5	▲		▲▲	
X16×17R2L-Φ3.4	16	17	2	3.40	2	▲		▲▲	
X16×17R2L-Φ4	16	17	2	4.00	2	▲		▲▲	
X16×17R2L-Φ4.2	16	17	2	4.20	2	▲		▲▲	
X16×17R2L-Φ4.3	16	17	2	4.30	2	▲		▲▲	
X16×17R3L-Φ3.4	16	17	2	3.40	3	▲		▲▲	
X16×17R3L-Φ4	16	17	2	4.00	3	▲		▲▲	
X16×17R3L-Φ4.2	16	17	2	4.20	3	▲		▲▲	
X16×17R3L-Φ4.3	16	17	2	4.30	3	▲		▲▲	
X16×17R3L-Φ4.4	16	17	2	4.40	3	▲		▲▲	

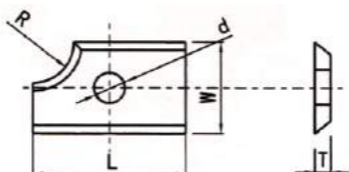

Type	Dimension					Carbide Grade			
	L	W	T	d	R	EY8	EY6X	EUK10UF	EUK30UF
N20×12R3R-1	20	12	1.5	4.00	3	▲		▲▲	

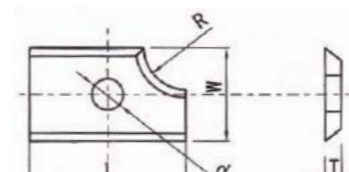

Type	Dimension					Carbide Grade			
	L	W	T	d	R	EY8	EY6X	EUK10UF	EUK30UF
N20×12R3L-1	20	12	1.5	4.00	3	▲		▲▲	





## PLANER KNIVES

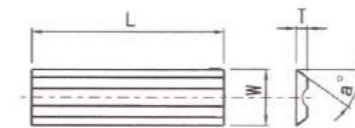

Type	Dimension				Carbide Grade			
	L	W	T	a	EY8	EY6X	EUK10UF	EUK30UF
60×5.5×1.1	60	5.5	1.1	35°	▲			
75×5.5×1.1	75	5.5	1.1	35°	▲			
76×5.5×1.1	76	5.5	1.1	35°	▲			
78×5.5×1.1	78	5.5	1.1	35°	▲			
80×5.5×1.1	80	5.5	1.1	35°	▲			
80.5×5.9×1.2	80.5	5.9	1.2	35°	▲			
82×5.5×1.1	82	5.5	1.1	35°	▲			
102×5.5×1.1	102	5.5	1.1	35°	▲			

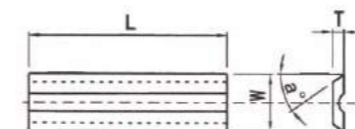

Type	Dimension				Carbide Grade			
	L	W	T	a	EY8	EY6X	EUK10UF	EUK30UF
60×5.5×1.1-F	60	5.5	1.1	35°	▲			
75×5.5×1.1-F	75	5.5	1.1	35°	▲			
76×5.5×1.1-F	76	5.5	1.1	35°	▲			
78×5.5×1.1-F	78	5.5	1.1	35°	▲			
80×5.5×1.1-F	80	5.5	1.1	35°	▲			
80.5×5.9×1.2-F	80.5	5.9	1.2	35°	▲			
82×5.5×1.1-F	82	5.5	1.1	35°	▲			
102×5.5×1.1-F	102	5.5	1.1	35°	▲			

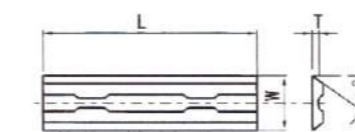

Type	Dimension				Carbide Grade			
	L	W	T	a	EY8	EY6X	EUK10UF	EUK30UF
56×5.5×1.1P0	56	5.5	1.1	35°	▲			
75.5×5.5×1.1P0	75.5	5.5	1.1	35°	▲			
78×5.5×1.1P0	78	5.5	1.1	35°	▲			
80.5×5.9×1.2P0	80.5	5.9	1.2	40°	▲			
82×5.5×1.1P0	82	5.5	1.1	35°	▲			
92×5.5×1.1P0	92	5.9	1.1	35°	▲			
102×5.5×1.1P0	102	5.5	1.1	35°	▲			

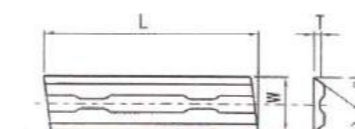

Type	Dimension					Carbide Grade			
	L	W	T	a	β	EY8	EY6X	EUK10UF	EUK30UF
80.5×5.9×1.2P	80.5	5.9	1.2	40.00	8	▲			
82×5.5×1.1P3	82	35.609	1.1		3	▲			

PLANER KNIVES

### PLANER KNIVES

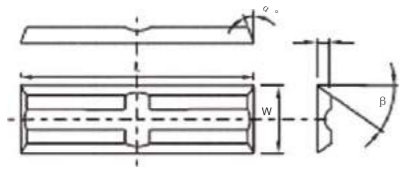

STYLE CTK MK 20----					Code	
L	W	T	$\alpha$	$\beta$	EY6	EUK10UF
20	4.1	1.1	35.00	35	▲▲	▲
20	5.5	1.1	35.00	35	▲▲	▲
25	5.5	1.1	35.00	35	▲▲	▲
30	5.5	1.1	35.00	35	▲▲	▲
30	5.5	1.1	35.00	35	▲▲	▲
40	5.5	1.1	35.00	35	▲▲	▲
50	5.5	1.1	35.00	35	▲▲	▲

### PLANER KNIVES

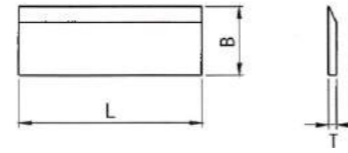

Type	Dimension				Carbide Grade			
	L	W	T	a	EY8	EY6X	EUK10UF	EUK30UF
60×30×3-35° /40° /45°	60	30	3	35° /40° /45°	▲		▲▲	
80×30×3-35° /40° /45°	80	30	3	35° /40° /45°	▲		▲▲	
100×30×3-35° /40° /45°	100	30	3	35° /40° /45°	▲		▲▲	
110×30×3-35° /40° /45°	110	30	3	35° /40° /45°	▲		▲▲	
120×30×3-35° /40° /45°	120	30	3	35° /40° /45°	▲		▲▲	
130×30×3-35° /40° /45°	130	30	3	35° /40° /45°	▲		▲▲	
150×30×3-35° /40° /45°	150	30	3	35° /40° /45°	▲		▲▲	
180×30×3-35° /40° /45°	180	30	3	35° /40° /45°	▲		▲▲	
210×30×3-35° /40° /45°	210	30	3	35° /40° /45°	▲		▲▲	
230×30×3-35° /40° /45°	230	30	3	35° /40° /45°	▲		▲▲	
240×30×3-35° /40° /45°	240	30	3	35° /40° /45°	▲		▲▲	
260×30×3-35° /40° /45°	260	30	3	35° /40° /45°	▲		▲▲	
310×30×3-35° /40° /45°	310	30	3	35° /40° /45°	▲		▲▲	
330×30×3-35° /40° /45°	330	30	3	35° /40° /45°	▲		▲▲	
100×30×4-35° /40° /45°	100	30	4	35° /40° /45°	▲		▲▲	
110×30×4-35° /40° /45°	110	30	4	35° /40° /45°	▲		▲▲	
120×30×4-35° /40° /45°	120	30	4	35° /40° /45°	▲		▲▲	
130×30×4-35° /40° /45°	130	30	4	35° /40° /45°	▲		▲▲	
150×30×4-35° /40° /45°	150	30	4	35° /40° /45°	▲		▲▲	
180×30×4-35° /40° /45°	180	30	4	35° /40° /45°	▲		▲▲	
210×30×4-35° /40° /45°	210	30	4	35° /40° /45°	▲		▲▲	
230×30×4-35° /40° /45°	230	30	4	35° /40° /45°	▲		▲▲	
240×30×4-35° /40° /45°	240	30	4	35° /40° /45°	▲		▲▲	
260×30×4-35° /40° /45°	260	30	4	35° /40° /45°	▲		▲▲	
310×30×4-35° /40° /45°	310	30	4	35° /40° /45°	▲		▲▲	
330×30×4-35° /40° /45°	330	30	4	35° /40° /45°	▲		▲▲	

### PLANER KNIVES KNIFE BLANKS

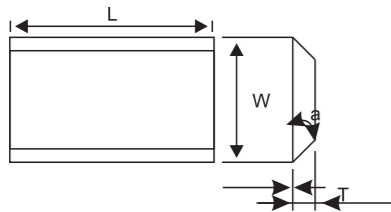

Type	Dimension				Carbide Grade			
	L	W	T	a	EY8	EY6X	EUK10UF	EUK30UF
464×14.6×2.7-35° /40° /45°	464	14.6	2.7	35° /40° /45°	▲		▲▲	
484×16.6×3.2-35° /40° /45°	484	16.6	3.2	35° /40° /45°	▲		▲▲	
524×16.6×3.2-35° /40° /45°	524	16.6	3.2	35° /40° /45°	▲		▲▲	
544×16.6×3.2-35° /40° /45°	544	16.6	3.2	35° /40° /45°	▲		▲▲	
604×14.6×2.7-35° /40° /45°	604	14.6	2.7	35° /40° /45°	▲		▲▲	

# Blanks for profiling

## BLANKS FOR PROFILING

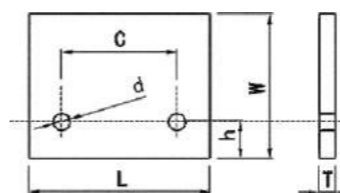

STYLE TSL ST 20-...						Code	
L	W	T	C	h	d	EUK10UF	EUK01
30	20.5	2	14.00	6.5	4.2	3021W05	3021W06
30	25.5	2	14.00	6.5	4.2	3026W05	3026W06
30	25.5	2	19.00	4.75	4.2	3026W15	3026W16
30	30.5	2	14.00	6.5	4.2	3031W05	3031W06
30	30.5	2	19.00	4.75	4.2	3031W05	3031W06
30	35.0	2	14.00	6.5	4.2	3036W05	3036W06
30	30.5	2	19.00	6.5	4.1	3030W05	3030W06
35	25.5	2	14.00	6.5	4.2	3526W05	3526W06
35	30.5	2	14.00	6.5	4.2	3531W05	3531W06
35	35.5	2	14.00	6.5	4.2	3536W05	3536W06
40	20.5	2	26.00	6.5	4.2	4021W15	4021W16
40	25.5	2	26.00	6.5	4.2	4026W05	4026W06
40	30.5	2	26.00	6.5	4.2	4031W05	4031W06
40	35.5	2	26.00	6.5	4.2	4036W05	4036W06
40	40.5	2	26.00	6.5	4.2	4041W05	4041W06
50	30.0	2	26.00	6.5	4.1	5030W25	5030W26
50	20.5	2	26.00	6.5	4.2	5021W05	5021W06
50	25.5	2	26.00	6.5	4.2	5026W05	5026W06
50	30.5	2	26.00	6.5	4.2	5031W05	5031W06
50	32.3	2	24.00	6	4.2	5033W05	5033W06
50	35.5	2	26.00	6.5	4.2	5036W05	5036W06
50	40.5	2	26.00	6.5	4.2	5041W05	5041W06
60	35.5	2	26.00	6.5	4.2	6036W05	6036W06
60	40.5	2	26.00	6.5	4.2	6041W05	6041W06
60	45.5	2	26.00	6.5	4.2	6046W05	6046W06
80	25.5	2	60.00	6.5	4.2	8026W05	8026W06
80	35.5	2	60.00	6.5	4.2	8036W05	8036W06
80	40.5	2	60.00	6.5	4.2	8041W05	8041W06

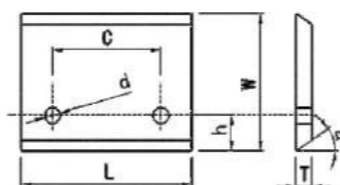

STYLE TSL ST 22-...						Code	
L	W	T	C	h	d	EUK10UF	EUK01
40	20	2	26.00	5.5	4.2	4020W05	4020W06
45	35	2	26.00	5.5	4.2	4535W15	4535W16
50	25	2	26.00	5.5	4.2	5025W15	5025W16
51	26	2	26.00	5.5	4.2	5126W15	5126W16

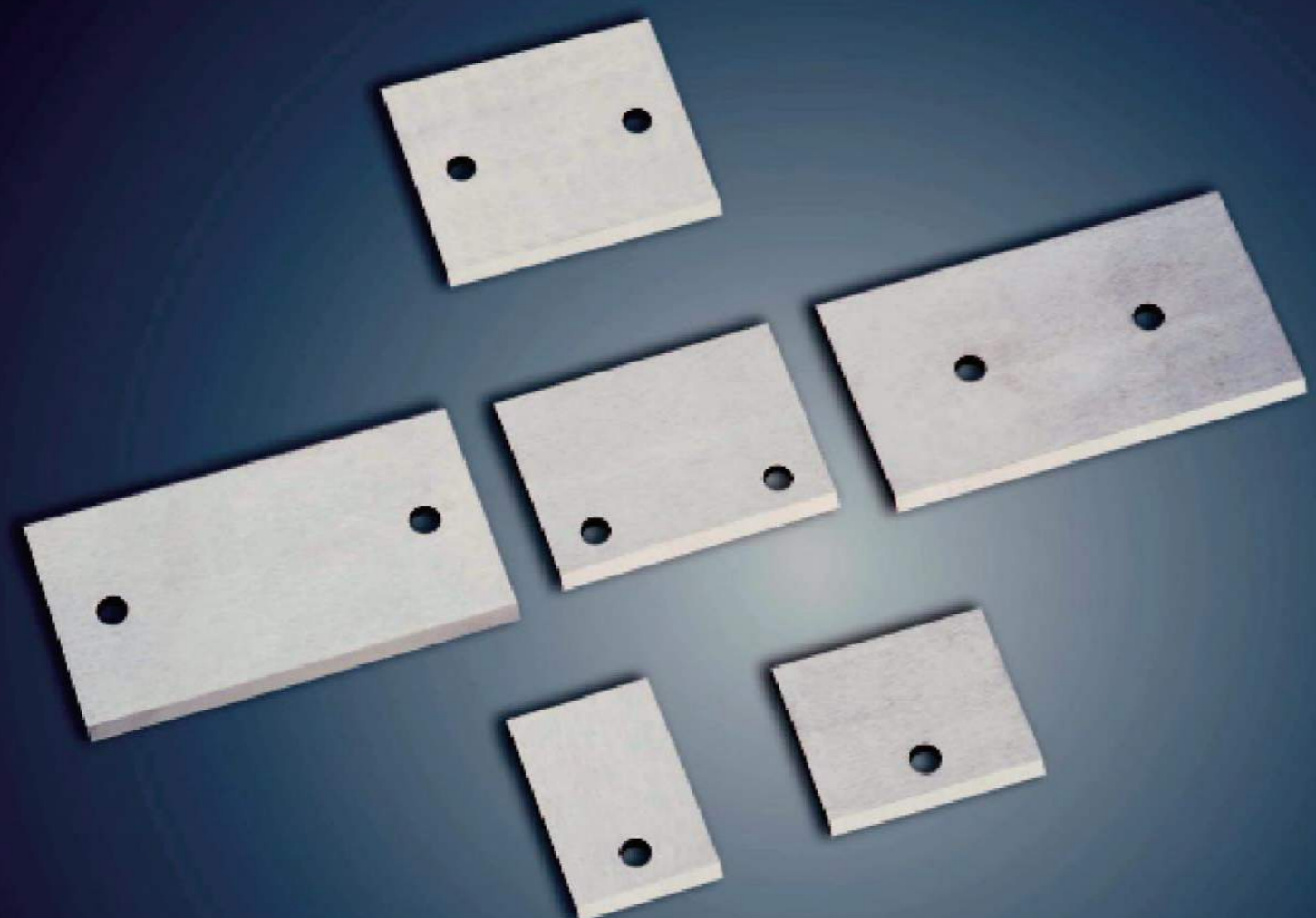

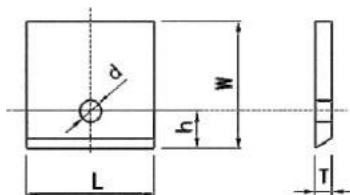

STYLE TSL ST 10---					Code	
L	W	T	h	d	EUK10UF	EUK01
15	15.5	2	6.30	4.2	1516V05	1516V06
15	20.5	2	6.30	4.2	1521V05	1521V06
15	20.4	2	6.30	4.2	1521V15	1521V16
15	25.5	2	6.30	4.2	1526V05	1526V06
15	30.5	2	6.30	4.2	1531V05	1531V06
20	20.5	2	6.30	4.2	2021V15	2021V16
20	25.5	2	6.30	4.2	2026V35	2026V36
20	30.5	2	6.30	4.2	2031V25	2031V26
20	30.4	2	6.30	4.2	2031V35	2031V36
20	35.5	2	6.30	4.2	2036V15	2036V16
25	20.5	2	6.30	4.2	2521V25	2521V26
25	25.5	2	6.30	4.2	2526V15	2526V16
25	30.5	2	6.30	4.2	2531V15	2531V16
25	35.5	2	6.30	4.2	2536V15	2536V16
30	20.5	2	6.30	4.2	3021V15	3021V16
30	25.5	2	6.30	4.2	3026V15	3026V16
30	25.4	2	6.30	4.2	3026V25	3026V26
30	30.5	2	6.30	4.2	3031V15	3031V16
30	35.5	2	6.30	4.2	3036V15	3036V16
30	40.5	2	6.30	4.2	3041V05	3041V06
35	20.5	2	6.30	4.2	3521V05	3521V06
35	25.5	2	6.30	4.2	3526V15	3526V16
35	30.5	2	6.30	4.2	3531V15	3531V16
35	35.5	2	6.30	4.2	3536V15	3536V16
35	40.5	2	6.30	4.2	3541V05	3541V06
40	20.5	2	6.30	4.2	4021V05	4021V06
40	25.5	2	6.30	4.2	4026V05	4026V06
40	30.5	2	6.30	4.2	4031V15	4031V16
40	35.5	2	6.30	4.2	4036V05	4036V06
40	40.5	2	6.30	4.2	4041V05	4041V06

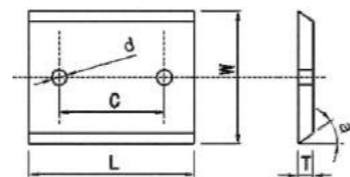

STYLE TSL ST 22---					Code	
L	W	T	C	d	EUK10UF	EUK01
30	25	2	20.00	4.2	3025W05	3025W06
40	30	2	20.00	4.2	4030W05	4030W06
40	30	2	26.00	4.2	4030W15	4030W16
40	32.6	2	20.00	4.2	4033W05	4033W06
40	35	2	26.00	4.2	4035W05	4035W06
40	35	2	26.00	4	4035W15	4035W16
40	35	2	26.00	4.2	4035W25	4035W26
40	37.8	2	20.00	4.2	4038W05	4038W06
40	42.9	2	20.00	4.2	4043W05	4043W06
42	32	2	26.00	4.2	4232W05	4232W06
45	35	2	26.00	4.2	4535W05	4535W06
50	16	2	26.00	4.2	5016W05	5016W06
50	20	2	26.00	4.2	5020W05	5020W06
50	25	2	26.00	4.2	5025W05	5025W06
50	30	2	26.00	4.2	5030W05	5030W06
50	30	2	34.00	4.2	5030W15	5030W16
50	40	2	34.00	4.2	5040W05	5040W06
50	45	2	34.00	4.2	5045W05	5045W06
51	26	2	26.00	4.2	5126W05	5126W06
52	34	2	24.00	4.2	5234W05	5234W06
60	20	2	26.00	4.2	6020W05	6020W06
60	19	2	44.00	4.2	6019W05	6019W06
60	25	2	26.00	4.2	6025W05	6025W06
60	25	2	44.00	4.2	6025W15	6025W16
60	30	2	26.00	4.2	6030W05	6030W06
60	30	2	44.00	4.2	6030W15	6030W16
60	32.6	2	20.00	4.2	6033W05	6033W06
60	35	2	26.00	4.2	6035W05	6035W06
60	35	2	44.00	4.2	6035W15	6035W16
60	37.8	2	20.00	4.2	6038W05	6038W06
60	40	2	44.00	4.2	6040W05	6040W06
60	42.9	2	20.00	4.2	6043W05	6043W06

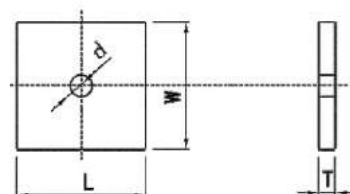

STYLE TSL ST 10---				Code	
L	W	T	d	EUK10UF	EUK01
24	22	2	4.2	2422V05	2422V06
28	24	2	4.2	2824V05	2824V06
32	24	2	4.2	3224V05	3224V06
36	28	2	4.1	3628V05	3628V06
40	26	2	4.2	4026V15	4026V16

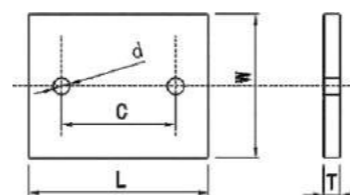

STYLE TSL ST 20---					Code	
L	W	T	C	d	EUK10UF	EUK01
40	20.4	2	26.00	4.2	4021W05	4021W06
42	32	2	24.00	4.2	4232W05	4232W16
48	36	2	24.00	4.2	4836W15	4836W06
52	34	2	24.00	4.1	5234W05	4234W16

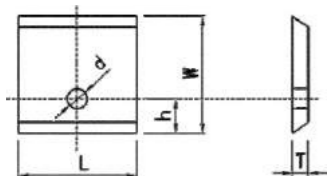

STYLE TSL ST 12----					Code	
L	W	T	h	d	EUK10UF	EUK01
15	20	2	6.30	4.2	1520V05	1520V06
15	30	2	6.30	4.2	1530V05	1530V06
20	20	2	6.30	4.2	2020V05	2020V06
20	25	2	6.30	4.2	2025V05	2025V06
20	30	2	6.30	4.2	2030V05	2030V06
20	35	2	6.30	4.2	2035V05	2035V06
25	20	2	6.30	4.2	2520V05	2520V06
25	25	2	6.30	4.2	2525V05	2525V06
25	30	2	6.30	4.2	2530V05	2530V06
25	35	2	6.30	4.2	2535V05	2535V06
30	25	2	6.30	4.2	3025V05	3025V06
30	35	2	6.30	4.2	3035V05	3035V06
30	40	2	6.30	4.2	3040V05	3040V06
35	30	2	6.30	4.2	3530V05	3530V06
35	35	2	6.30	4.2	3535V05	3535V06

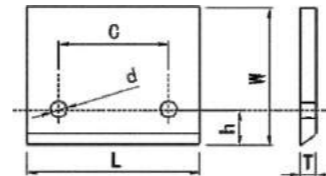

STYLE TSL ST 22----					Code	
L	W	T	C	d	EUK10UF	EUK01
30	20.5	2	14.00	4.2	3021W15	3021W16
30	25.5	2	14.00	4.2	3026W25	3026W26
30	30.5	2	14.00	4.2	3031W25	3031W26
30	35.5	2	14.00	4.2	3036W15	3036W16
35	25.5	2	14.00	4.2	3526W15	3526W16
35	30.5	2	14.00	4.2	3531W15	3531W16
35	35.5	2	14.00	4.2	3536W15	3536W16
40	30.0	2	20.00	4.1	4030W25	4030W26
40	35.0	2	20.00	4.1	4035W55	4035W56
40	35.0	2	26.00	4.1	4035W65	4035W66
40	20.5	2	26.00	4.2	4021W25	4021W26
40	20.5	2	26.00	4.2	4021W35	4021W36
40	20.5	2	26.00	4.2	4021W45	4021W46
50	20.5	2	26.00	4.2	5021W15	5021W16
50	25.5	2	26.00	4.2	5026W15	5026W16
50	25.5	2	26.00	4.2	5026W25	5026W26
51	26.5	2	26.00	4.2	5127W05	5127W06
50	35.5	2	26.00	4.2	5036W15	5036W16
50	40.5	2	26.00	4.2	5041W15	5041W16
52	27.5	2	26.00	4.2	5228W05	5228W06
60	40.0	2	20.00	4.2	6040W65	6040W66
60	35.0	2	44.00	4.2	6035W05	6035W06
60	40.0	2	44.00	4.2	6040W75	6040W76
60	40.5	2	26.00	4.2	6041W15	6041W16
60	40.5	2	44.00	4.2	6041W25	6041W26
70	30.5	2	26.00	4.2	7031W05	7031W06
70	35.5	2	26.00	4.2	7036W05	7036W06
70	35.5	2	44.00	4.2	7036W15	7036W16
80	25.5	2	60.00	4.2	8026W15	8026W16
80	30.5	2	60.00	4.2	8031W05	8031W06
80	35.5	2	60.00	4.2	8036W15	8036W16
80	40.5	2	60.00	4.2	8041W15	8041W16

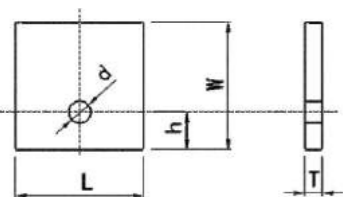

STYLE TSL ST 10----					Code	
L	W	T	h	d	EUK10UF	EUK01
10	20.3	2	6.00	4.2	1021V05	1021V06
12	20.3	2	6.00	4.2	1221V05	1221V06
15.1	20.3	2	6.00	4.2	1621V05	1621V06
16.2	20.3	2	6.00	4.2	1721V05	1721V06
16.2	25.3	2	6.00	4.2	1726V05	1726V06
18	18.3	2	6.00	4.2	1819V05	1819V06
18.2	18.3	2	6.00	4.2	1919V05	1919V06
18.2	25.3	2	6.00	4.2	1926V05	1926V06
20	20.5	2	6.50	4.2	2021V05	2021V06
20	25.5	2	6.50	4.2	2026V05	2026V06
20	25.5	2	6.50	4.2	2026V15	2026V16
20.2	30.3	2	6.00	4.2	2131V05	2131V06
22.2	25.3	2	6.00	4.2	2326V05	2326V06
24	28.3	2	6.00	4.2	2429V05	2429V06
24.2	20.3	2	6.00	4.2	2521V05	2521V06
25	20.5	2	6.50	4.2	2521V15	2521V16
30	20.5	2	6.50	4.2	3021V05	3021V06
32	22.3	2	6.00	4.2	3223V05	3223V06
35	25.5	2	6.50	4.2	3526V05	3526V06
40	30.3	2	6.00	4.2	4031V05	4031V06

## ROUND CUTTERS

Type	Dimension			Carbide Grade		
	ΦD	Φd	S	EY6X	EY10	EY10X
Φ20×Φ5×0.2	20.0	5.0	0.2	▲	▲	▲▲
Φ28×Φ10×0.3	28.0	10.0	0.3	▲	▲	▲▲
Φ45×Φ8×0.3	45.0	8.0	0.3	▲	▲	▲▲
Φ50×Φ10×0.6	50.0	10.0	0.6	▲	▲	▲▲
Φ60×Φ19×0.27	60.0	19.0	0.27	▲	▲	▲▲
Φ100×Φ25×0.25	100.0	25.0	0.25	▲	▲	▲▲
Φ105×Φ60×0.6	105	60	0.6	▲	▲	▲▲
Φ138×Φ60×1.2	138	60	1.2	▲	▲	▲▲
Φ180×Φ25.4×0.75	180	25.4	0.75	▲	▲	▲▲
Φ200×Φ122×1.4	200	122	1.4	▲	▲	▲▲
Φ210×Φ122×1.4	210	122	1.4	▲	▲	▲▲
Φ230-210×Φ110(130)×1.4	230 (210)	110(130)	1.4	▲	▲	▲▲
Φ240×Φ32×1.25-2×Φ7.5	240	32	1.25	▲	▲	▲▲
Φ250×Φ105(150)×1.5-6×Φ11(3×Φ11)	250	105(150)	1.5	▲	▲	▲▲
Φ260×Φ140×1.5	260	140	1.5	▲	▲	▲▲
Φ260 x Φ158 (160) x 1.5-8 x Φ11	260	158(160)	1.5	▲	▲	▲▲
Φ260(265)×Φ114(112)×1.5-8×Φ11	260(265)	114(112)	1.5	▲	▲	▲▲
Φ270(260) x Φ168.3 x 1.5-8 x Φ11	270 (260)	168.3	1.5	▲	▲	▲▲
Φ270 x Φ170 x 1.5-8 x Φ11	270	170	1.5	▲	▲	▲▲
Φ280×Φ168×1.5-8×Φ11	280	168	1.5	▲	▲	▲▲
Φ290×Φ112×1.5-6×Φ11	290	112	1.5	▲	▲	▲▲
Φ50				▲	▲	▲▲

## SAW CUTTERS

Type	Dimension			Carbide Grade		
	ΦD	T	Φd	EY6X	EY10	EY10X
Φ35×1/1.5/1.75-Φ18	35	1/1.5/1.75	18	▲	▲	▲
Φ70×1.0-Φ22	70	1	22	▲	▲	▲
Φ70×5.0-Φ22	75	5	22	▲	▲	▲
Φ85×0.7-Φ35	85	0.7	35	▲	▲	▲
Φ99.797×0.5-Φ15	99.797	0.5	15	▲	▲	▲
Φ100×1.0-Φ22	100	1	22	▲	▲	▲
Φ100×0.45/0.55-Φ25.4	100	0.45/0.55	25.4	▲	▲	▲
Φ125×0.5-Φ40	125	0.5	40	▲	▲	▲
Φ150×1.2-Φ50	150	1.2	50	▲	▲	▲

### FINE & FIBER BIADES

Type	Dimension			Carbide Grade		
	L	W	T	EY6X	EUK40H	
43×22×0.4	43	22	0.4	▲	▲	
57×19×0.4	57	19	0.4	▲	▲	
57.05×19.05×0.4	57.05	19.05	0.4	▲	▲	
90×17×0.4	90	17	0.4	▲	▲	
91.5×20×1.8-450	91.5	20	1.8	▲	▲	
135×19×1.4	135	19	1.4	▲	▲	
140×18.5×1.5	140	18.5	1.5	▲	▲	
150×19×1.6	150	19	1.6	▲	▲	
152×17.3×0.15	152	17.3	0.15	▲	▲	
152×17.3×0.25	152	17.3	0.25	▲	▲	
169×17.3×0.15	169	17.3	0.15	▲	▲	
169×17.3×0.25	169	17.3	0.25	▲	▲	
169×17.3×2.5	169	17.3	2.5	▲	▲	
160×22.4×0.1	160	22.4	0.1	▲	▲	
160×22.4×0.2	160	22.4	0.2	▲	▲	
250×25×1.5	250	25	1.5	▲	▲	
360×23.6×0.6	360	23.6	0.6	▲	▲	
400×23.6×0.6	400	23.6	0.6	▲	▲	

### SPECIAL TOOLS

Type	Dimension			Carbide Grade		
	L	W	T	EY8	EY15	
32.3×14×3.8	32.3	14	3.8	▲	▲	
39×14×3.5	39	14	3.5	▲	▲	
42.4×18.8×4.59	42.4	18.8	4.59	▲	▲	
44.45×18.65×4.76	44.45	18.65	4.76	▲	▲	
63×14×4	63	14	4	▲	▲	
60×20×20	63	20	20	▲	▲	
64×18×18	64	18	18	▲	▲	
71×14×3.5	71	14	3.5	▲	▲	

### ENGRAVING KNIVES



Type	Dimension			Carbide Grade		
	L	W	T	EY6X	EUK40H	
22×6×0.8	22	6		▲	▲	0.8
22×6×1	22	6		▲	▲	1
24×3.97×0.3	24	3.97		▲	▲	0.4
25×6×0.8	25	6		▲	▲	0.8
28.9×7×1	28.9	7		▲	▲	1
28×4×0.6	28	4		▲	▲	0.6
28×5.6×0.6-1	28	5.6		▲	▲	0.6
28×5.6×0.6-2	28	5.6		▲	▲	0.6
29.64×7×1	29.64	7		▲	▲	1
30.6×6×0.6	30.6	6		▲	▲	0.6
34.5×7×1	34.5	7		▲	▲	1
36.5×6×0.5-Φ2.3	36.5	6		▲	▲	0.5
40×7×0.6	40	7		▲	▲	0.6

Type	Dimension			Carbide Grade		
	ΦD	L	a°	EY6X	EUK40H	
Φ4×25.9×18°	22	25.9	18°	▲	▲	

