

2023/05-1



EURLOY

SPIRAL BORU ÜRETİMİNDE VERİ ÇÖZÜMLERİ

*EFFICIENT SOLUTIONS FOR
SPIRAL PIPE PRODUCTION*



SPIRAL BORU UÇLARI

SPIRAL PIPE INSERTS

Kenar Frezeleme Uçları
Sheet Edge Proportion, Milling Insert

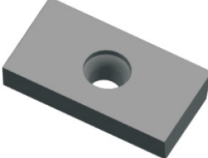
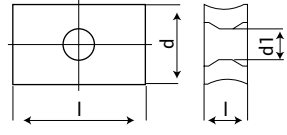
LOCX	Sipariş Kodu Order Code	l	d	t	d1	r	
	LOCX3010Z	30	18,3	10	6,8	-	

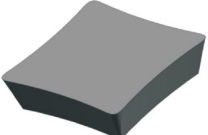
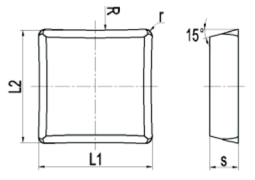
SDMN	Sipariş Kodu Order Code	L1	L2	S	R	r	
	SDMN2507-R0	25.4	-	6.35	-	1.6	
	SDMN2507-R105	25.4	23.87	6.35	105	1.6	
	SDMN2507-R120	25.4	24.0	6.35	120	1.6	
	SDMN2507-R180	25.4	24.34	6.35	180	1.6	
	SDMN2507-R300	25.4	24.98	6.35	300	1.6	
	SDMN2507-R340	25.4	25.04	6.35	340	1.6	
	SDMN2507-400	25.4	25.1	6.35	400	1.6	
	SDMN2507-R550	25.4	25.18	6.35	550	1.6	

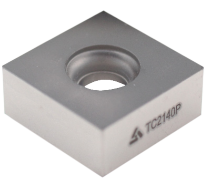
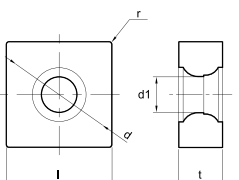
SNHQ	Sipariş Kodu Order Code	l	d	t	d1	r	
	SNHQ150704S	15,875	15,875	7,94	5,8	0,4	
	SNHQ 190704S	19,05	19,05	7,94	6,4	0,4	
	SNHQ 200700S	20,00	20,00	7,00	6,4	0,0	

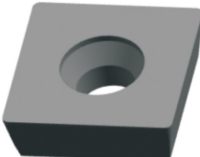
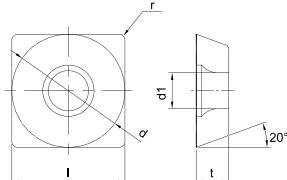

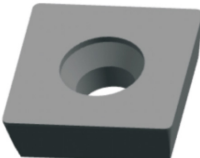
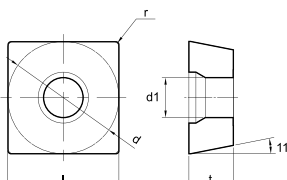
SEEW	Sipariş Kodu Order Code	l	d	t	d1	r	
	SEEW22	22	22	6,35	5,8	0,3	

SPEW	Sipariş Kodu Order Code	l	d	t	d1	r	
	SPEW190606-BY	19	19	6,35	6,6	0,6	

SPIRAL BORU UÇLARI

SPIRAL PIPE INSERTS

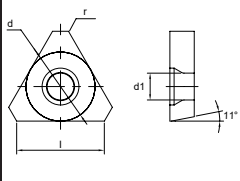
 Kenar Frezeleme Uçları
Sheet Edge Proportion, Milling Insert

TPEX	Sipariş Kodu Order Code	l	l ₁	d	s	d ₁	r	α	
	TPEX 3307	33,00	23,35	19,05	7,00	6,6	—	11°	

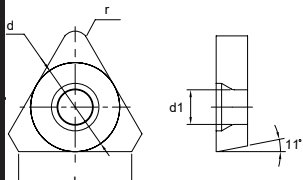
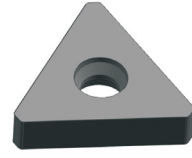
TP□W	Sipariş Kodu Order Code	l	d	t	d ₁	r	
	TPEW33MM15S	26,7	18,953	7	6,7	1,6	
	TPEW33M726S	24	19,05	7	6,7	2,6	

SPIRAL BORU UÇLARI

SPIRAL PIPE INSERTS



Kod: 850x190x94.2x460KgXR/LxWS-4
Designation:

Ana Nokta: Kesme Şekli: 1 Tipi (Düz)
Main Point: Cutting Form: 1 Type (Straight)
Uç Dizayını / Insert Designation: LNMN5000604
SNEN250604
Kartuş + Çivi Tipi / Locator + Wedge Type

Kesme Çapı / Cutter DIA: 850
Toplam Uç Sayısı / Total Number of Insert: 64pcs
Ağırlık / Weight: 460 Kg

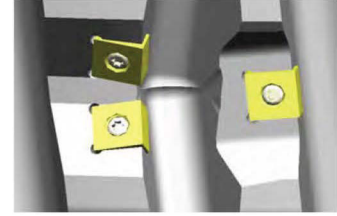

Kod: ECX600R/L-NS.AG3030.RF8.3H
Designation:

Ana Nokta: Kesme Şekli: X Tipi
Main Point: Cutting Form: X Type
Uç Dizayını / Insert Designation: SNHQ150704S
Türdeki Vidalama / Screw on Type

Kesme Çapı / Cutter DIA: 600
Toplam Uç Sayısı / Total Number of Insert: 54pcs
Ağırlık / Weight: 137 Kg

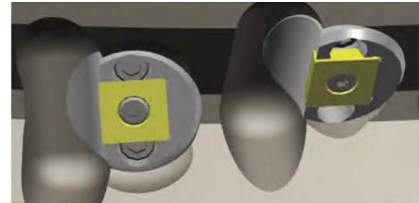

Kod: ECX443.6R/L-3232-BY
Designation:

Ana Nokta: Kesme Şekli: X Tipi
Main Point: Cutting Form: X Type
Uç Dizayını / Insert Designation: SPEW190606-BY
Kartuş Tipi / Locator Type

Kesme Çapı / Cutter DIA: 443.6
Toplam Uç Sayısı / Total Number of Insert: 24pcs
Ağırlık / Weight: 80 Kg

SPIRAL BORU UÇLARI

SPIRAL PIPE INSERTS



Kod: ENF1000R/L-SAID01
Designation:

Ana Nokta: Kesme Şekli: 1 Tipi (Düz)
Main Point: Cutting Form: 1 Type (Straight)
Uç Dizayını / Insert Designation: LOCX3010Z
Kesici Türü / Locator Type

Kesme Çapı / Cutter DIA: 1000
Toplam Uç Sayısı / Total Number of Insert: 64pcs
Ağırlık / Weight: 530 Kg

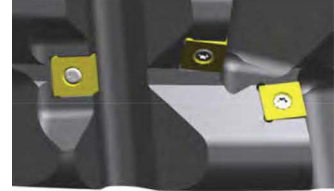

Kod: ECX420R/L-3535-NS
Designation:

Ana Nokta: Kesme Şekli: X Tipi
Main Point: Cutting Form: X Type
Uç Dizayını / Insert Designation: SSNHQ150704S
Türdeki Vidalama / Screw on Type

Kesme Çapı / Cutter DIA: 420
Toplam Uç Sayısı / Total Number of Insert: 30pcs
Ağırlık / Weight: 65 Kg

SPIRAL BORU UÇLARI

SPIRAL PIPE INSERTS

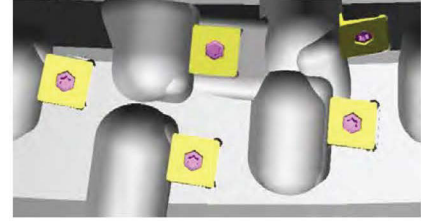
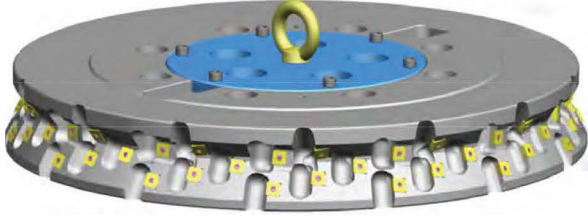

Kod: ECX640R/L-SK.AG3529.RF3
Designation:

Ana Nokta: Kesme Şekli: X Tipi
Main Point: Cutting Form: X Type
Uç Kodu / Insert Designation: SPEW150608S
Türdeki Vidalama / Screw on Type

Kesme Çapı / Cutter DIA: 640
Toplam Uç Sayısı / Total Number of Insert: 70pcs
Ağırlık / Weight: 207 Kg



Kod: ECF600R/L-T70
Designation:

Ana Nokta: Kesme Şekli: 1 Tipi
Main Point: Cutting Form: 1 Type
Uç Kodu / Insert Designation: LOCX3010-DT1
Kartuş Tipi / Locator Type

Kesme Çapı / Cutter DIA: 600
Toplam Uç Sayısı / Total Number of Insert: 56pcs
Ağırlık / Weight: 250 Kg

SPIRAL BORU UÇLARI

SPIRAL PIPE INSERTS



Kod: ECX600R/L-AG3825.RF4
Designation:

Ana Nokta: Kesme Şekli: X Tipi
Main Point: Cutting Form: X Type
Uç Kodu / Insert Designation: LOCX3010-DT1
Kartuş Tipi / Locator Type

Kesme Çapı / Cutter DIA: 600
Toplam Uç Sayısı / Total Number of Insert: 60pcs
Ağırlık / Weight: 300 Kg

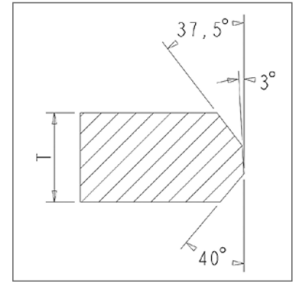
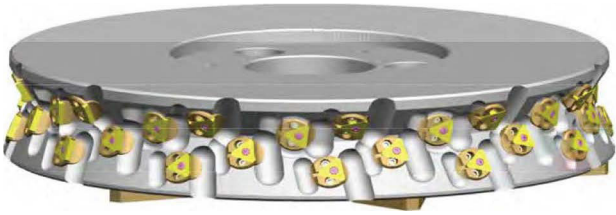

Kod: ECX600R/L-HRB.AG30225.RF4
Designation:

Ana Nokta: Kesme Şekli: X Tipi
Main Point: Cutting Form: X Type
Uç Kodu / Insert Designation: TPGW3306Z-1
Kartuş Tipi / Locator Type

Kesme Çapı / Cutter DIA: 600
Toplam Uç Sayısı / Total Number of Insert: 48pcs
Ağırlık / Weight: 220 Kg

SPIRAL BORU UÇLARI

SPIRAL PIPE INSERTS

 Kaset Tip Kenar Frezeleme Kafası
Edge Milling Cutter with Cassette

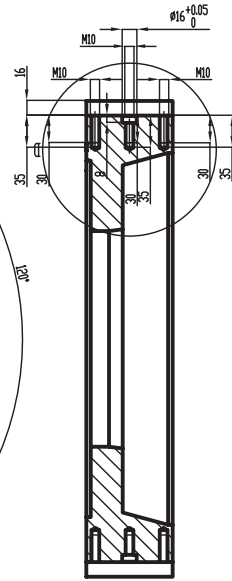
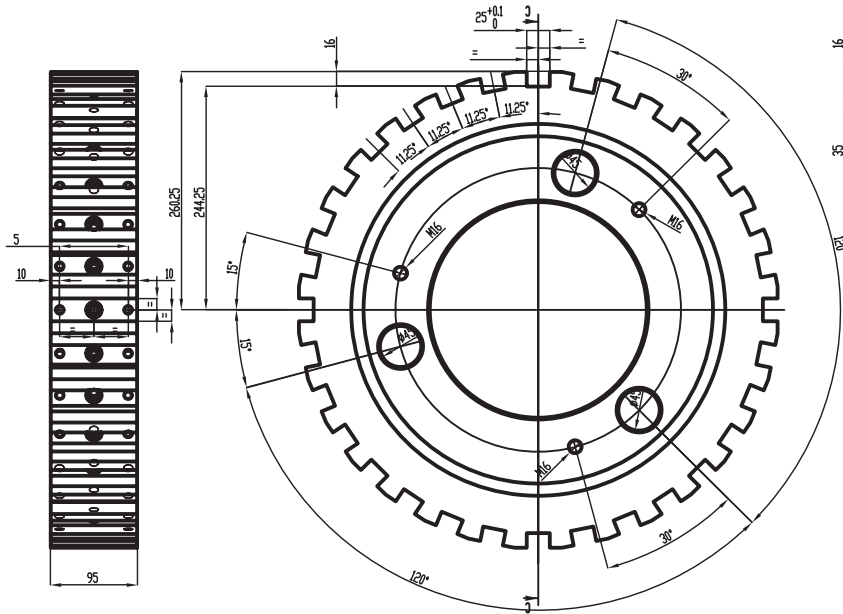
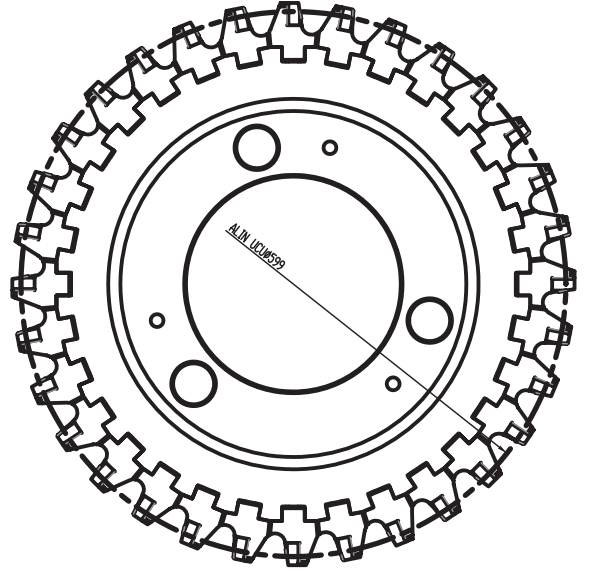
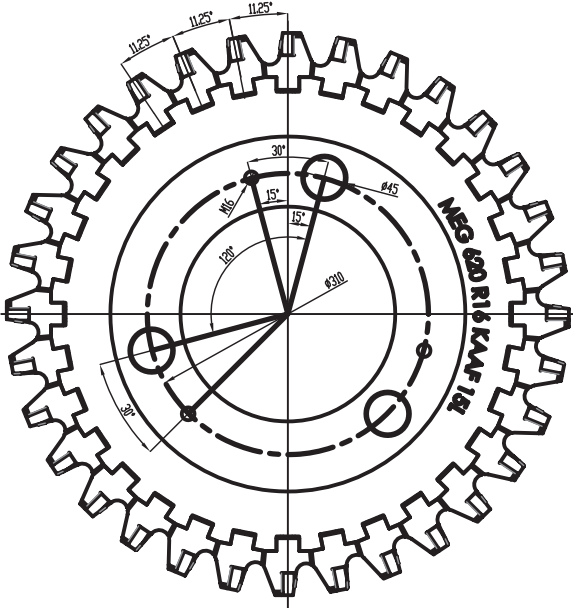

KESİT C-C

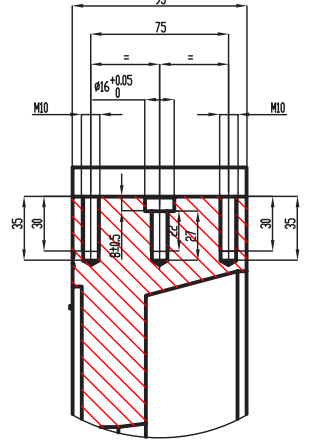

DETAY D
BÖLÜK 1 : 2

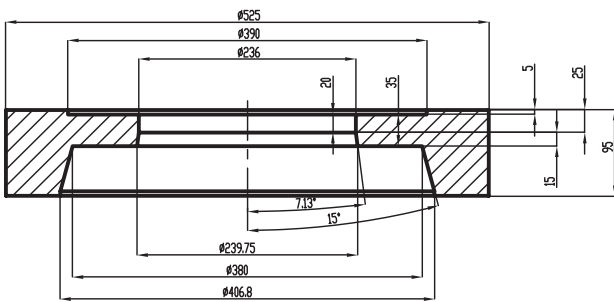

Gövde: MEG 620 R16 KAAF 15L

SPIRAL BORU UÇLARI

SPIRAL PIPE INSERTS

 Boru Kaynak Ağzı Açma Uçları
Tube and Pipe End Beveling

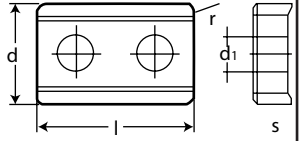
LNUX	Sipariş Kodu Order Code	l	d	s	d1	r	
	LNUX 400924-BB0	40	25,4	9,52	9,2	2,4	

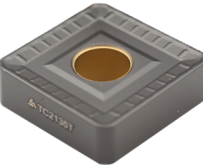
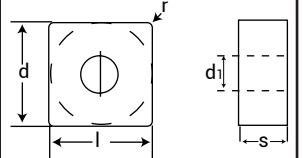
SNMM	Sipariş Kodu Order Code	l	d	s	d1	r	
	SNMM 250724-BBM	25,4	25,4	7,94	9,12	2,4	

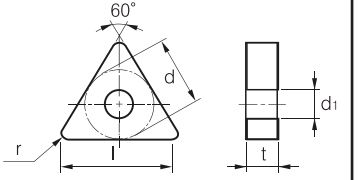
TNMG	Sipariş Kodu Order Code	l	l1	s	d1	r	
	TNMG 330724-ST	33	19,05	9,525	7,94	2,4	
	TNMG 330704-ST	33	19,05	9,525	7,94	0,4	

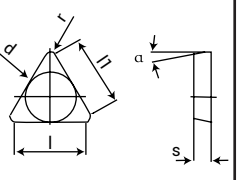
TPUN	Sipariş Kodu Order Code	l	l1	d	s	d1	r	a	
	TPUN 330620-T	33	26,07	19,5	6,35	-	2	11	

SPIRAL BORU UÇLARI

SPIRAL PIPE INSERTS



Et Kalınlığı ve Pah Açısına Göre Uygun Takımın Seçilmesi
Choice of the appropriate tool in relation to wall
thickness and chamfer angle

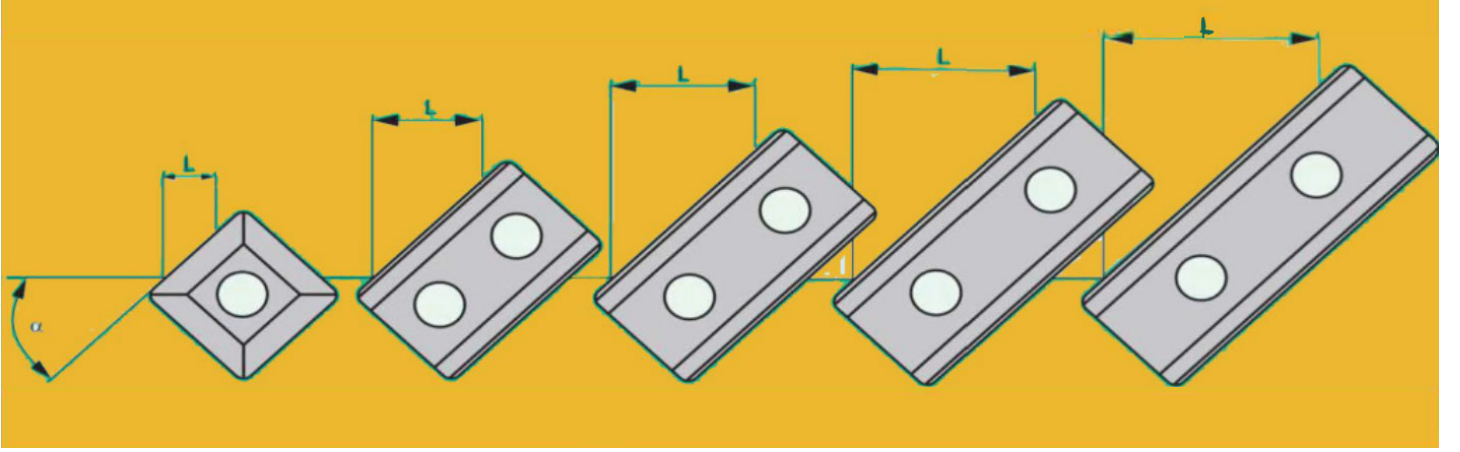

Kartuş / Cartridge	K-2 R/L	K-4 R/L	K-5 R/L	K-6 R/L	K-7 R/L
Takma Ucu / Indexable Insert	SNMM 25	LNUX 40	LNUX 50	LNUX 60	LNUX 70
Pah / Chamfer	L= max. L= Max. Et Kalınlığı / Max Wall Thickness				
$\alpha= 0^\circ$	16,0	32,0	40,0	50,0	60,0
$\alpha= 2^\circ$	16,0	32,0	40,0	50,0	60,0
$\alpha= 3^\circ$	16,0	32,0	40,0	50,0	60,0
$\alpha= 4^\circ$	16,0	32,0	40,0	49,5	60,0
$\alpha= 5^\circ$	15,5	32,0	40,0	49,5	59,5
$\alpha= 6^\circ$	15,5	32,0	40,0	49,5	59,5
$\alpha= 7^\circ$	15,5	32,0	39,5	49,5	59,5
$\alpha= 10^\circ$	15,5	31,5	39,5	49,0	59,5
$\alpha= 12,5^\circ$	15,5	31,0	39,0	48,5	58,5
$\alpha= 15^\circ$	15,5	31,0	38,5	48,0	58,0
$\alpha= 17,5^\circ$	15,0	30,5	38,0	47,5	57,0
$\alpha= 20^\circ$	15,0	30,0	37,5	46,5	56,0
$\alpha= 22^\circ$	15,0	29,5	37,0	46,0	55,0
$\alpha= 25^\circ$	14,5	29,0	36,0	45,0	54,0
$\alpha= 27^\circ$	14,0	28,5	35,5	44,0	53,0
$\alpha= 30^\circ$	14,0	27,5	34,5	43,0	51,0
$\alpha= 32^\circ$	13,5	27,0	34,0	42,0	50,0
$\alpha= 35^\circ$	13,0	26,0	32,5	40,5	48,0
$\alpha= 37^\circ$	12,5	25,5	32,0	39,5	47,0
$\alpha= 40^\circ$	12,0	24,5	30,5	37,5	45,0

SPIRAL BORU UÇLARI

SPIRAL PIPE INSERTS

 Kaynak Ağzı Açma Takımları
Beveling Tools

Kater: CS30NR 38.1 X 38.1 X 25
Uç: SNMM 2507

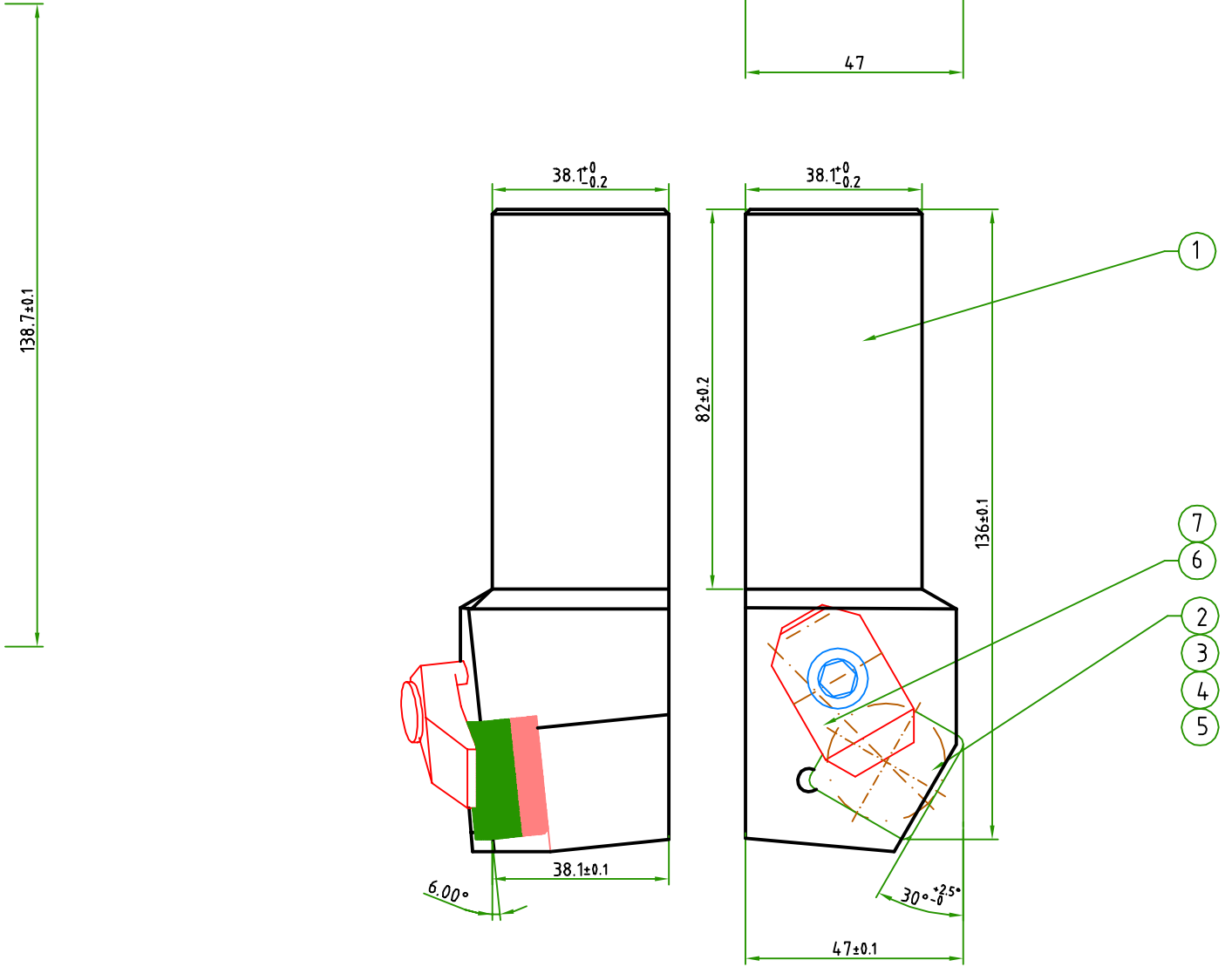

SPIRAL BORU UÇLARI

SPIRAL PIPE INSERTS

 Kaynak Ağız Açma Takımları
Beveling Tools

Kater: CT30NL 40 40 X 33
Uç: TNMG 330704

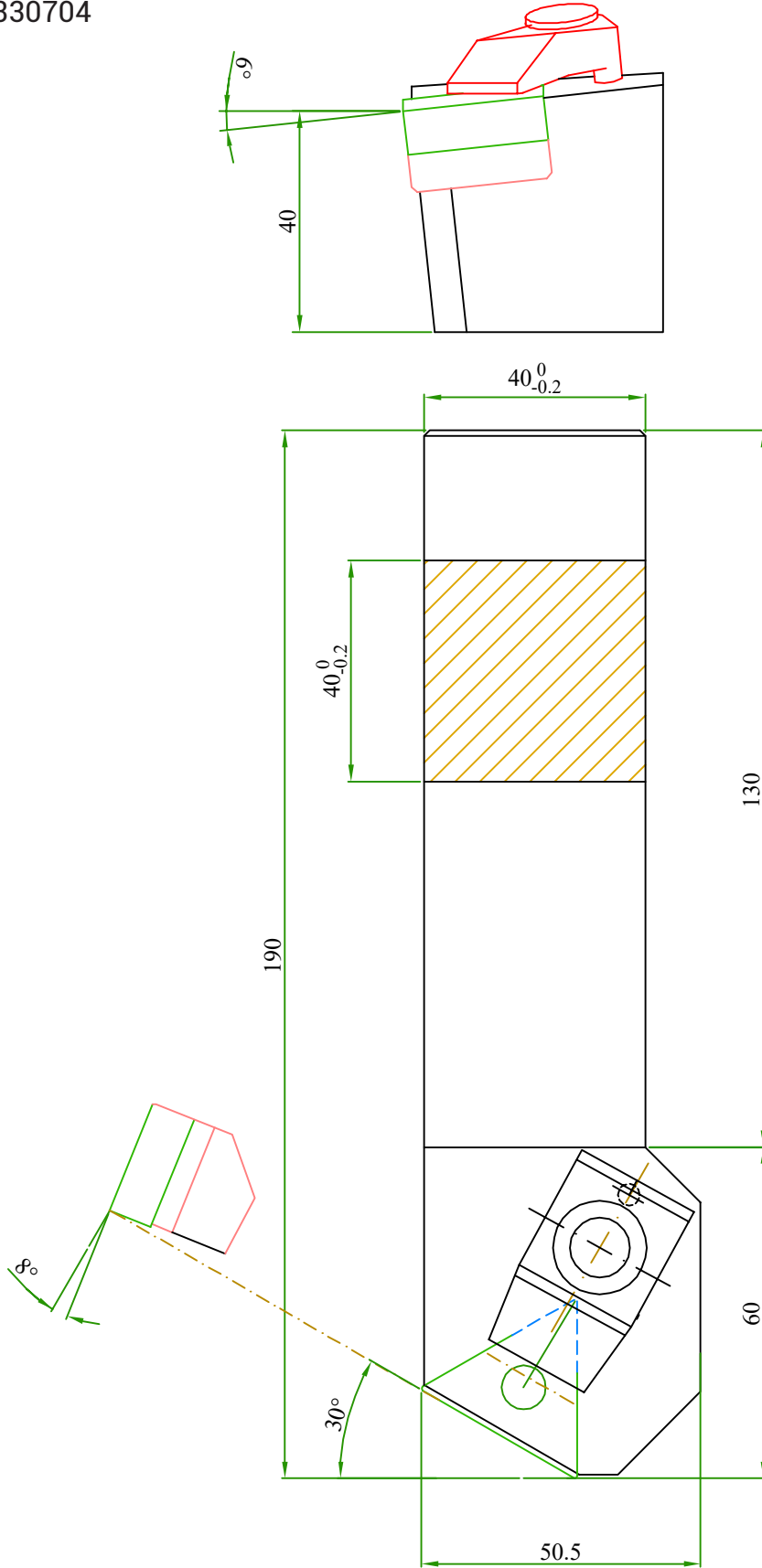

SPIRAL BORU UÇLARI

SPIRAL PIPE INSERTS

 Kaynak Ağız Açma Takımları
Beveling Tools

Kater: CT30NR 38.1 38.1 X 33 T04
Uç: TNMG 330704

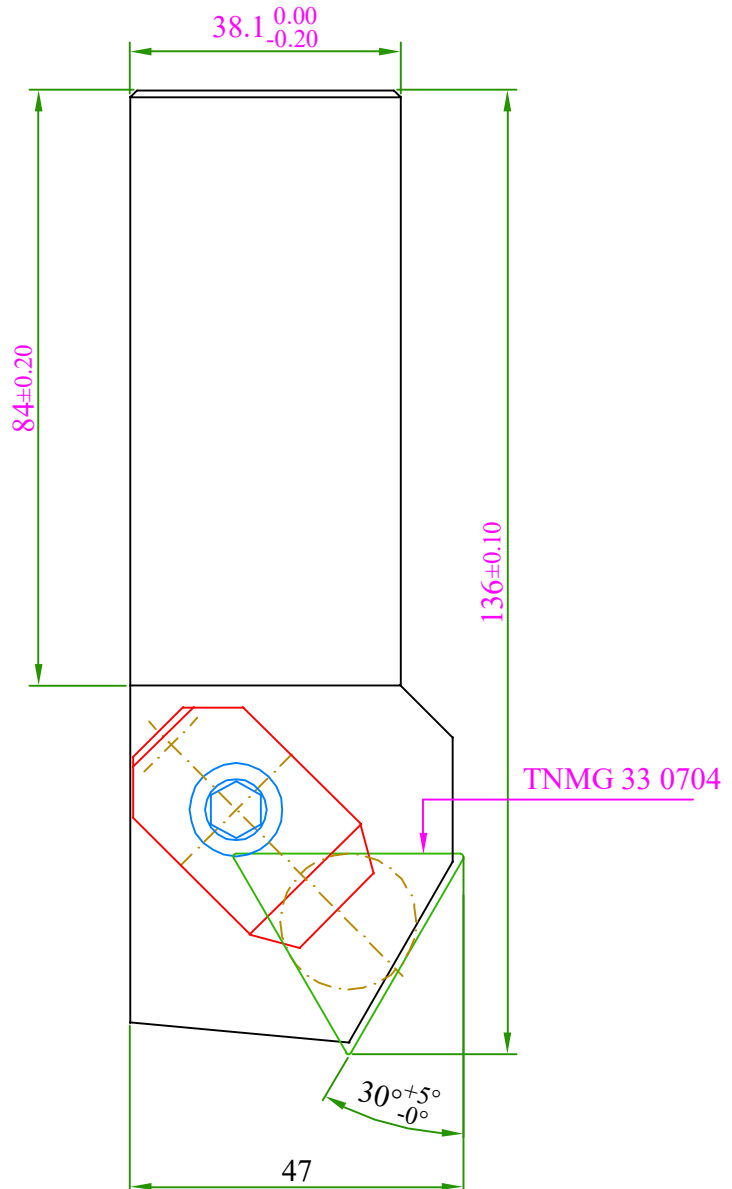
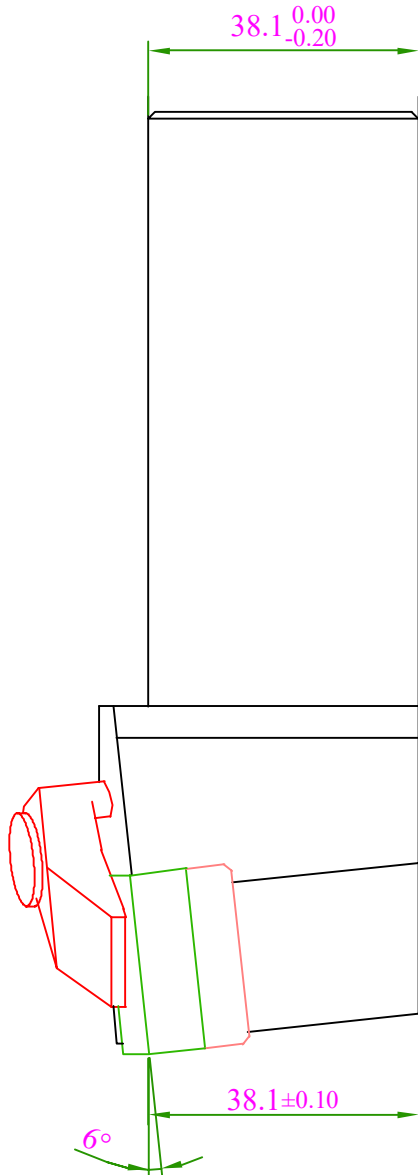
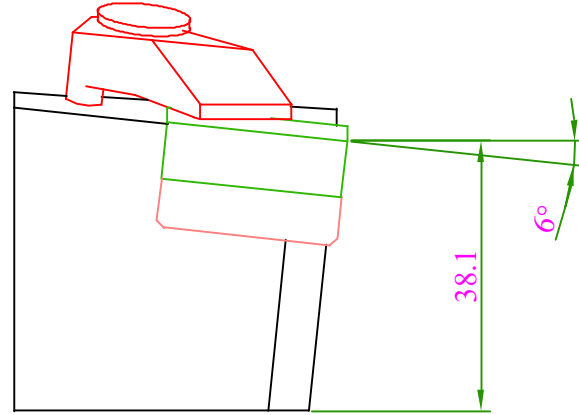

TORX UÇ SIKMA VİDASI

INSERT SCREW

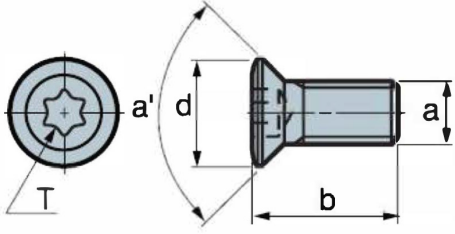

FTNA					
0307	M3X0,5	7.2	42.	9	60°
0406	M4X0.7	8.5	5.5	15	60°
0411	M4X0.7	11.0	5.5	15	60°
0415	M4X0.7	15.0	5.5	15	60°
0513	M5X0.8	13.0	7.0	20	60°
0516	M5X0.8	16.0	7.0	20	60°
0518	M5X1.0	17.2	8.8	20	60°

2023/05-1



EURLOY

ERW BORU UÇLARI

*ERW PIPE
SCARFING INSERTS*

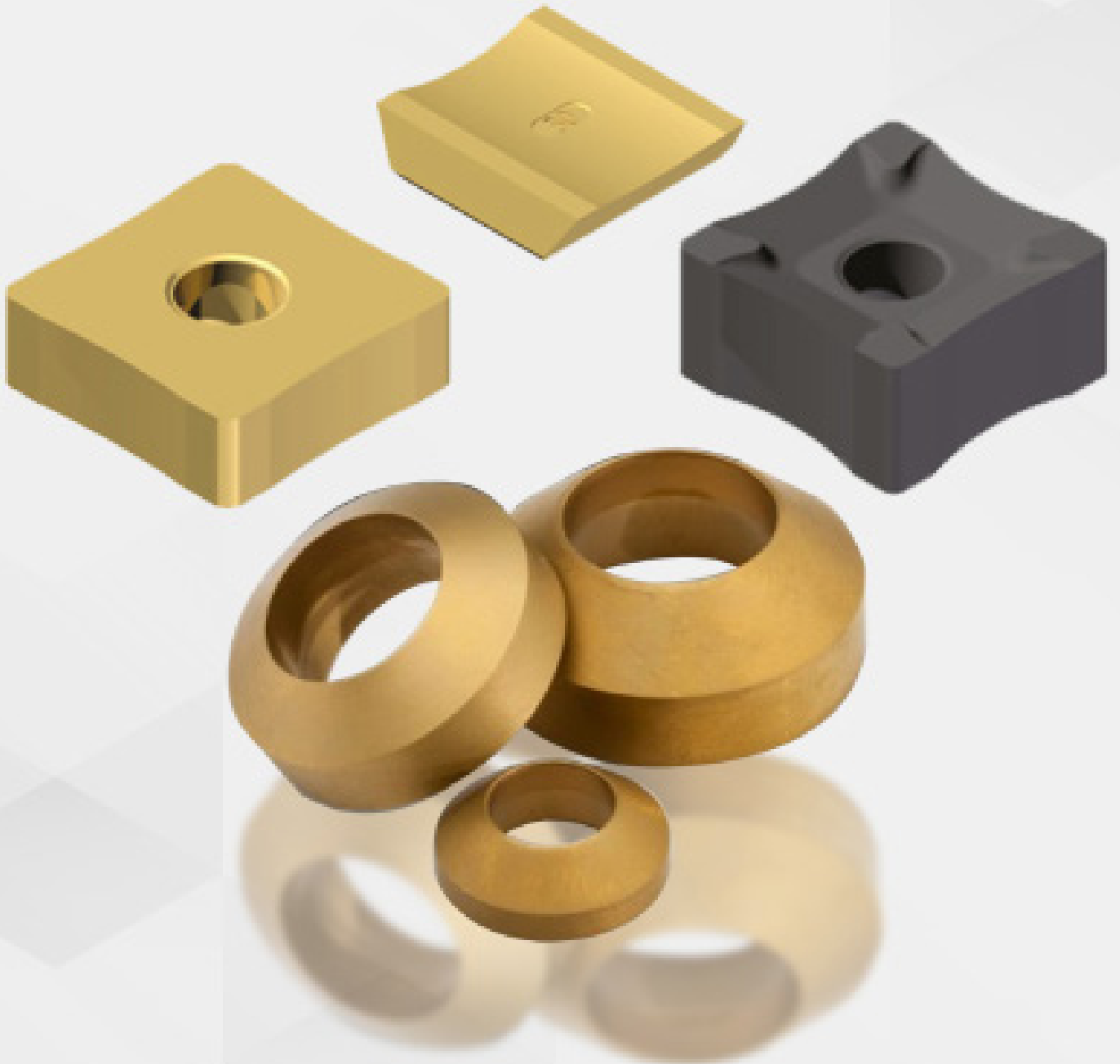

Çapak Alma Kalitelerinin Özellikleri Specifications Scarfing Grade

TCS615B

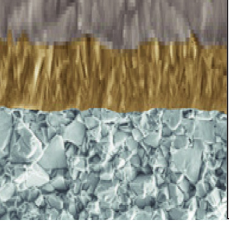

Yeni bir CVD-MT yüksek kalınlık teknolojisi ile kaplanmış TCS615B kalitesi sağlar mükemmel deformasyon özellikleri ve yüksek sıcaklık direnci ile. Özellikle yüksek kesme hızlarında finiş ve hafif kaba talaş işleme uygulamaları için uygundur. Çok çeşitli karbon çelikleri, alaşımlı çelikler, paslanmaz çelikler ve dökme demirler üzerine uygulanır.

TCS615B grade, coated with a new CVD-MT high thickness technology, is provided with excellent properties of deformation and high temperature resistance. Particularly suitable for finishing and light roughing applications in high cutting speed, it can be applied on a broad variety of carbon steels, alloy steels, stainless steels and cast irons.

TCS630B

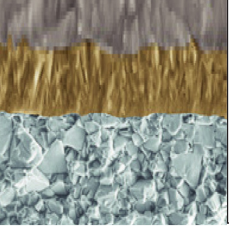

Yeni bir CVD-MT yüksek kalınlık teknolojisi ile kaplanmış TCS630B kalitesi, mükemmel deformasyon özellikleri ve yüksek sıcaklık dayanımı sağlar. Özellikle orta kesme hızı için uygundur.

TCS630B grade, coated with a new CVD-MT high thickness technology, is provided with excellent properties of deformation and high temperature resistance. Particularly suitable for medium cutting speed.

TCS630Y

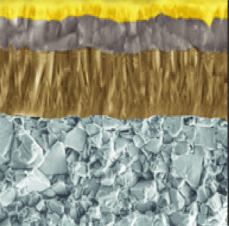

Yeni bir CVD-MT yüksek kalınlık teknolojisi ile kaplanmış TCS630Y kalitesi, mükemmel deformasyon özellikleri ve yüksek sıcaklık dayanımı sağlar. Kalitenin özelliklerine ek olarak TCS630Y, Titanijum Nitrid son kaplaması sayesinde kaldırılan daha iyi bir kaynak dikişi kayması sağlar.

TCS630Y grade, coated with a new CVD-MT high thickness technology, is provided with excellent properties of deformation and high temperature resistance. In addition to the grade's properties, TCS630Y ensures a better weld bead sliding, removed through its Titanium Nitride final coating.

TCS640Y

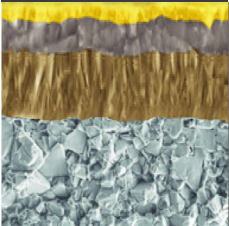

Yeni bir CVD-MT yüksek kalınlık teknolojisi ile kaplanmış TCS640Y kalitesi, mükemmel deformasyon özellikleri ve yüksek sıcaklık dayanımı sağlar. Kalitenin özelliklerine ek olarak, TCS640Y iyi bir tokluk.

TCS640Y grade, coated with a new CVD-MT high thickness technology, is provided with excellent properties of deformation and high temperature resistance. In addition to the grade's properties, TCS640Y ensures a good toughness.

Boru Çapı Tube Diameter				Radius	
MIN(mm)	MIN(in)	MAX(mm)	MAX(in)	r(mm)	r(in)
8,50	0,336	11,00	0,4330	7,00	0,2755
11,00	0,4330	13,50	0,5315	9,00	0,3543
13,50	0,5315	23,50	0,9252	11,00	0,4330
16,90	0,6653	27,50	1,0827	13,00	0,5118
23,20	0,9133	30,20	1,1890	15,00	0,5905
26,60	1,0472	34,50	1,3583	18,00	0,7086
28,50	1,2220	37,20	1,4646	20,00	0,7874
31,10	1,2244	40,50	1,5945	22,00	0,8661
33,40	1,3150	43,40	1,7087	25,00	0,9842
35,40	1,3937	44,20	1,7402	27,00	1,0630
40,50	1,5945	46,20	1,8189	30,00	1,1811
41,20	1,6220	53,60	2,1102	35,00	1,3780
50,00	1,9685	65,00	2,5591	40,00	1,5748
65,00	2,5591	90,00	3,5433	45,00	1,7717
90,00	3,5433	120,00	4,7244	50,00	1,9685
120,00	4,7244	150,00	5,9055	75,00	2,9528
150,00	5,9055	180,00	7,0866	100,00	3,9370

ERW BORU UÇLARI

ERW PIPE SCARFING INSERTS

●	Harika Excellent
○	Uygun Suitable

Kalite Grade	Cat. Cat.	ISO Sınıfı ISO Class						Uygulama Applications	
		P	M	K	N	S	H	EX	INT.
TC2615C	▶	●	●					●	○
TC1630C	▶	●	●					●	●

Klite / Grade	Uç Kaliteleri Insert Grade
----------------------	-------------------------------

Kategori / Category	Ürün her zaman mevcut Product always available
	Ürün mevcut / teslimat 4 hafta Product available / 4 week to delivery
	Ürün mevcut / teslimat 4 hafta Product available on order / 8 week to delivery

ISO Sınıf ISO Class	P	Çelik Steel
	M	Paslanmaz Çelik Stainless Steel
	K	Dökme demir Cast Iron
	N	Demir dışı Non Ferrous
	S	Süper alaşımlar Superalloys
	H	Sert metal Hard Metal

Uygulama Applications	EX	Dış Exterior
	INT	İç Interior

ERW BORU UÇLARI

ERW PIPE SCARFING INSERTS

 Dış Çapak Alma Uçları
Scarfing Inserts

SNMX 150608 21 R...

 Nasıl sipariş verilir?
How to order?

C/P 21

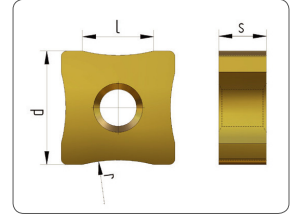

Kod Code	Kalite Grade
SNMX 150608 21 R11	TC2615C / TC1630C
SNMX 150608 21 R13	TC2615C / TC1630C
SNMX 150608 21 R15	TC2615C / TC1630C
SNMX 150608 21 R18	TC2615C / TC1630C
SNMX 150608 21 R20	TC2615C / TC1630C
SNMX 150608 21 R22	TC2615C / TC1630C
SNMX 150608 21 R25	TC2615C / TC1630C
SNMX 150608 21 R27	TC2615C / TC1630C
SNMX 150608 21 R30	TC2615C / TC1630C
SNMX 150608 21 R35	TC2615C / TC1630C
SNMX 150608 21 R40	TC2615C / TC1630C
SNMX 150608 21 R42	TC2615C / TC1630C
SNMX 150608 21 R45	TC2615C / TC1630C
SNMX 150608 21 R50	TC2615C / TC1630C
SNMX 150608 21 R60	TC2615C / TC1630C
SNMX 150608 21 R65	TC2615C / TC1630C
SNMX 150608 21 R70	TC2615C / TC1630C
SNMX 150608 21 R75	TC2615C / TC1630C
SNMX 150608 21 R80	TC2615C / TC1630C
SNMX 150608 21 R90	TC2615C / TC1630C
SNMX 150608 21 R105	TC2615C / TC1630C

ISO				
Çeşit Description	d(mm)	l(mm)	s(mm)	r(mm)
SNMX 150608 21 R11	15,87	10,00	6,35	11,00
SNMX 150608 21 R13	15,87	10,00	6,35	13,00
SNMX 150608 21 R15	15,87	10,00	6,35	15,00
SNMX 150608 21 R18	15,87	10,00	6,35	18,00
SNMX 150608 21 R20	15,87	10,00	6,35	20,00
SNMX 150608 21 R22	15,87	10,00	6,35	22,00
SNMX 150608 21 R25	15,87	10,00	6,35	25,00
SNMX 150608 21 R27	15,87	10,00	6,35	27,00
SNMX 150608 21 R30	15,87	10,00	6,35	30,00
SNMX 150608 21 R35	15,87	10,00	6,35	35,00
SNMX 150608 21 R40	15,87	10,00	6,35	40,00
SNMX 150608 21 R42	15,87	10,00	6,35	42,00
SNMX 150608 21 R45	15,87	10,00	6,35	45,00
SNMX 150608 21 R50	15,87	10,00	6,35	50,00
SNMX 150608 21 R60	15,87	10,00	6,35	60,00
SNMX 150608 21 R65	15,87	10,00	6,35	65,00
SNMX 150608 21 R70	15,87	10,00	6,35	70,00
SNMX 150608 21 R75	15,87	10,00	6,35	75,00
SNMX 150608 21 R80	15,87	10,00	6,35	80,00
SNMX 150608 21 R90	15,87	10,00	6,35	90,00
SNMX 150608 21 R105	15,87	10,00	6,35	105,00

ERW BORU UÇLARI

ERW PIPE SCARFING INSERTS

 Dış Çapak Alma Uçları
Scarfing Inserts

SNMX 150708 22 R...

 Nasıl sipariş verilir?
How to order?

C/P 22

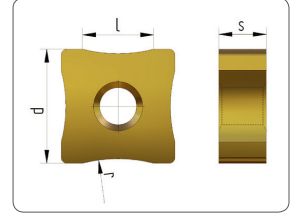

Kod Code	Kalite Grade
SNMX 150708 88 R7	TC2615C / TC1630C
SNMX 150708 88 R9	TC2615C / TC1630C
SNMX 15070 88 R11	TC2615C / TC1630C
SNMX 15070 88 R13	TC2615C / TC1630C
SNMX 150708 88 R15	TC2615C / TC1630C
SNMX 150708 88 R18	TC2615C / TC1630C
SNMX 150708 88 R20	TC2615C / TC1630C
SNMX 150708 88 R22	TC2615C / TC1630C
SNMX 150708 88 R25	TC2615C / TC1630C
SNMX 150708 88 R27	TC2615C / TC1630C
SNMX 150708 88 R30	TC2615C / TC1630C
SNMX 150708 88 R35	TC2615C / TC1630C
SNMX 150708 88 R40	TC2615C / TC1630C
SNMX 150708 88 R42	TC2615C / TC1630C
SNMX 150708 88 R45	TC2615C / TC1630C
SNMX 150708 88 R50	TC2615C / TC1630C
SNMX 150708 88 R60	TC2615C / TC1630C
SNMX 150708 88 R75	TC2615C / TC1630C
SNMX 150708 88 R90	TC2615C / TC1630C
SNMX 150708 88 R100	TC2615C / TC1630C

ISO				
Çeşit Description	d(mm)	l(mm)	s(mm)	r(mm)
SNMX 150708 22 R7	15,87	10,00	7,94	07,00
SNMX 150708 22 R9	15,87	10,00	7,94	09,00
SNMX 150708 22 R11	15,87	10,00	7,94	11,00
SNMX 150708 22 R13	15,87	10,00	7,94	13,00
SNMX 150708 22 R15	15,87	10,00	7,94	15,00
SNMX 150708 22 R18	15,87	10,00	7,94	18,00
SNMX 150708 22 R20	15,87	10,00	7,94	20,00
SNMX 150708 22 R22	15,87	10,00	7,94	22,00
SNMX 150708 22 R25	15,87	10,00	7,94	25,00
SNMX 150708 22 R27	15,87	10,00	7,94	27,00
SNMX 150708 22 R30	15,87	10,00	7,94	30,00
SNMX 150708 22 R35	15,87	10,00	7,94	35,00
SNMX 150708 22 R40	15,87	10,00	7,94	40,00
SNMX 150708 22 R42	15,87	10,00	7,94	42,00
SNMX 150708 22 R45	15,87	10,00	7,94	45,00
SNMX 150708 22 R50	15,87	10,00	7,94	50,00
SNMX 150708 22 R60	15,87	10,00	7,94	60,00
SNMX 150708 22 R75	15,87	10,00	7,94	75,00
SNMX 150708 22 R90	15,87	10,00	7,94	90,00
SNMX 150708 22 R100	15,87	10,00	7,94	100,00

SNMX 190612 21 R...

Kod Code	Kalite Grade
SNMX 190612 21 R50	TC2615C / TC1630C
SNMX 190612 21 R60	TC2615C / TC1630C
SNMX 190612 21 R70	TC2615C / TC1630C
SNMX 190612 21 R80	TC2615C / TC1630C
SNMX 190612 21 R90	TC2615C / TC1630C
SNMX 190612 21 R100	TC2615C / TC1630C

ISO				
Çeşit Description	d(mm)	l(mm)	s(mm)	r(mm)
SNMX 190612 21 R50	19,05	12,00	6,35	50,00
SNMX 190612 21 R60	19,05	12,00	6,35	60,00
SNMX 190612 21 R70	19,05	12,00	6,35	70,00
SNMX 190612 21 R80	19,05	12,00	6,35	80,00
SNMX 190612 21 R90	19,05	12,00	6,35	90,00
SNMX 190612 21 R100	19,05	12,00	6,35	100,00

ERW BORU UÇLARI

ERW PIPE SCARFING INSERTS



SNMX 190912 22 R...

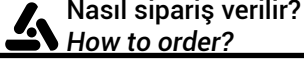

C/P 22

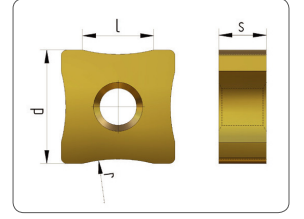

Kod Code	Kalite Grade
SNMX 190912 22 R30	TC2615C / TC1630C
SNMX 190912 22 R40	TC2615C / TC1630C
SNMX 190912 22 R50	TC2615C / TC1630C
SNMX 190912 22 R60	TC2615C / TC1630C
SNMX 190912 22 R70	TC2615C / TC1630C
SNMX 190912 22 R80	TC2615C / TC1630C
SNMX 190912 22 R90	TC2615C / TC1630C
SNMX 190912 22 R100	TC2615C / TC1630C

ISO				
Çeşit Description	d(mm)	l(mm)	s(mm)	r(mm)
SNMX 190912 22 R30	19,05	12,00	9,12	30,00
SNMX 190912 22 R40	19,05	12,00	9,12	40,00
SNMX 190912 22 R50	19,05	12,00	9,12	50,00
SNMX 190912 22 R60	19,05	12,00	9,12	60,00
SNMX 190912 22 R70	19,05	12,00	9,12	70,00
SNMX 190912 22 R80	19,05	12,00	9,12	80,00
SNMX 190912 22 R90	19,05	12,00	9,12	90,00
SNMX 190912 22 R100	19,05	12,00	9,12	100,00

SNMX 250924 21 R...

Kod Code	Kalite Grade
SNMX 250924 21 R50	TC2615C / TC1630C
SNMX 250924 21 R75	TC2615C / TC1630C
SNMX 250924 21 R100	TC2615C / TC1630C
SNMX 250924 21 R120	TC2615C / TC1630C
SNMX 250924 21 R140	TC2615C / TC1630C
SNMX 250924 21 R160	TC2615C / TC1630C
SNMX 250924 21 R180	TC2615C / TC1630C
SNMX 250924 21 R200	TC2615C / TC1630C

ISO				
Çeşit Description	d(mm)	l(mm)	s(mm)	r(mm)
SNMX 250924 21 R50	25,40	17,50	9,52	50,00
SNMX 250924 21 R75	25,40	17,50	9,52	75,00
SNMX 250924 21 R100	25,40	17,50	9,52	100,00
SNMX 250924 21 R120	25,40	17,50	9,52	120,00
SNMX 250924 21 R140	25,40	17,50	9,52	140,00
SNMX 250924 21 R160	25,40	17,50	9,52	160,00
SNMX 250924 21 R180	25,40	17,50	9,52	180,00
SNMX 250924 21 R200	25,40	17,50	9,52	200,00

SNMX 251224 22 R...

Kod Code	Kalite Grade
SNMX 251224 22 R00	TC2615C / TC1630C
SNMX 251224 22 R40	TC2615C / TC1630C
SNMX 251224 22 R50	TC2615C / TC1630C
SNMX 251224 22 R60	TC2615C / TC1630C
SNMX 251224 22 R70	TC2615C / TC1630C
SNMX 251224 22 R80	TC2615C / TC1630C
SNMX 251224 22 R90	TC2615C / TC1630C
SNMX 251224 22 R100	TC2615C / TC1630C

ISO				
Çeşit Description	d(mm)	l(mm)	s(mm)	r(mm)
SNMX 251224 22 R00	25,40	17,50	12,70	00,00
SNMX 251224 22 R40	25,40	17,50	12,70	40,00
SNMX 251224 22 R50	25,40	17,50	12,70	50,00
SNMX 251224 22 R60	25,40	17,50	12,70	60,00
SNMX 251224 22 R70	25,40	17,50	12,70	70,00
SNMX 251224 22 R80	25,40	17,50	12,70	80,00
SNMX 251224 22 R90	25,40	17,50	12,70	90,00
SNMX 251224 22 R100	25,40	17,50	12,70	100,00

ERW BORU UÇLARI

ERW PIPE SCARFING INSERTS

 Dış Çapak Alma Uçları
Scarfining Inserts

SNMX 251224 22 R...

 Nasıl sipariş verilir?
How to order?

Kod Code	Kalite Grade
SNMX 251224 22 R00	TC2615C / TC1630C
SNMX 251224 22 R40	TC2615C / TC1630C
SNMX 251224 22 R50	TC2615C / TC1630C
SNMX 251224 22 R60	TC2615C / TC1630C
SNMX 251224 22 R70	TC2615C / TC1630C
SNMX 251224 22 R80	TC2615C / TC1630C
SNMX 251224 22 R90	TC2615C / TC1630C
SNMX 251224 22 R100	TC2615C / TC1630C

C/P 22

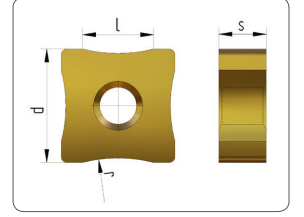

Çeşit Description	ISO			
	d(mm)	l(mm)	s(mm)	r(mm)
SNMX 251224 22 R00	25,40	17,50	12,70	00,00
SNMX 251224 22 R40	25,40	17,50	12,70	40,00
SNMX 251224 22 R50	25,40	17,50	12,70	50,00
SNMX 251224 22 R60	25,40	17,50	12,70	60,00
SNMX 251224 22 R70	25,40	17,50	12,70	70,00
SNMX 251224 22 R80	25,40	17,50	12,70	80,00
SNMX 251224 22 R90	25,40	17,50	12,70	90,00
SNMX 251224 22 R100	25,40	17,50	12,70	100,00

SNMG 150708 22 R...

Kod Code	Kalite Grade
SNMG 150708 22 R07	TC2615C / TC1630C
SNMG 150708 22 R09	TC2615C / TC1630C
SNMG 150708 22 R11	TC2615C / TC1630C
SNMG 150708 22 R13	TC2615C / TC1630C
SNMG 150708 22 R15	TC2615C / TC1630C
SNMG 150708 22 R18	TC2615C / TC1630C
SNMG 150708 22 R20	TC2615C / TC1630C
SNMG 150708 22 R22	TC2615C / TC1630C
SNMG 150708 22 R25	TC2615C / TC1630C
SNMG 150708 22 R27	TC2615C / TC1630C
SNMG 150708 22 R30	TC2615C / TC1630C

C/P 22

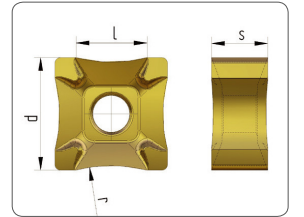

Çeşit Description	ISO			
	d(mm)	l(mm)	s(mm)	r(mm)
SNMG 150708 22 R07	15,88	10,00	7,94	07,00
SNMG 150708 22 R09	15,88	10,00	7,94	09,00
SNMG 150708 22 R11	15,88	10,00	7,94	11,00
SNMG 150708 22 R13	15,88	10,00	7,94	13,00
SNMG 150708 22 R15	15,88	10,00	7,94	15,00
SNMG 150708 22 R18	15,88	10,00	7,94	18,00
SNMG 150708 22 R20	15,88	10,00	7,94	20,00
SNMG 150708 22 R22	15,88	10,00	7,94	22,00
SNMG 150708 22 R25	15,88	10,00	7,94	25,00
SNMG 150708 22 R27	15,88	10,00	7,94	27,00
SNMG 150708 22 R30	15,88	10,00	7,94	30,00
SNMG 150708 22 R35	15,88	10,00	7,94	35,00
SNMG 150708 22 R40	15,88	10,00	7,94	40,00
SNMG 150708 22 R45	15,88	10,00	7,94	45,00
SNMG 150708 22 R50	15,88	10,00	7,94	50,00
SNMG 150708 22 R60	15,88	10,00	7,94	60,00

ERW BORU UÇLARI

ERW PIPE SCARFING INSERTS

 Dış Çapak Alma Uçları
Scarfig Inserts

SNMG 1908-P R...

 Nasıl sipariş verilir?
How to order?

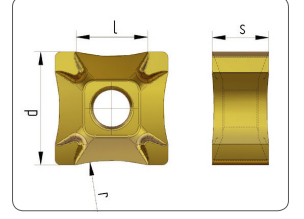

Kod Code	Kalite Grade
SNMG 1908-P R12	TC2615C / TC1630C
SNMG 1908-P R15	TC2615C / TC1630C
SNMG 1908-P R20	TC2615C / TC1630C
SNMG 1908-P R25	TC2615C / TC1630C
SNMG 1908-P R30	TC2615C / TC1630C
SNMG 1908-P R35	TC2615C / TC1630C
SNMG 1908-P R40	TC2615C / TC1630C
SNMG 1908-P R45	TC2615C / TC1630C
SNMG 1908-P R50	TC2615C / TC1630S
SNMG 1908-P R55	TC2615C / TC1630S
SNMG 1908-P R60	TC2615C / TC1630C

ISO				
Çeşit Description	d(mm)	l(mm)	s(mm)	r(mm)
SNMG 1908-P R12	19,05	12,00	8,15	12
SNMG 1908-P R15	19,05	12,00	8,15	15
SNMG 1908-P R20	19,05	12,00	8,15	20
SNMG 1908-P R25	19,05	12,00	8,15	25
SNMG 1908-P R30	19,05	12,00	8,15	30
SNMG 1908-P R35	19,05	12,00	8,15	35
SNMG 1908-P R40	19,05	12,00	8,15	40
SNMG 1908-P R45	19,05	12,00	8,15	45
SNMG 1908-P R50	19,05	12,00	8,15	50
SNMG 1908-P R55	19,05	12,00	8,15	55
SNMG 1908-P R60	19,05	12,00	8,15	60
SNMG 1908-P R65	19,05	12,00	8,15	65
SNMG 1908-P R70	19,05	12,00	8,15	70
SNMG 1908-P R75	19,05	12,00	8,15	75
SNMG 1908-P R80	19,05	12,00	8,15	80
SNMG 1908-P R85	19,05	12,00	8,15	85
SNMG 1908-P R90	19,05	12,00	8,15	90
SNMG 1908-P R95	19,05	12,00	8,15	95
SNMG 1908-P R100	19,05	12,00	8,15	100

SGGN 2005 R...

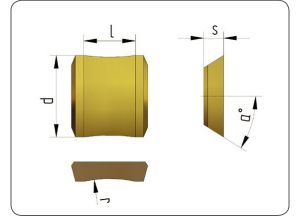

Kod Code	Kalite Grade
SGGN 2005 R00	TC2615C / TC1630C
SGGN 2005 R15	TC2615C / TC1630C
SGGN 2005 R20	TC2615C / TC1630C
SGGN 2005 R25	TC2615C / TC1630C
SGGN 2005 R30	TC2615C / TC1630C
SGGN 2005 R40	TC2615C / TC1630C
SGGN 2005 R45	TC2615C / TC1630C
SGGN 2005 R50	TC2615C / TC1630C
SGGN 2005 R70	TC2615C / TC1630C
SGGN 2005 R80	TC2615C / TC1630C

ISO					a°
Çeşit Description	d(mm)	l(mm)	s(mm)	r(mm)	
SGGN 2005 R00	20,00	13,00	5,00	00,00	32
SGGN 2005 R15	20,00	13,00	5,00	15,00	32
SGGN 2005 R20	20,00	13,00	5,00	20,00	32
SGGN 2005 R25	20,00	13,00	5,00	25,00	32
SGGN 2005 R30	20,00	13,00	5,00	30,00	32
SGGN 2005 R40	20,00	13,00	5,00	40,00	32
SGGN 2005 R45	20,00	13,00	5,00	45,00	32
SGGN 2005 R50	20,00	13,00	5,00	50,00	32
SGGN 2005 R70	20,00	13,00	5,00	70,00	32
SGGN 2005 R80	20,00	13,00	5,00	80,00	32

ERW BORU UÇLARI

ERW PIPE SCARFING INSERTS

 Dış Çapak Alma Uçları
Scarfig Inserts

LNGX 09 R...

 Nasıl sipariş verilir?
How to order?

Kod Code	Kalite Grade
LNGX 09 R06	TC2615C / TC1630C
LNGX 09 R08	TC2615C / TC1630C
LNGX 09 R10	TC2615C / TC1630C

ISO					a°
Çeşit Description	d(mm)	l(mm)	s(mm)	r(mm)	
LNGX 09 R06	14,00	09,00	6,30	06,00	20
LNGX 09 R08	14,00	09,00	6,30	08,00	20
LNGX 09 R10	14,00	09,00	6,30	10,00	20

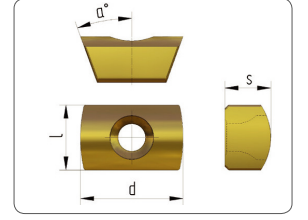

LNGX 17 R...

Kod Code	Kalite Grade
LNGX 17 R20	TC2615C / TC1630C
LNGX 17 R25	TC2615C / TC1630C
LNGX 17 R30	TC2615C / TC1630C

ISO					a°
Çeşit Description	d(mm)	l(mm)	s(mm)	r(mm)	
LNGX 17 R20	17,00	16,00	8,00	20,00	13
LNGX 17 R25	17,00	16,00	8,00	25,00	13
LNGX 17 R30	17,00	16,00	8,00	30,00	13

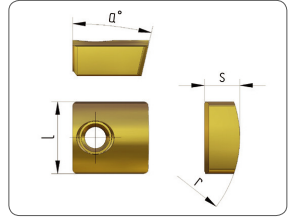

ERW BORU UÇLARI

ERW PIPE SCARFING INSERTS

 İç Çapak Alma Uçları
Bead Removal Inserts

PR

 Nasıl sipariş verilir?
How to order?

Kod Code	Kalite Grade
PR4	TC1630C
PR4.5	TC1630C
PR5	TC1630C

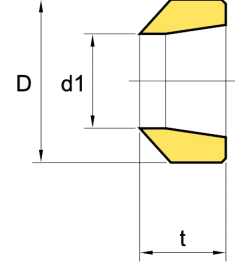

ISO				
Çeşit Description	DØ(mm)	Ød1(mm)	t(mm)	İşleme Aralığı Machining Range
PR4	8	4	6	12-17mm
PR4.5	8	5	6	12-17mm
PR5	10	5	6	16-20mm
PR6.5	10	6	6	16-20mm
PR7	13	6	6	20-36mm
PR8	13	7	6	20-36mm
PR9	13	8	6	20-36mm
PR9.5	15	7	7	25-42mm
PR9.10	15	8	7	25-42mm
PR9.15	15	9	7	25-42mm
PR10	19	9	8	30-60mm
PR11	19	10	8	30-60mm
PR12	19	11	8	30-60mm
PR13	22	10	10	42-70mm
PR14	22	12	10	42-70mm
PR16	22	14	10	42-70mm
PR18	25	12	12	48-76mm
PR20	25	15	12	48-76mm
PR22	30	18	12	60-89mm
PR22.5	30	20	12	60-89mm
PR23	35	20	15	76-127mm
PR25	35	22	15	76-127mm
PR28	35	25	15	76-127mm
PR32	40	25	15	108-177mm
PR34	45	30	15	127-193mm
PR31	45	28	17	133-219mm
PR39	50	35	18	159-273mm
PR40	55	35	18	219-508mm
PR42	55	38	18	219-508mm
PR42.2	55	38	20	273-610mm
PR46	55	40	20	273-610mm
PR44	65	45	20	325-660mm
PR44.5	70	50	25	426-710mm



info@euroloy.com
www.euroloy.com