

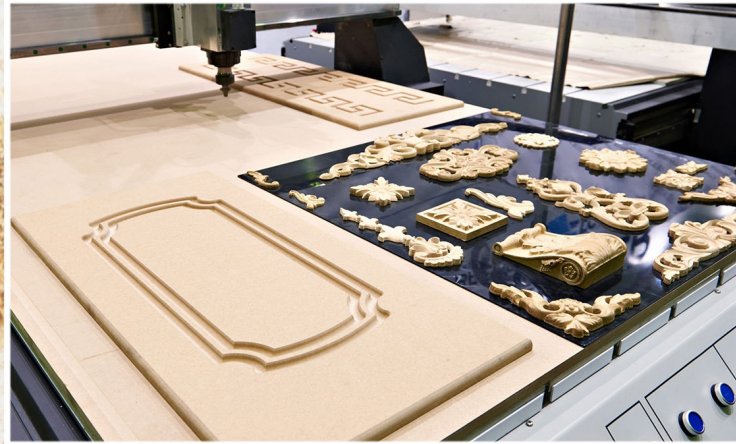



EURLEY

AHŞAP İŞLEME TAKIMLARI

WOODWORKING TOOLS



 Ahşap İşleme Karbür Kaliteleri
Woodworking Carbide Grades

Kalite Grade	ISO-KOD ISO-CODE	Bağlayıcı Binder	Sertlik Hardness	TRS (N/mm2)
TN7505F	K05-K10	6,0	92,5	2060
TN7520F	K20	10,0	91,5	2520
TN7510	K10	6,0	91,5	1860
TN7520	K20	6,0	90,5	1800
TN7530	K30	8,0	90,0	1950
TN7515	K10-K20	8,0	91,0	1920

 Ahşap İşleme Karbür Kalite Seçim Tablosu
Woodworking Carbide Grade Selection Table

Kalite Grade	HDF/MDF	Sunta Chipboard	Sert Kereste Hardwood	Yumuşak Kereste Softwood	Kontrplak Plywood
TN7505F	++	++	++	-	+
TN7520F	+	++	++	+	+
TN7510	-	+	++	++	++
TN7520	-	-	++	++	+
TN7530	-	-	+	++	-
TN7515	+	++	++	+	+

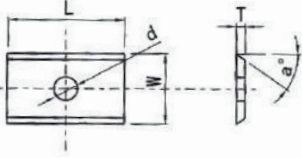

Tip Type	Ölçüler Dimension					Karbür Kaliteleri Carbide Grade			
	L	W	T	d	a	TN7530	TN7520	TN7505F	TN7520F
8,6x12x1,5	8,6	12	1,5	4,1	35°	●		●●	
9,0x12x1,5	9	12	1,5	4,1	35°	●		●●	
9,6x12x1,5	9,6	12	1,5	4,1	35°	●		●●	
10x12x1,5	10	12	1,5	4,1	35°	●		●●	
15x12x1,5	15	12	1,5	4,1	35°	●		●●	
20x12x1,5	20	12	1,5	4,1	35°	●		●●	
25x12x1,5	25	12	1,5	4,1	35°	●		●●	

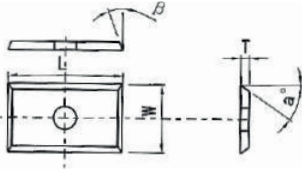

Tip Type	Ölçüler Dimension					Karbür Kaliteleri Carbide Grade			
	L	W	T	d	a	TN7530	TN7510	TN7505F	TN7520F
8,6x12x1,5-4	8,6	12	1,5	4,1	35°	●		●●	
9,0x12x1,5-4	9	12	1,5	4,1	35°	●		●●	
9,6x12x1,5-4	9,6	12	1,5	4,1	35°	●		●●	
10x12x1,5-4	10	12	1,5	4,1	35°	●		●●	
15x12x1,5-4	15	12	1,5	4,1	35°	●		●●	
20x12x1,5-4	20	12	1,5	4,1	35°	●		●●	
25x12x1,5-4	25	12	1,5	4,1	35°	●		●●	

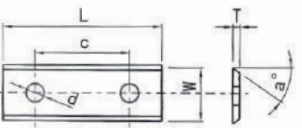

Tip Type	Ölçüler Dimension						Karbür Kaliteleri Carbide Grade			
	L	W	T	c	d	a	TN7530	TN7510	TN7505F	TN7520F
24,7x12x1,5	24,7	12	1,5	14,00	4,1	35°	●	●	●●	
25x12x1,5-4	25	12	1,5	14,00	4,1	35°	●	●	●●	
29,5x12x1,5	29	12	1,5	14,00	4,1	35°	●	●	●●	
30x12x1,5	30	12	1,5	14,00	4,1	35°	●	●	●●	
40x12x1,5	40	12	1,5	14,00	4,1	35°	●	●	●●	
50x12x1,5	50	12	1,5	14,00	4,1	35°	●	●	●●	
60x12x1,5	60	12	1,5	14,00	4,1	35°	●	●	●●	
63,5x12x1,5	63,5	12	1,5	14,00	4,1	35°	●	●	●●	
70x12x1,5	70	12	1,5	14,00	4,1	35°	●	●	●●	

Ahşap İşleme İçin Uçlar Inserts For Woodworking

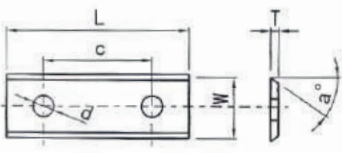

Tip Type	Ölçüler Dimension						Karbür Kaliteleri Carbide Grade			
	L	W	T	c	a	β	TN7530	TN7510	TN7505F	TN7520F
29,5x12x1,5-4	29,5	12	1,5	14,00	35°	35°	●		●●	
39,5x12x1,5-4	39,5	12	1,5	26,00	35°	35°	●		●●	
49,5x12x1,5-4	49,5	12	1,5	26,00	35°	35°	●		●●	
59,5x12x1,5-4	59,5	12	1,5	26,00	35°	35°	●		●●	
70x12x1,5-4	70	12	1,5	34,00	35°	35°	●		●●	

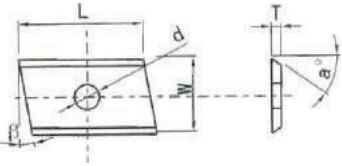

Tip Type	Ölçüler Dimension						Karbür Kaliteleri Carbide Grade			
	L	W	T	a	β	TN7530	TN7510	TN7505F	TN7520F	
18x12x1,5Y-5°	18	12	1,5	35°	5°		●	●●		
19,4x12x1,5Y-10°	19,4	12	1,5	35°	10°		●	●●		
19,5x12x1,5Y-15°	19,5	12	1,5	35°	15°		●	●●		

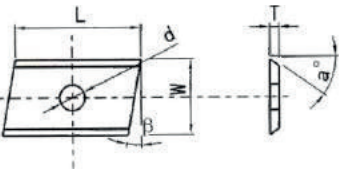

Tip Type	Ölçüler Dimension						Karbür Kaliteleri Carbide Grade			
	L	W	T	a	β	TN7530	TN7510	TN7505F	TN7520F	
18x12x1,5Y-5°	18	12	1,5	35°	5°		●	●●		
19,4x12x1,5Y-10°	19,4	12	1,5	35°	10°		●	●●		
19,5x12x1,5Y-15°	19,5	12	1,5	35°	15°		●	●●		

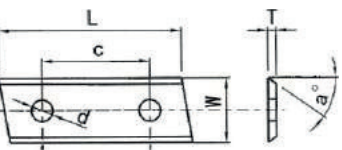

Tip Type	Ölçüler Dimension						Karbür Kaliteleri Carbide Grade			
	L	W	T	c	a	β	TN7530	TN7510	TN7505F	TN7520F
29,5x12x1,5Y-5°	29,6	12	1,5	14	35°	5°		●	●●	
30x12x1,5Y-5°	30	12	1,5	14	35°	5°		●	●●	
40x12x1,5Y-5°	40	12	1,5	14	35°	5°		●	●●	
40,9x12x1,5Y-5°	49,5	12	1,5	26	35°	5°		●	●●	
50x12x1,5Y-5°	50	12	1,5	26	35°	5°		●	●●	

AHŞAP İŞLEME TAKIMLARI

WOODWORKING CARBIDE GRADES

 Ahşap İşleme İçin Uçlar
Inserts For Woodworking

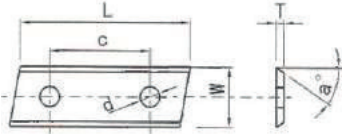

Tip Type	Ölçüler Dimension						Karbür Kaliteleri Carbide Grade			
	L	W	T	c	a	β	TN7530	TN7510	TN7505F	TN7520F
29,5x12x1,5Z-5°	29,6	12	1,5	14	35°	5°		●	●●	
30x12x1,5Z-5°	30	12	1,5	14	35°	5°		●	●●	
40x12x1,5Z-5°	40	12	1,5	14	35°	5°		●	●●	
40,9x12x1,5Z-5°	49,5	12	1,5	26	35°	5°		●	●●	
50x12x1,5Z-5°	50	12	1,5	26	35°	5°		●	●●	

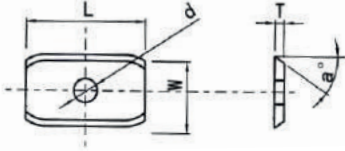

Tip Type	Ölçüler Dimension					Karbür Kaliteleri Carbide Grade			
	L	W	T	a	d	TN7530	TN7510	TN7505F	TN7520F
20x12x1,5-R	20	12	1,5	35°	4,1		●●		

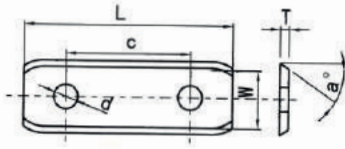

Tip Type	Ölçüler Dimension						Karbür Kaliteleri Carbide Grade			
	L	W	T	C	d	a	TN7530	TN7510	TN7505F	TN7520F
30x12x1,5R	30	12	1,5	14,00	4,1	35°	●		●●	
50x12x1,5R	50	12	1,5	26,00	4,1	35°	●		●●	

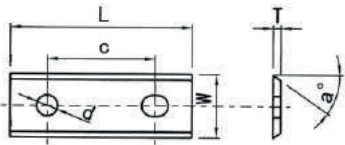

Tip Type	Ölçüler Dimension					Karbür Kaliteleri Carbide Grade			
	L	W	T	C	a	TN7530	TN7510	TN7505F	TN7520F
50x9,2x1,6	50	9,2	1,6	26,15	24°	●		●●	
79,85x13x2,2	79,85	13	2,2	60	35°	●		●●	
80x12x2,2	80	12	2,2	60	35°	●		●●	
100x12x2,2	100	12	2,2	60	35°	●			●●
120x12x2,2	120	12	2,2	60	35°	●			●●
80x13x2,2	80	13	2,2	60	35°	●		●●	
100x13x2,2	100	13	2,2	60	35°	●			●
120x13x2,2	120	13	2,2	60	35°	●			●
130x13x2,2	130	13	2,2	60	35°	●			●
315x12x2,0	318	12	2	198	45°	●			●

AHŞAP İŞLEME TAKIMLARI

WOODWORKING CARBIDE GRADES

Ahşap İşleme İçin Uçlar Inserts For Woodworking

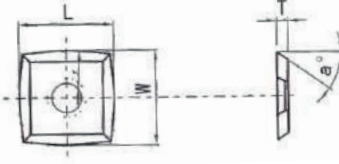

Tip Type	Ölçüler Dimension					Karbür Kaliteleri Carbide Grade			
	L	W	T	a	r	TN7530	TN7510	TN7505F	TN7520F
15x15x2,5-R50	15	15	2,5	30°	50	●		●●	
15x15x2,5-R150	15	15	2,5	30°	150	●		●●	

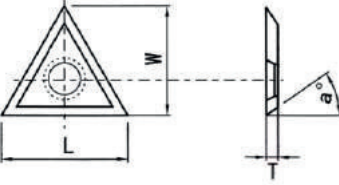

Tip Type	Ölçüler Dimension				Karbür Kaliteleri Carbide Grade			
	L	W	T	a	TN7530	TN7510	TN7505F	TN7520F
22x19x2	22	19	2	30°	●		●●	

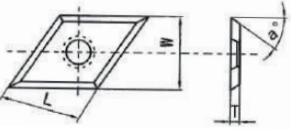

Tip Type	Ölçüler Dimension				Karbür Kaliteleri Carbide Grade			
	L	W	T	a	TN7530	TN7510	TN7505F	TN7520F
D14x14x2-30°	14	14	2	30°	●		●●	
D16x16x3-32°	16	14	3	32°	●		●●	
D16x16x3-30°	16	16	3	30°	●		●●	

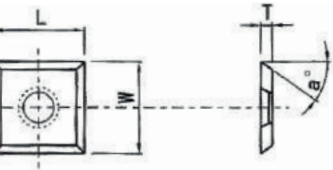

Tip Type	Ölçüler Dimension					Karbür Kaliteleri Carbide Grade			
	L	W	T	a	d	TN7530	TN7510	TN7505F	TN7520F
14x14x1,2	14	14	1,2	30°	8,54	●		●●	
14x14x1,7	14	14	1,7	30°	8,54	●		●●	
14x14x2	14	14	2	30°	6,5	●		●●	
14x14x2-35°	14	14	2	35°	6,5	●		●●	
14x14x2-37°	14	14	2	37°	6,5	●		●●	
13,6x13,6x2-35°	13,6	13,6	2	30°	6,5	●		●●	
14,3x14,3x2,5-35°	14,3	14,3	2,5	35°	6,3	●		●●	
14,6x14,6x2,5-35°	14,6	14,6	2,5	35°	6,3	●		●●	
15x15x2,5-30°	15	15	2,5	35°	6,25	●		●●	
15x15x2,5-35°	15	15	2,5	35°	6,25	●		●●	

 Ahşap İşleme İçin Uçlar
Inserts For Woodworking

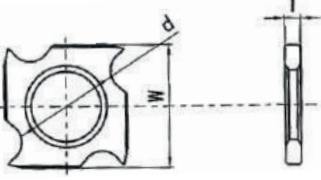

Tip Type	Ölçüler Dimension				Karbür Kaliteleri Carbide Grade			
	L	W	T	d	TN7530	TN7510	TN7505F	TN7520F
14x14x-φ8,4	14	14	2	8,4	●		●●	
18x18x1,95-φ10,3	18	18	1,95	10,3	●		●●	
18x18x2,45-φ10,3	18	18	2,45	10,3	●		●●	
18x18x2,95-φ10,3	18	18	2,95	10,3	●		●●	
18x18x3,7-φ10,3	18	18	3,7	10,3	●		●●	

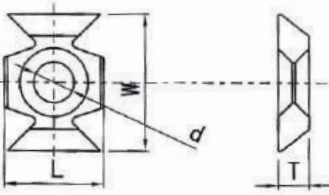

Tip Type	Ölçüler Dimension					Karbür Kaliteleri Carbide Grade			
	L	W	T	d	a°	TN7530	TN7510	TN7505F	TN7520F
YW22x16x5-R3	16	22	5	6,5	38°			●●	

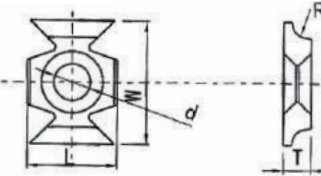

Tip Type	Ölçüler Dimension					Karbür Kaliteleri Carbide Grade			
	L	W	T	d	a°	TN7530	TN7510	TN7505F	TN7520F
YW22x16x5-38°	16	22	5	6,5	38°			●●	

AHŞAP İŞLEME TAKIMLARI

WOODWORKING CARBIDE GRADES

 Kesici Uçlar
Sealing Cutters

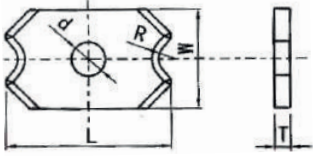

Tip Type	Ölçüler Dimension					Karbür Kaliteleri Carbide Grade			
	L	W	T	d	R	TN7530	TN7510	TN7505F	TN7520F
S2012R1	20	12	2	4,00	1	●		●●	
S2012R2	20	12	2	4,00	2	●		●●	
S2012R3	20	12	2	4,00	3	●		●●	
S2012R2,5	20	12	2	4,00	2,5	●		●●	
S2012R4	20	12	2	4,00	4	●		●●	
S2012R5	20	12	2	4,50	5	●		●●	
S2018R3	20	17,5	2	4,00	3	●		●●	

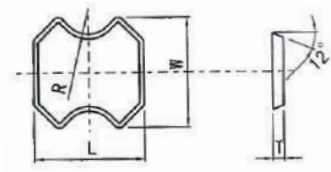

Tip Type	Ölçüler Dimension				Karbür Kaliteleri Carbide Grade			
	L	W	T	R	TN7530	TN7510	TN7505F	TN7520F
M1 27R2	12,7	14	3,2	2			●●	
M1 27R3	12,7	14	3,2	3			●●	

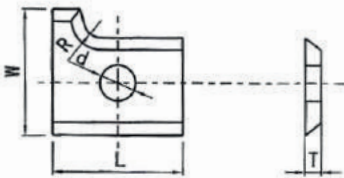

Tip Type	Ölçüler Dimension					Karbür Kaliteleri Carbide Grade			
	L	W	T	d	R	TN7530	TN7510	TN7505F	TN7520F
L12x14,5R2R-1	12	14,5	2	4,10	2	●		●●	
L12x14,5R2,5L-1	12	14,5	2	4,10	2,5	●		●●	
L12x14,5R3R-1	12	14,5	2	4,10	3	●		●●	
L20x14,5R1R-1	20	12	1,5	4,10	1	●		●●	
L20x14,5R1,5R-1	20	12	1,5	4,10	1,5	●		●●	
L20x14,5R3R-1	19,6	15,2	2	4,10	3	●		●●	

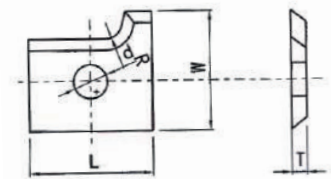

Tip Type	Ölçüler Dimension					Karbür Kaliteleri Carbide Grade			
	L	W	T	d	R	TN7530	TN7510	TN7505F	TN7520F
L12x14,5R2L-1	12	14,5	2	4,10	2	●		●●	
L12x14,5R2,5L-1	12	14,5	2	4,10	2,5	●		●●	
L12x14,5R3L-1	12	14,5	2	4,10	3	●		●●	
L20x14,5R1L-1	20	12	1,5	4,10	1	●		●●	
L20x14,5R1,5L-1	20	12	1,5	4,10	1,5	●		●●	
L20x14,5R3L-1	19,6	15,2	2	4,10	3	●		●●	

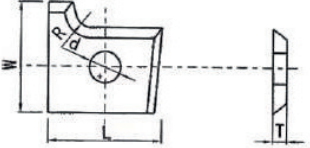

Tip Type	Ölçüler Dimension					Karbür Kaliteleri Carbide Grade			
	L	W	T	d	R	TN7530	TN7510	TN7505F	TN7520F
L12x18R3R-2	12	18	2	4	2	●		●●	
L12x18R2,5R-2	12	18	2	4	3	●		●●	

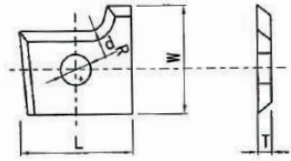

Tip Type	Ölçüler Dimension					Karbür Kaliteleri Carbide Grade			
	L	W	T	d	R	TN7530	TN7510	TN7505F	TN7520F
L12x18R3L-2	12	18	2	4	2	●		●●	
L12x18R2,5L-2	12	18	2	4	3	●		●●	

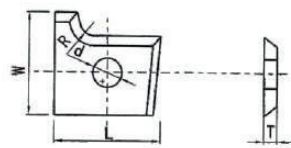

Tip Type	Ölçüler Dimension					Karbür Kaliteleri Carbide Grade			
	L	W	T	d	R	TN7530	TN7510	TN7505F	TN7520F
L12x14,5R2R-3	15	14,5	2	4	2	●		●●	
L12x14,5R2,5R-3	15	14,5	2	4	2,5	●		●●	
L12x14,5R3R-3	15	14,5	2	4	3	●		●●	

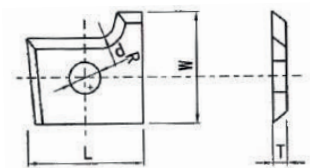

Tip Type	Ölçüler Dimension					Karbür Kaliteleri Carbide Grade			
	L	W	T	d	R	TN7530	TN7510	TN7505F	TN7520F
L12x14,5R2L-3	15	14,5	2	4	2	●		●●	
L12x14,5R2,5L-3	15	14,5	2	4	2,5	●		●●	
L12x14,5R3L-3	15	14,5	2	4	3	●		●●	

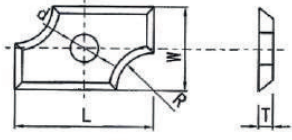

Tip Type	Ölçüler Dimension					Karbür Kaliteleri Carbide Grade			
	L	W	T	d	R	TN7530	TN7510	TN7505F	TN7520F
N20x16R3R-1	20	18	2	3	2	●		●●	
N19,8x11,6R3R-1	19,8	11,6	1,3	4,0	2	●		●●	
N30x14R2R-1	30	14	2	4	2	●		●●	
N30x14R2,5R-1	30	14	2	4	2,5	●		●●	
N30x14R3R-1	30	14	2	4	2	●		●●	

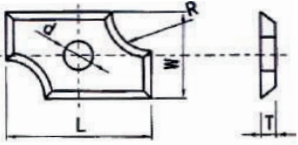

Tip Type	Ölçüler Dimension					Karbür Kaliteleri Carbide Grade			
	L	W	T	d	R	TN7530	TN7510	TN7505F	TN7520F
N20x16R3L-1	20	18	2	3	2	●		●●	
N19,8x11,6R3L-1	19,8	11,6	1,3	4,0	2	●		●●	
N30x14R2L-1	30	14	2	4	2	●		●●	
N30x14R2,5L-1	30	14	2	4	2,5	●		●●	
N30x14R3L-1	30	14	2	4	2	●		●●	

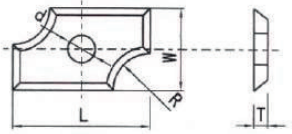

Tip Type	Ölçüler Dimension					Karbür Kaliteleri Carbide Grade			
	L	W	T	d	R	TN7530	TN7510	TN7505F	TN7520F
N19,5x9R2R-2	19,5	9	1,5	4	2	●		●●	
N19,5x9R3R-2	19,5	9	1,5	4	3	●		●●	
N19,5x9R4R-2	19,5	9	1,5	4	4	●		●●	
N19,5x9R5R-2	19,5	9	1,5	4	5	●		●●	

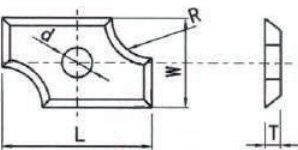

Tip Type	Ölçüler Dimension					Karbür Kaliteleri Carbide Grade			
	L	W	T	d	R	TN7530	TN7510	TN7505F	TN7520F
N19,5x9R2L-2	19,5	9	1,5	4	2	●		●●	
N19,5x9R3L-2	19,5	9	1,5	4	3	●		●●	
N19,5x9R4L-2	19,5	9	1,5	4	4	●		●●	
N19,5x9R5L-2	19,5	9	1,5	4	5	●		●●	

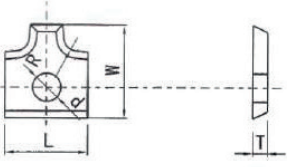

Tip Type	Ölçüler Dimension					Karbür Kaliteleri Carbide Grade			
	L	W	T	d	R	TN7530	TN7510	TN7505F	TN7520F
R16x17R2(2,5/3)-Φ3	16	17	2	3,00	2/2,5/3	●		●●	
R16x17R2(2,5/3)-Φ3,6	16	17	2	3,60	2/2,5/3	●		●●	
R16x17R2(2,5/3)-Φ4	16	17	2	4,00	2/2,5/3	●		●●	
R16x17R2(2,5/3)-Φ4,5	16	17	2	4,50	2/2,5/3	●		●●	
R16x17,5R2(2,5/3)-Φ3	16	17,5	2	3,00	2/2,5/3	●		●●	
R16x17,5R2(2,5/3)-Φ3,6	16	17,5	2	3,60	2/2,5/3	●		●●	
R16x17,5R2(2,5/3)-Φ4	16	17,5	2	4,00	2/2,5/3	●		●●	
R16x17,5R2(2,5/3)-Φ4,5	16	17,5	2	4,50	2/2,5/3	●		●●	
R20x12R2(2,5/3)-Φ4	20	12	1,5	4,00	2/2,5/3	●		●●	

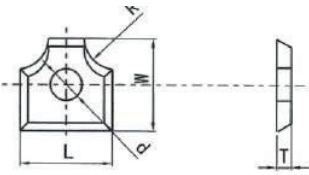

Tip Type	Ölçüler Dimension					Karbür Kaliteleri Carbide Grade			
	L	W	T	d	R	TN7530	TN7510	TN7505F	TN7520F
R12x12R2	12	12	1,5	4	2	●		●●	
R12x12R3	12	12	1,5	4	3	●		●●	
R12x12R4	12	12	1,5	4	4	●		●●	
R12x13R2	12	12	2	5	2	●		●●	
R12x13R3	12	12	2	5	3	●		●●	
R12x13R4	12	12	2	4	4	●		●●	

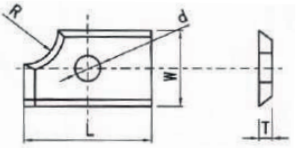

Tip Type	Ölçüler Dimension					Karbür Kaliteleri Carbide Grade			
	L	W	T	d	R	TN7530	TN7510	TN7505F	TN7520F
N14,5x12R1,8R-2	14,5	12	1,5	4	2	●		●●	
N14,5x12R3R-2	14,5	12	1,5	4	3	●		●●	

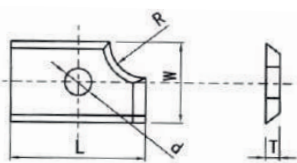

Tip Type	Ölçüler Dimension					Karbür Kaliteleri Carbide Grade			
	L	W	T	d	R	TN7530	TN7510	TN7505F	TN7520F
N14,5x12R1,8L-2	14,5	12	1,5	4	2	●		●●	
N14,5x12R3L-2	14,5	12	1,5	4	3	●		●●	

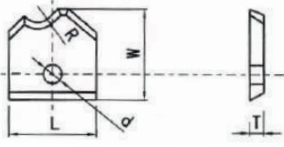

Tip Type	Ölçüler Dimension					Karbür Kaliteleri Carbide Grade			
	L	W	T	d	R	TN7530	TN7510	TN7505F	TN7520F
X16x17R1,5R-φ4,3	16	17	2	4,30	1,5	●		●●	
X16x17R2R-φ3,4	16	17	2	3,40	2	●		●●	
X16x17R2R-φ4	16	17	2	4,00	2	●		●●	
X16x17R2R-φ4,2	16	17	2	4,20	2	●		●●	
X16x17R2R-φ4,3	16	17	2	4,30	2	●		●●	
X16x17R3R-φ3,4	16	17	2	3,40	3	●		●●	
X16x17R3R-φ4	16	17	2	4,00	3	●		●●	
X16x17R3R-φ4,2	16	17	2	4,20	3	●		●●	
X16x17R3R-φ4,3	16	17	2	4,30	3	●		●●	
X16x17R3R-φ4,4	16	17	2	4,40	3	●		●●	

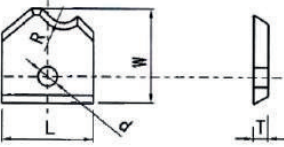

Tip Type	Ölçüler Dimension					Karbür Kaliteleri Carbide Grade			
	L	W	T	d	R	TN7530	TN7510	TN7505F	TN7520F
X16x17R1,5L-φ4,3	16	17	2	4,30	1,5	●		●●	
X16x17R2L-φ3,4	16	17	2	3,40	2	●		●●	
X16x17R2L-φ4	16	17	2	4,00	2	●		●●	
X16x17R2L-φ4,2	16	17	2	4,20	2	●		●●	
X16x17R2L-φ4,3	16	17	2	4,30	2	●		●●	
X16x17R3L-φ3,4	16	17	2	3,40	3	●		●●	
X16x17R3L-φ4	16	17	2	4,00	3	●		●●	
X16x17R3L-φ4,2	16	17	2	4,20	3	●		●●	
X16x17R3L-φ4,3	16	17	2	4,30	3	●		●●	
X16x17R3L-φ4,4	16	17	2	4,40	3	●		●●	

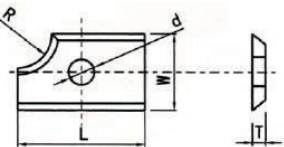

Tip Type	Ölçüler Dimension					Karbür Kaliteleri Carbide Grade			
	L	W	T	d	R	TN7530	TN7510	TN7505F	TN7520F
N20x12R3R-1	20	12	1,5	4,00	3	●		●●	

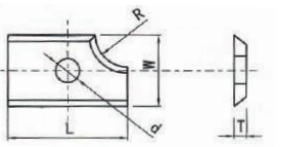

Tip Type	Ölçüler Dimension					Karbür Kaliteleri Carbide Grade			
	L	W	T	d	R	TN7530	TN7510	TN7505F	TN7520F
N20x12R3L-1	20	12	1,5	4,00	3	●		●●	

AHŞAP İŞLEME TAKIMLARI

WOODWORKING CARBIDE GRADES

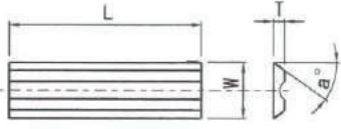

Tip Type	Ölçüler Dimension				Karbür Kaliteleri Carbide Grade			
	L	W	T	a	TN7530	TN7510	TN7505F	TN7520F
60x5,5x1,1	60	5,5	1,1	35°	●			
75x5,5x1,1	75	5,5	1,1	35°	●			
76x5,5x1,1	76	5,5	1,1	35°	●			
78x5,5x1,1	78	5,5	1,1	35°	●			
80x5,5x1,1	80	5,5	1,1	35°	●			
80,5x5,9x1,2	80,5	5,9	1,2	35°	●			
82x5,5x1,1	82	5,5	1,1	35°	●			
102x5,5x1,1	102	5,5	1,1	35°	●			

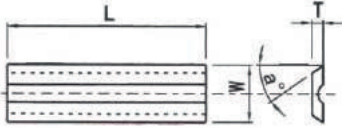

Tip Type	Ölçüler Dimension				Karbür Kaliteleri Carbide Grade			
	L	W	T	a	TN7530	TN7510	TN7505F	TN7520F
60x5,5x1,1-F	60	5,5	1,1	35°	●			
75x5,5x1,1-F	75	5,5	1,1	35°	●			
76x5,5x1,1-F	76	5,5	1,1	35°	●			
78x5,5x1,1-F	78	5,5	1,1	35°	●			
80x5,5x1,1-F	80	5,5	1,1	35°	●			
80,5x5,9x1,2-F	80,5	5,9	1,2	35°	●			
82x5,5x1,1-F	82	5,5	1,1	35°	●			
102x5,5x1,1-F	102	5,5	1,1	35°	●			

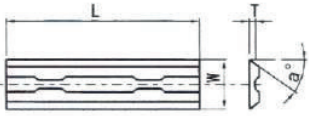

Tip Type	Ölçüler Dimension				Karbür Kaliteleri Carbide Grade			
	L	W	T	a	TN7530	TN7510	TN7505F	TN7520F
56x5,5x1,1P0	56	5,5	1,1	35°	●			
75,5x5,5x1,1P0	75,5	5,5	1,1	35°	●			
78x5,5x1,1P0	78	5,5	1,1	35°	●			
80,5x5,9x1,2P0	80,5	5,9	1,2	40°	●			
82x5,5x1,1P0	82	5,5	1,1	35°	●			
92x5,5x1,1P0	92	5,9	1,1	35°	●			
102x5,5x1,1P0	102	5,5	1,1	35°	●			

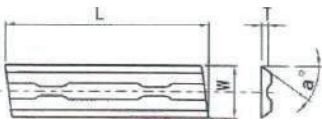

Tip Type	Ölçüler Dimension					Karbür Kaliteleri Carbide Grade			
	L	W	T	a	β	TN7530	TN7510	TN7505F	TN7520F
80,5x5,9x1,2P	80,5	5,9	1,2	40,00	8	●			
82x5,5x1,1P3	82,35	5,9	1,1	40,00	3	●			

AHŞAP İŞLEME TAKIMLARI

WOODWORKING CARBIDE GRADES

Planya Bıçağı
Planer Knives

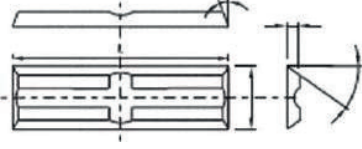

Ölçüler Dimension					Karbür Kaliteleri Carbide Grade			
L	W	T	a	β	TN7520F	TN7505F		
20	4,1	1,1	35,00	35	●●	●		
20	5,5	1,1	35,00	35	●●	●		
25	5,5	1,1	35,00	35	●●	●		
30	5,5	1,1	35,00	35	●●	●		
30	5,5	1,1	35,00	35	●●	●		
40	5,5	1,1	35,00	35	●●	●		
50	5,5	1,1	35,00	35	●●	●		

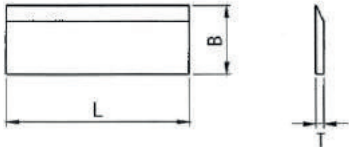

Tip Type	Ölçüler Dimension				Karbür Kaliteleri Carbide Grade			
	L	W	T	a	TN7530	TN7510	TN7505F	TN7520F
60x30x3-35°/40°/45°	60	30	3	35°/40°/45°	●		●●	
80x30x3-35°/40°/45°	80	30	3	35°/40°/45°	●		●●	
100x30x3-35°/40°/45°	100	30	3	35°/40°/45°	●		●●	
110x30x3-35°/40°/45°	110	30	3	35°/40°/45°	●		●●	
120x30x3-35°/40°/45°	120	30	3	35°/40°/45°	●		●●	
130x30x3-35°/40°/45°	130	30	3	35°/40°/45°	●		●●	
150x30x3-35°/40°/45°	150	30	3	35°/40°/45°	●		●●	
180x30x3-35°/40°/45°	180	30	3	35°/40°/45°	●		●●	
210x30x3-35°/40°/45°	210	30	3	35°/40°/45°	●		●●	
230x30x3-35°/40°/45°	230	30	3	35°/40°/45°	●		●●	
240x30x3-35°/40°/45°	240	30	3	35°/40°/45°	●		●●	
260x30x3-35°/40°/45°	260	30	3	35°/40°/45°	●		●●	
310x30x3-35°/40°/45°	310	30	3	35°/40°/45°	●		●●	
330x30x3-35°/40°/45°	330	30	3	35°/40°/45°	●		●●	
100x30x4-35°/40°/45°	100	30	4	35°/40°/45°	●		●●	
110x30x4-35°/40°/45°	110	30	4	35°/40°/45°	●		●●	
120x30x4-35°/40°/45°	120	30	4	35°/40°/45°	●		●●	
130x30x4-35°/40°/45°	130	30	4	35°/40°/45°	●		●●	
150x30x4-35°/40°/45°	150	30	4	35°/40°/45°	●		●●	
180x30x4-35°/40°/45°	180	30	4	35°/40°/45°	●		●●	
210x30x4-35°/40°/45°	210	30	4	35°/40°/45°	●		●●	
230x30x4-35°/40°/45°	230	30	4	35°/40°/45°	●		●●	
240x30x4-35°/40°/45°	240	30	4	35°/40°/45°	●		●●	
260x30x4-35°/40°/45°	260	30	4	35°/40°/45°	●		●●	
310x30x4-35°/40°/45°	310	30	4	35°/40°/45°	●		●●	
330x30x4-35°/40°/45°	330	30	4	35°/40°/45°	●		●●	

Planya Bıçakları Bıçak Boşlukları
Planer Knives Knife Blanks

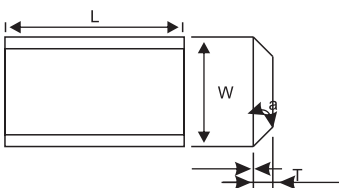

Tip Type	Ölçüler Dimension				Karbür Kaliteleri Carbide Grade			
	L	W	T	a	TN7530	TN7510	TN7505F	TN7520F
464x14,6x2,7-35°/40°/45°	464	14,6	2,7	35°/40°/45°	●		●●	
484x16,6x3,2-35°/40°/45°	484	16,6	3,2	35°/40°/45°	●		●●	
524x16,6x3,2-35°/40°/45°	524	16,6	3,2	35°/40°/45°	●		●●	
544x16,6x3,2-35°/40°/45°	544	16,6	3,2	35°/40°/45°	●		●●	
604x14,6x2,7-35°/40°/45°	604	14,6	2,7	35°/40°/45°	●		●●	

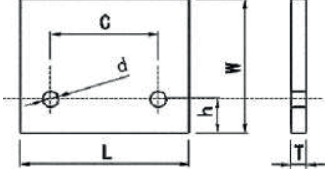

Ölçüler Dimension						Karbür Kaliteleri Carbide Grade	
L	W	T	C	h	d	TN7505F	TN7501
30	20,5	2	14,00	6,5	4,2	3021W05	3021W06
30	25,5	2	14,00	6,5	4,2	3026W05	3026W06
30	25,5	2	19,00	4,75	4,2	3026W15	3026W16
30	30,5	2	14,00	6,5	4,2	3031W05	3031W06
30	30,5	2	19,00	4,75	4,2	3031W05	3031W06
30	35	2	14,00	6,5	4,2	3036W05	3036W06
30	30,5	2	19,00	6,5	4,1	3030W05	3030W06
35	25,5	2	14,00	6,5	4,2	3526W05	3526W06
35	30,5	2	14,00	6,5	4,2	3531W05	3531W06
35	35,5	2	14,00	6,5	4,2	3536W05	3536W06
40	20,5	2	26,00	6,5	4,2	4021W15	4021W16
40	25,5	2	26,00	6,5	4,2	4026W05	4026W06
40	30,5	2	26,00	6,5	4,2	4031W05	4031W06
40	35,5	2	26,00	6,5	4,2	4036W05	4036W06
40	40,5	2	26,00	6,5	4,2	4041W05	4041W08
50	30	2	26,00	6,5	4,1	5030W25	5030W26
50	20,5	2	26,00	6,5	4,2	5021W05	5021W06
50	25,5	2	26,00	6,5	4,2	5026W05	5026W06
50	30,5	2	26,00	6,5	4,2	5031W05	5031W06
50	32,3	2	26,00	6,5	4,2	5033W05	5033W06
50	35,5	2	26,00	6,5	4,2	5036W05	5036W06
50	40,5	2	26,00	6,5	4,2	5041W05	5041W06
60	35,5	2	26,00	6,5	4,2	6036W05	6036W06
60	40,5	2	26,00	6,5	4,2	6041W05	6041W06
60	45,5	2	26,00	6,5	4,2	6046W05	6046W06
80	25,5	2	60,00	6,5	4,2	8026W05	8026W06
80	35,5	2	60,00	6,5	4,2	8036W05	8036W06
80	40,5	2	60,00	6,5	4,2	8041W05	8041W06

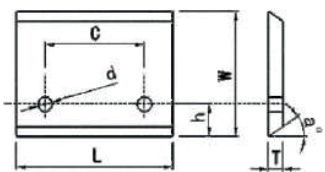

Ölçüler Dimension						Karbür Kaliteleri Carbide Grade	
L	W	T	C	h	d	TN7505F	TN7501
40	20	2	26,00	5,5	4,2	4020W05	4020W06
45	35	2	26,00	5,5	4,2	4535W15	4535W16
50	25	2	26,00	5,5	4,2	5025W15	5025W16
51	26	2	26,00	5,5	4,2	5126W15	5126W16

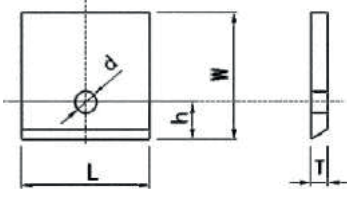

Ölçüler Dimension					Karbür Kaliteleri Carbide Grade	
L	W	T	h	d	TN7505F	TN7501
15	15,5	2	6,30	4,2	1516V05	1516V06
15	20,5	2	6,30	4,2	1521V05	1521V06
15	20,4	2	6,30	4,2	1521V15	1521V16
15	25,5	2	6,30	4,2	1526V05	1536V06
15	30,5	2	6,30	4,2	1531V05	1531V06
20	20,5	2	6,30	4,2	2021V15	2021V16
20	25,5	2	6,30	4,1	2026V35	2026V36
20	30,5	2	6,30	4,2	2031V25	2031V26
20	30,4	2	6,30	4,2	2031V35	2031V236
20	35,5	2	6,30	4,2	2036V15	2036V16
25	20,5	2	6,30	4,2	2521V25	2521V26
25	25,5	2	6,30	4,2	2526V15	2526V16
25	30,5	2	6,30	4,2	2531V15	2531V16
25	35,5	2	6,30	4,2	2536V15	2536V16
30	20,5	2	6,30	4,2	3021V15	3021V16
30	25,5	2	6,30	4,1	3026V15	3026V16
30	25,4	2	6,30	4,2	3026V25	3026V26
30	30,5	2	6,30	4,2	3031V15	3031V16
30	35,5	2	6,30	4,2	3036V15	3036V16
30	40,5	2	6,30	4,2	3041V05	3041V06
35	20,5	2	6,30	4,2	3521V05	3521V06
35	25,5	2	6,30	4,2	3526V15	3526V16
35	30,5	2	6,30	4,2	3531V15	3531V16
35	35,5	2	6,30	4,2	3536V15	3536V16
35	40,5	2	6,30	4,2	3541V05	3541V06
40	20,5	2	6,30	4,2	4021V05	4021V06
40	25,5	2	6,30	4,2	4026V05	4026V06
40	30,5	2	6,30	4,2	4031V15	4031V16
40	35,5	2	6,30	4,2	4036V05	4036V06
40	40	2	6,30	4,2	4041V05	4041V06

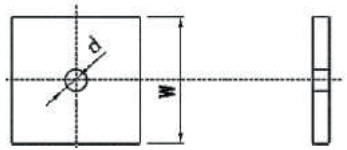

Ölçüler Dimension					Karbür Kaliteleri Carbide Grade	
L	W	T	C	h	TN7505F	TN7501
40	20	2	26,00	5,5	4020W05	4020W06
45	35	2	26,00	5,5	4535W15	4535W16
50	25	2	26,00	5,5	5025W15	5025W16
51	26	2	26,00	5,5	5126W15	5126W16

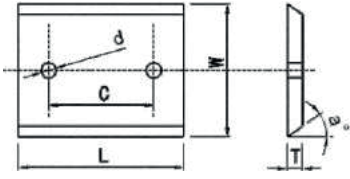

Ölçüler Dimension					Karbür Kaliteleri Carbide Grade	
L	W	T	h	d	TN7505F	TN7501
15	15,5	2	6,30	4,2	1516V05	1516V06
15	20,5	2	6,30	4,2	1521V05	1521V06
15	20,4	2	6,30	4,2	1521V15	1521V16
15	25,5	2	6,30	4,2	1526V05	1536V06
15	30,5	2	6,30	4,2	1531V05	1531V06
20	20,5	2	6,30	4,2	2021V15	2021V16
20	25,5	2	6,30	4,1	2026V35	2026V36
20	30,5	2	6,30	4,2	2031V25	2031V26
20	30,4	2	6,30	4,2	2031V35	2031V236
20	35,5	2	6,30	4,2	2036V15	2036V16
25	20,5	2	6,30	4,2	2521V25	2521V26
25	25,5	2	6,30	4,2	2526V15	2526V16
25	30,5	2	6,30	4,2	2531V15	2531V16
25	35,5	2	6,30	4,2	2536V15	2536V16
30	20,5	2	6,30	4,2	3021V15	3021V16
30	25,5	2	6,30	4,1	3026V15	3026V16
30	25,4	2	6,30	4,2	3026V25	3026V26
30	30,5	2	6,30	4,2	3031V15	3031V16
30	35,5	2	6,30	4,2	3036V15	3036V16
30	40,5	2	6,30	4,2	3041V05	3041V06
35	20,5	2	6,30	4,2	3521V05	3521V06
35	25,5	2	6,30	4,2	3526V15	3526V16
35	30,5	2	6,30	4,2	3531V15	3531V16
35	35,5	2	6,30	4,2	3536V15	3536V16
35	40,5	2	6,30	4,2	3541V05	3541V06
40	20,5	2	6,30	4,2	4021V05	4021V06
40	25,5	2	6,30	4,2	4026V05	4026V06
40	30,5	2	6,30	4,2	4031V15	4031V16
40	35,5	2	6,30	4,2	4036V05	4036V06
40	40	2	6,30	4,2	4041V05	4041V06

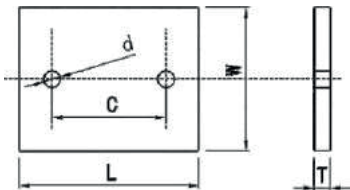

Ölçüler Dimension				Karbür Kaliteleri Carbide Grade	
L	W	T	d	TN7505F	TN7501F
24	22	2	4,2	2422V05	2422V06
28	24	2	4,2	2824V05	2824V06
32	24	2	4,2	3224V05	3224V06
36	28	2	4,1	3628V05	3628V06
40	26	2	4,2	4026V15	4026V16

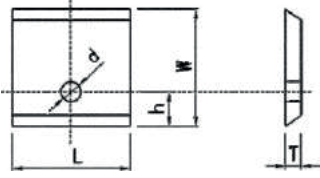

Ölçüler Dimension					Karbür Kaliteleri Carbide Grade	
L	W	T	h	d	TN7505F	TN7501
15	20	2	6,30	4,2	1520V05	1520V06
15	30	2	6,30	4,2	1530V05	1530V06
20	20	2	6,30	4,2	2020V05	2020V06
20	25	2	6,30	4,2	2025V05	2025V06
20	30	2	6,30	4,2	2030V05	2030V06
20	35	2	6,30	4,2	2035V05	2035V06
25	20	2	6,30	4,1	2520V05	2520V06
25	25	2	6,30	4,2	2525V05	2525V06
25	30	2	6,30	4,2	2530V05	2530V06
25	35	2	6,30	4,2	2535V05	2535V06
30	25	2	6,30	4,2	3025V05	3025V06
30	35	2	6,30	4,2	3035V05	3035V06
30	40	2	6,30	4,2	3040V05	3040V06
35	30	2	6,30	4,2	3530V05	3530V06
35	35	2	6,30	4,2	3535V05	3535V06

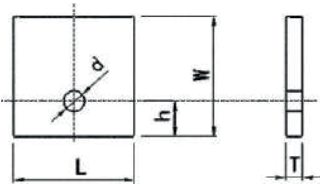

Ölçüler Dimension					Karbür Kaliteleri Carbide Grade	
L	W	T	h	d	TN7505F	TN7501
10	20,3	2	6,00	4,2	1021V05	1021V06
12	20,3	2	6,00	4,2	1221V05	1221V06
15,1	20,3	2	6,00	4,2	1621V05	1621V06
16,2	20,3	2	6,00	4,2	1721V05	1721V06
16,2	25,3	2	6,00	4,2	1726V05	1726V06
18	18,3	2	6,00	4,2	1819V05	1819V06
18,2	18,3	2	6,00	4,2	1919V05	1919V06
18,2	25,3	2	6,00	4,2	1926V05	1926V06
20	20,5	2	6,50	4,2	2021V05	2021V06
20	25,5	2	6,50	4,2	2026V05	2026V06
20	25,5	2	6,50	4,2	2026V15	2026V16
20,2	30,3	2	6,00	4,2	2131V05	2131V06
22,2	25,3	2	6,00	4,2	2326V05	2326V06
24	28,3	2	6,00	4,2	2429V05	2429V06
24,2	20,3	2	6,00	4,2	2521V05	2521V06
25	20,5	2	6,50	4,2	2521V15	2521V16
30	20,5	2	6,50	4,2	3021V05	3021V06
32	22,3	2	6,00	4,2	3223V05	3223V06
35	25,5	2	6,50	4,2	3526V05	3526V06
40	30,3	2	6,00	4,2	4031V05	4031V06

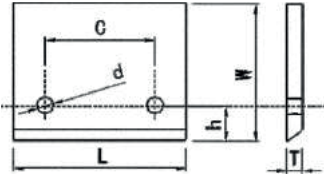

Ölçüler Dimension					Karbür Kaliteleri Carbide Grade	
L	W	T	C	d	TN7505F	TN7501
30	20,5	2	14,00	4,2	3021W15	3021W16
30	25,5	2	14,00	4,2	3026W25	3026W26
30	30,5	2	14,00	4,2	3031W25	3031W26
30	35,5	2	14,00	4,2	3036W15	3036W16
35	25,5	2	14,00	4,2	3526W15	3526W16
35	30,5	2	14,00	4,2	3531W15	3531W16
35	35,5	2	14,00	4,1	3536W15	3536W16
40	30,0	2	20,00	4,1	4030W25	4030W26
40	35,0	2	20,00	4,1	4035W55	4035W56
40	35,0	2	26,00	4,1	4035W65	4035W66
40	20,5	2	26,00	4,2	4021W25	4021W26
40	20,5	2	26,00	4,2	4021W35	4021W36
40	20,5	2	26,00	4,2	4021W45	4021W46
50	20,5	2	26,00	4,2	5021W15	5021W16
50	25,5	2	26,00	4,2	5026W15	5025W16
50	25,5	2	26,00	4,2	5026W25	5026W26
51	26,5	2	26,00	4,2	5127W05	5127W06
50	35,5	2	26,00	4,2	5036W15	5036W16
50	40,5	2	26,00	4,2	5041W15	5041W16
52	27,5	2	26,00	4,2	5228W05	5228W06
60	40,0	2	20,00	4,2	6040W65	6040W66
60	35,0	2	44,00	4,2	6035W05	6035W06
60	40,0	2	44,00	4,2	6040W75	6040W76
60	40,5	2	26,00	4,2	6041W15	6041W16
60	40,5	2	44,00	4,2	6041W25	6041W26
70	30,5	2	26,00	4,2	7031W05	7031W06
70	35,5	2	26,00	4,2	7036W05	7036W06
70	35,5	2	44,00	4,2	7036W15	7036W16
80	25,5	2	60,00	4,2	8026W15	8026W16
80	30,5	2	60,00	4,2	8031W05	8031W06
80	35,5	2	60,00	4,2	8036W15	8036W16
80	40,5	2	60,00	4,2	8041W15	8041W16

 Yuvarlak Kesiciler
Round Cutters

Tip Type	Ölçüler Dimension			Karbür Kaliteleri Carbide Grade			
	ΦD	Φd	S	TN7510	TN7510F		
Φ20xΦ5x0,2	20,0	5,0	0,2	●●	●●		
Φ28xΦ10x0,3	28,0	10,0	0,3	●●	●●		
45xΦ8x0,3	45,0	8,0	0,3	●●	●●		
Φ50xΦ10x0,6	50,0	10,0	0,6	●●	●●		
Φ60xΦ19x0,27	60,0	19,0	0,27	●●	●●		
Φ100xΦ25x0,25	100,0	25,0	0,25	●●	●●		
Φ105xΦ60x0,6	105	60	0,6	●●	●●		
Φ138xΦ60x1,2	138	60	1,2	●●	●●		
ΦxΦ60x1,2	180	25,4	0,75	●●	●●		
Φ180xΦ25,4x0,75	200	122	1,4	●●	●●		
Φ200xΦ122x1,4	210	122	1,4	●●	●●		
Φ210xΦ122x1,4	230(210)	11(130)	1,4	●●	●●		
Φ230-210xΦ110(130)x1,4	240	32	1,25	●●	●●		
Φ240xΦ32x1,25-2xΦ7,5	250	105(150)	1,5	●●	●●		
Φ250xΦ105(150)x 1,5-6xΦ11(3xΦ11)	260	140	1,5	●●	●●		
Φ260xΦ140x1,5	260	158(160)	1,5	●●	●●		
Φ260xΦ158(160)x1,5-8xΦ11	260(265)	114(112)	1,5	●●	●●		
Φ260(265)xΦ114 (112)x1,5-8xΦ11	270(260)	168,3	1,5	●●	●●		
Φ270(260)xΦ168,3x1,5-8xΦ11	270	170	1,5	●●	●●		
Φ280xΦ168x1,5-8xΦ11	280	168	1,5	●●	●●		
Φ290xΦ112x1,5-6xΦ11	290	112	1,5	●●	●●		
Φ50xΦ10x0,6				●●	●●		

 Testere Kesiciler
Saw Cutters

Tip Type	Ölçüler Dimension			Karbür Kaliteleri Carbide Grade			
	ΦD	T	Φd	TN7510	TN7510F		
Φ35x1/1,5/1,75-Φ18	35	1/1,5/1,75	18	●●	●●		
Φ70x1,0-Φ22	70	1,0	22	●●	●●		
Φ70x5,0-Φ22	75	5	22	●●	●●		
Φ85x0,7-Φ35	85	0,7	35	●●	●●		
Φ99,797x0,5-Φ15	99,797	0,5	15	●●	●●		
Φ100x1,0-Φ22	100	1	22	●●	●●		
Φ100x0,45/0,55-Φ25,4	100	0,45/0,55	25,4	●●	●●		
Φ125x0,5-Φ40	125	0,5	40	●●	●●		
Φ150x1,2-Φ50	150	1,2	50	●●	●●		

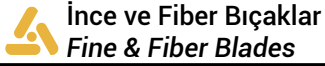

Tip Type	Ölçüler Dimension			Karbür Kaliteleri Carbide Grade		
	L	W	T	TN7510	TN7540	
43x22x0,4	43	22	0,2	●	●	
57x19x0,4	57	19	0,3	●	●	
57,05x19,05x0,4	57,05	19,05	0,3	●	●	
90x17x0,4	90	17	0,6	●	●	
91,5x20x1,8-450	91,5	20	0,27	●	●	
135x19x1,4	135	19	0,25	●	●	
140x18,5x1,5	140	18,5	0,6	●	●	
150x19x1,6	150	19	1,2	●	●	
152x17,3x0,15	152	17,3	0,75	●	●	
152x17,3x0,25	152	17,3	1,4	●	●	
169x17,3x0,15	169	17,3	1,4	●	●	
169x17,3x0,25	169	17,3	1,4	●	●	
169x17,3x2,5	169	17,3	1,25	●	●	
160x22,4x0,1	160	22,4	1,5	●	●	
160x22,4x0,2	160	22,4	1,5	●	●	
250x25x1,5	250	25	1,5	●	●	
360x23,6x0,6	360	23,6	1,5	●	●	
400x23,6x0,6	400	23,6	1,5	●	●	



Tip Type	Ölçüler Dimension			Karbür Kaliteleri Carbide Grade		
	L	W	T	TN7530	TN7515	
32,3x14x3,8	32,3	14	3,8	●	●	
39x14x3,5	39	14	3,5	●	●	
42,4x18,8x4,59	42,4	18,8	4,59	●	●	
44,45x18,65x4,76	44,45	18,65	4,76	●	●	
63x14x4	63	14	4	●	●	
60x20x20	63	20	20	●	●	
64x18x18	64	18	18	●	●	
71x14x3,5	71	14	3,5	●	●	

Tip Type	Ölçüler Dimension			Karbür Kaliteleri Carbide Grade		
	L	W	T	TN7510	TN7540	
22x6x0,8	22	6	0,8	●	●	
22x6x1	22	6	1	●	●	
24x3,97x0,3	24	3,97	0,4	●	●	
25x6x0,8	25	6	0,8	●	●	
28,9x7x1	28,9	7	1	●	●	
28x4x0,6	28	4	0,6	●	●	
28x5,6x0,6-1	28	5,6	0,6	●	●	
28x5,6x0,6-2	28	5,6	0,6	●	●	
29,64x7x1	29,64	7	1	●	●	
30,6x6x0,6	30,6	6	0,6	●	●	
34,5x7x1	34,5	7	1	●	●	
36,5x6x0,5-φ2,3	36,5	6	0,5	●	●	
40x7x0,6	40	7	0,6	●	●	

Tip Type	Ölçüler Dimension			Karbür Kaliteleri Carbide Grade		
	L	W	a°	TN7510	TN7540	
φ4x25,9x18°	22	25,9	18°	●	●	



www.euroloy.com

Head Office - La sede centrale
Via Leonardo Da Vinci 4
20054 Segrate
Milano / Italia

✉ info@euroloy.com

📷 [@euroloytools](https://www.instagram.com/euroloytools)

