

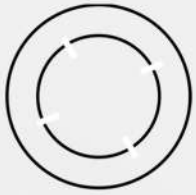

EUROLOY

CARBIDE RODS



**DELİKLİ
KARBÜR
ÇUBUKLAR**



**CARBIDE
RODS**



WITH HOLES

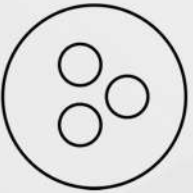

KALİTE VE SPESİFİKASYON BİLGİSİ

GRADE AND SPECIFICATION INFORMATION

Grade	Co (%)	HRA	Intensity (g/cm ³)	Cross Breaking Strength	Grain Size (µm)	Application Area
KH103S	10.3	92.2	14.43	3800	Superince Ultrafine	For general use of high-speed milling and drilling, applicable to alloy steel, stainless steel, cast iron, non-ferrous metal, süper alloy etc.
KH100SR	10.0	91.8	14.45	3700	Submicron	Economic grade for milling, applicable to alloy steel, non-ferrous metal etc.

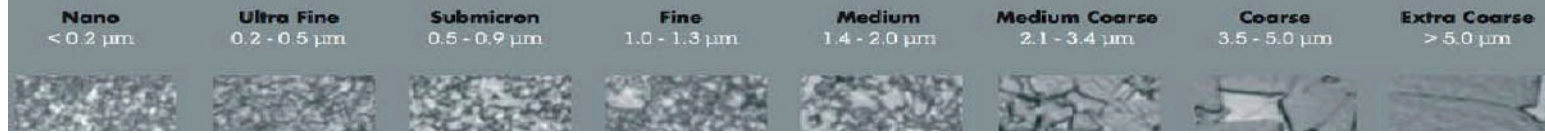

İKİ DÜZ DELİKLİ KARBÜR ÇUBUKLAR RODS WITH TWO STRAIGHT HOLES

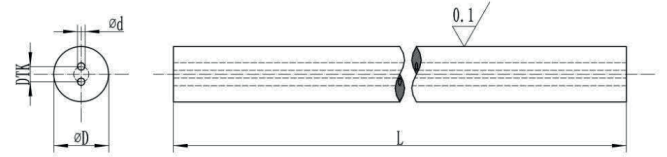

Taşlanmamış Unground	ØD(mm) Tolerans Tolerance	Taşlanmış Ground h6/h5	Ød(mm)		TkØ(mm)		Delik Sapması Hole Deviation	L(metric) (0,+5)
			Çap Diameter	Tolerans Tolerance	İki Delik Merkezinin Uzaklığı Bolt Core	Tolerans Tolerance		
6,3	+0/+0.2	6	0.8	±0,10	1.5	+0/-0.2	0.15	330
6,3	+0/+0.2	6	0.8	±0,10	3.0	+0/-0.2	0.15	330
7,3	+0/+0.3	7	1.0	±0,10	3,40	+0/-0.2	0.15	330
8,3	+0/+0.3	8	1.0	±0,10	2.60	+0/-0.2	0.15	330
9,3	+0/+0.3	9	1.0	±0,10	2,45	+0/-0.2	0.20	330
10,3	+0/+0.3	10	1.0	±0,15	2,60	+0/-0.3	0.20	330
10,3	+0/+0.3	10	1.4	±0,15	5,00	+0/-0.3	0.20	330
11,3	+0/+0.3	11	1.4	±0,15	4,85	+0/-0.3	0.30	330
12,3	+0/+0.3	12	1.2	±0,20	3,50	+0/-0.3	0.30	330
12,3	+0/+0.3	12	1.2	±0,20	3,60	+0/-0.3	0.30	330
12,3	+0/+0.3	12	1.2	±0,20	6,00	+0/-0.3	0.30	330
12,3	+0/+0.3	12	1,75	±0,20	3,50	+0/-0.3	0.30	330
13,3	+0/+0.4	13	1,8	±0,20	5,85	+0/-0.3	0.34	330
14,3	+0/+0.4	14	1.5	±0,20	5,00	+0/-0.3	0.37	330
14,3	+0/+0.4	14	1.75	±0,20	7,00	+0/-0.3	0.37	330
15,3	+0/+0.4	15	2,0	±0,20	6,85	+0/-0.3	0.40	330
16,3	+0/+0.4	16	1.5	±0,20	5,00	+0/-0.3	0.45	330
16,3	+0/+0.4	16	2,0	±0,20	8,00	+0/-0.3	0.45	330
17,3	+0/+0.5	17	2,0	±0,20	7,85	+0/-0.3	0.47	330
18,3	+0/+0.5	18	2,0	±0,20	6,20	+0/-0.3	0.50	330
18,3	+0/+0.5	18	2,0	±0,20	9,00	+0/-0.3	0.50	330
19,3	+0/+0.5	19	2,0	±0,20	8,85	+0/-0.3	0.50	330
20,3	+0/+0.5	20	2,0	±0,25	6,20	+0/-0.3	0.50	330
20,3	+0/+0.5	20	2.5	±0,25	10,00	+0/-0.3	0.50	330
21,3	+0/+0.5	21	2.5	±0,25	9,80	+0/-0.3	0.50	330
22,3	+0/+0.5	22	2.5	±0,25	10,8	+0/-0.4	0.50	330
22,3	+0/+0.5	22	2.5	±0,25	11,00	+0/-0.4	0.50	330
23,3	+0/+0.5	23	2.5	±0,25	10,8	+0/-0.4	0.50	330
24,3	+0/+0.5	24	3,0	±0,25	11,75	+0/-0.4	0.50	330
25,3	+0/+0.5	25	3,0	±0,25	11,75	+0/-0.4	0.50	330
25,3	+0/+0.5	25	3,0	±0,25	11,70	+0/-0.4	0.50	330
25,3	+0/+0.5	25	3,0	±0,25	12,00	+0/-0.4	0.50	330
26,3	+0/+0.5	26	3,0	±0,25	13,00	+0/-0.5	0.50	330

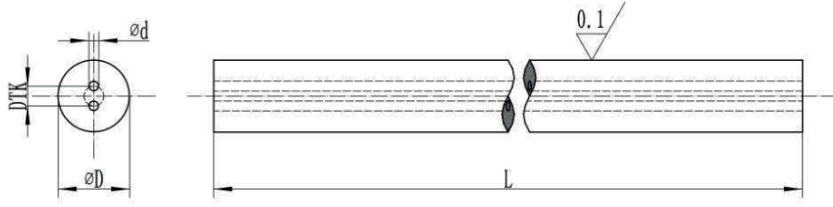

Taşlanmamış Unground	ØD(mm) Tolerans Tolerance	Taşlanmış Ground h6/h5	Ød(mm)		TkØ(mm)		Delik Sapması Hole Deviation	L(metric) (0,+5)
			Çap Diameter	Tolerans Tolerance	İki Delik Merkezinin Uzaklığı Bolt Core	Tolerans Tolerance		
28,3	+0/+0.5	28	2,5	±0,25	9,00	+0/-0.5	0.50	330
28,3	+0/+0.5	28	3,0	±0,25	14,00	+0/-0.5	0.50	330
28,3	+0/+0.5	28	3,0	±0,25	13,75	+0/-0.5	0.50	330
30,3	+0/+0.5	30	3,0	±0,25	14,00	+0/-0.5	0.50	330
30,3	+0/+0.5	30	3,0	±0,25	13,00	+0/-0.5	0.50	330
32,3	+0/+0.5	32	3,0	±0,25	14,00	+0/-0.5	0.50	330
32,3	+0/+0.5	32	3,0	±0,25	13,80	+0/-0.5	0.50	330
22,0	+0/+0.4	22	2,5	±0,25	11,00	+0/+0.4	0.50	330
25,0	+0/+0.5	25	3,0	±0,25	12,00	+0/+0.5	0.50	330
28,0	+0/+0.4	28	2,0	±0,20	6,40	+0/+0.4	0.50	330
30,0	+0/+0.5	30	3,0	±0,25	13,2	+0/+0.5	0.50	330
32,0	+0/+0.5	32	3,0	±0,25	14,00	+0/+0.5	0.50	330

ØD(inch)	Taşlanmamış Unground	Taşlanmış Ground	Ød(inch)		TkØ(mm)		Delik Sapması Hole Deviation	L(inch) (0,+0.197)
			Çap Diameter	Tolerans Tolerance	İki Delik Merkezinin Uzaklığı Bolt Core	Tolerans Tolerance		
1/4	+0.0118/+0.0236	h6/h5	3/77	±0,0039	4/35	+0/-0.0078	0,0059	13
9/32	+0.0118/+0.0236	h6/h5	3/77	±0,0039	2/15	+0/-0.0078	0,0059	13
5/16	+0.0118/+0.0236	h6/h5	4/85	±0,0059	5/33	+0/-0.0078	0,0059	13
25/64	+0.0118/+0.0236	h6/h5	1/16	±0,0059	17/89	+0/-0.0118	0,0079	13
13/32	+0.0118/+0.0236	h6/h5	1/16	±0,0059	17/89	+0/-0.0118	0,0118	13
27/64	+0.0118/+0.0236	h6/h5	1/16	±0,0059	3/13	+0/-0.0118	0,0118	13
31/64	+0.0118/+0.0275	h6/h5	3/38	±0,0098	3/13	+0/-0.0118	0,0118	13
1/2	+0.0118/+0.0275	h6/h5	3/38	±0,0098	3/13	+0/-0.0118	0,0134	13
9/16	+0.0118/+0.0275	h6/h5	5/51	±0,0098	24/89	+0/-0.0118	0,0146	13
5/8	+0.0118/+0.0275	h6/h5	2/17	±0,0098	17/55	+0/-0.0118	0,0177	13
3/4	+0.0118/+0.0314	h6/h5	2/17	±0,0098	23/66	+0/-0.0118	0,0197	13
13/16	+0.0118/+0.0314	h6/h5	2/17	±0,0098	27/70	+0/-0.0118	0,0197	13

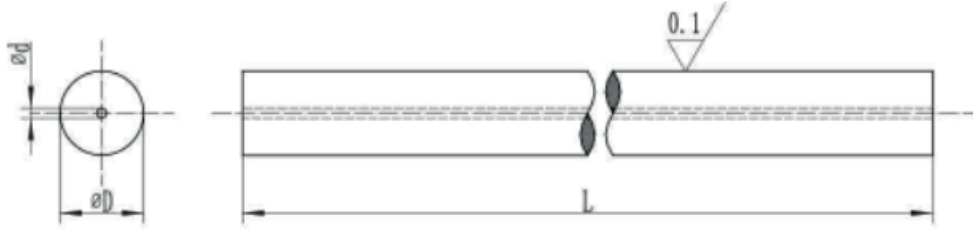

Taşlanmamış Unground	Tolerans Tolerance	Taşlanmış Ground h6/h5	Ød(mm)		Delik Sapması Hole Deviation	L(metric) (0.+5)
			Çap Diameter	Tolerans Tolerance		
4.3	+0/+0.2	4	0,6	±0.1	0.07	330
5.3	+0/+0.2	5	1,0	±0.1	0.07	330
6.3	+0/+0.2	6	1,0	±0.1	0.07	330
8.3	+0/+0.3	8	1,0	±0.15	0.07	330
10.3	+0/+0.3	10	1,4	±0.2	0.10	330
12.3	+0/+0.3	12	1,75	±0.2	0.10	330
14.3	+0/+0.4	14	1,75	±0.2	0.12	330
16.3	+0/+0.4	16	2,0	±0.2	0.12	330
18.3	+0/+0.5	18	2,0	±0.25	0.15	330
20.3	+0/+0.5	20	2,5	±0.25	0.15	330
22.3	+0/+0.5	22	3,0	±0.25	0.15	330
24.3	+0/+0.5	24	4,0	±0.25	0.15	330
26.3	+0/+0.5	26	4,0	±0.25	0.15	330
28.3	+0/+0.5	28	4,0	±0.25	0.15	330
30.3	+0/+0.5	30	5,0	±0.25	0.15	330
32.3	+0/+0.5	32	5,0	±0.25	0.15	330

ØD(inch)	Taşlanmamış Tolerans Unground Tol.	Taşlanmış Ground	Ød(inch)		Hole Deviation Delik Sapması	L(inch) (0.+0.197)
			Çap Diameter	Tolerans Tolerance		
1/4	+0.0118/+0.0236	h6/h5	3/77	±0.0039	0.0027	13
9/32	+0.0118/+0.0236	h6/h5	3/77	±0.0039	0.0027	13
5/16	+0.0118/+0.0236	h6/h5	4/85	±0.0059	0.0027	13
25/64	+0.0118/+0.0236	h6/h5	1/16	±0.0059	0.0039	13
13/32	+0.0118/+0.0236	h6/h5	1/16	±0.0059	0.0039	13
277/64	+0.0118/+0.0236	h6/h5	1/16	±0.0059	0.0039	13
31/64	+0.0118/+0.0275	h6/h5	3/38	±0.0098	0.0047	13
1/2	+0.0118/+0.0275	h6/h5	3/38	±0.0098	0.0047	13
9/16	+0.0118/+0.0275	h6/h5	5/51	±0.0098	0.0047	13
5/8	+0.0118/+0.0275	h6/h5	2/17	±0.0098	0.0047	13
3/4	+0.0118/+0.0314	h6/h5	2/17	±0.0098	0.0059	13
13/16	+0.0118/+0.0314	h6/h5	2/17	±0.0098	0.0059	13

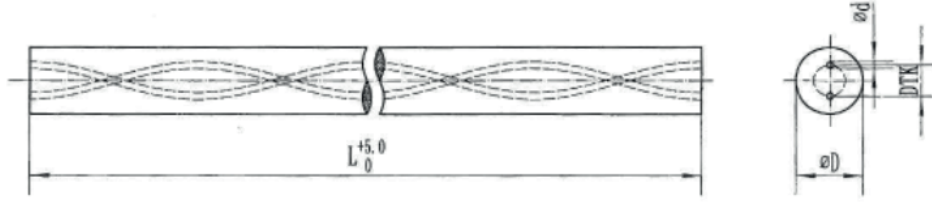

ØD(mm)		Taşlanmış Ground h6/h5	Ød(mm)		TkØ(mm)		Eğim Pitch (±0.5°)	Delik Sapması Hole Deviation	L(mm) (0,+5°)
Taşlanmamış Unground	Tolerans Tolerance		Çap Diameter	Tolerans Tolerance	İki Delik Merkezinin Uzaklığı Bolt Core	Tolerans Tolerance			
6,0	+0.7/+1.1	6,0	0,70	±0,10	2,40	+0/-0,4	32,65	0,15	330
6,0	+0.7/+1.1	6,0	0,70	±0,10	2,60	+0/-0,4	32,65	0,15	330
8,0	+0.8/+1.2	8,0	1,00	±0,15	3,80	+0/-0,4	43,53	0,15	330
8,0	+0.8/+1.2	8,0	1,00	±0,15	4,00	+0/-0,4	43,53	0,15	330
10,0	+0.8/+1.2	10,0	1,40	±0,15	4,50	+0/-0,6	54,41	0,20	330
10,0	+0.8/+1.2	10,0	1,40	±0,15	4,80	+0/-0,6	54,41	0,20	330
10,0	+0.8/+1.2	10,0	1,40	±0,15	4,00	+0/-0,6	54,41	0,20	330
12,0	+0.9/+1.3	12,0	1,40	±0,15	5,85	+0/-0,8	65,30	0,30	330
12,0	+0.9/+1.3	12,0	1,40	±0,15	6,25	+0/-0,8	65,30	0,30	330
14,0	+0.9/+1.3	14,0	1,75	±0,20	6,70	+0/-0,8	76,18	0,40	330
14,0	+0.9/+1.3	14,0	1,75	±0,20	7,10	+0/-0,8	76,18	0,40	330
15,0	+0.9/+1.3	15,0	1,75	±0,20	7,70	+0/-0,8	81,62	0,40	330
16,0	+1.0/+1.4	16,0	1,75	±0,20	8,30	+0/-0,8	87,06	0,40	330
18,0	+1.0/+1.4	18,0	2,00	±0,25	9,25	+0/-0,8	97,95	0,50	330
18,0	+1.0/+1.4	18,0	2,00	±0,25	9,55	+0/-0,8	97,95	0,50	330
18,0	+1.0/+1.4	18,0	2,0	±0,25	8,50	+0/-0,8	97,95	0,50	330
20,0	+1.0/+1.4	20,0	2,00	±0,25	10,40	+0/-1,0	108,83	0,50	330
22,0	+1.0/+1.5	22,0	2,00	±0,25	11,10	+0/-1,0	119,71	0,50	330
22,0	+1.0/+1.5	22,0	2,00	±0,25	11,60	+0/-1,0	119,71	0,50	330
25,0	+1.1/+1.6	25,0	2,00	±0,25	12,80	+0/-1,0	136,03	0,50	330
25,0	+1.1/+1.6	25,0	2,00	±0,25	13,30	+0/-1,0	136,03	0,50	330



www.euroloy.com
www.karburkesici.com