

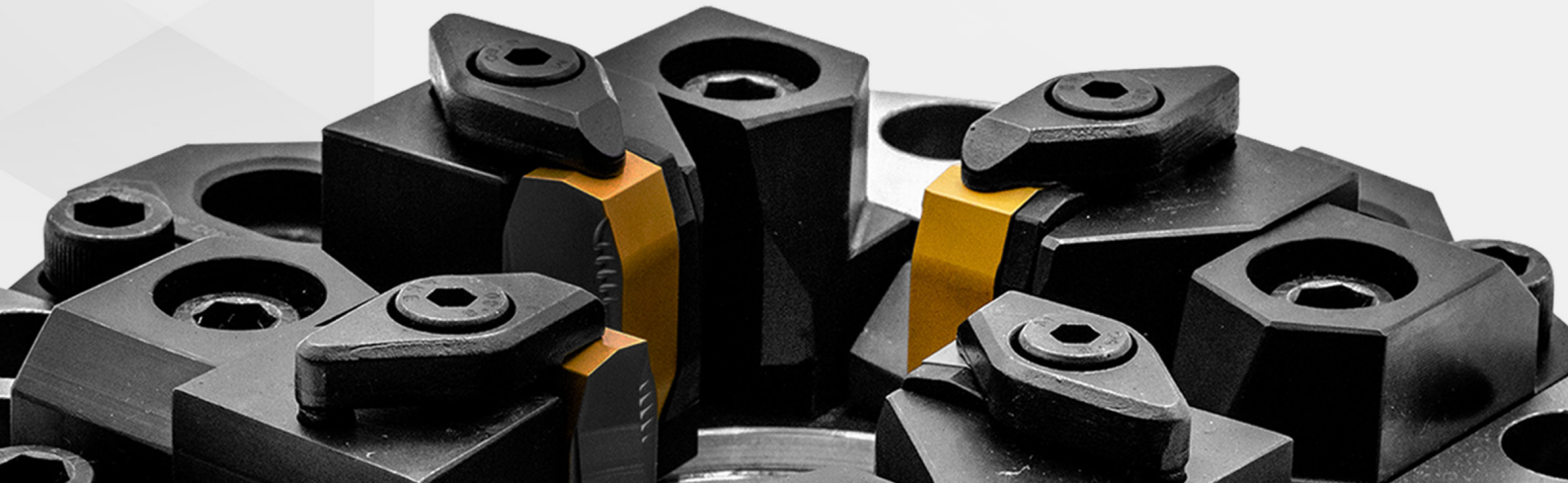

**EURLOY**

**KABUK SOYMA UÇLARI**

**BAR PEELING INSERTS**



## KABUK SOYMA UÇLARI

### BAR PEELING INSERT

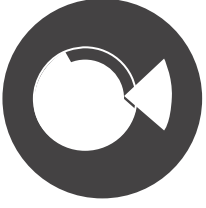

Kabuk soyulma, ham dövme bir boşluğun işleme yoluyla cilalı bir çubuğa dönüştürüldüğü işlemdir. Bu soyulma süreci sırasında yüzey çatlakları ve oksit tabakaları giderilir, böylece çubuğa mükemmel bir yuvarlaklık kazandırılır ve iyi bir yüzey ve boyut hassasiyeti sağlanır. Bu araçlarla işlenebilen malzemelerin yelpazesi geniştir ve tüm çeşitli çelik türlerinden dökme demir parçalara kadar uzanır.

*Bar peeling is the machining process by which a raw forged blank is converted into a polished bar. During this peeling process, surface cracks and oxide layers are removed giving a perfect roundness with good surface and dimensional accuracy to the bar. The range of materials that can be machined with these tools is vast and goes from all kind of steels to cast iron parts.*

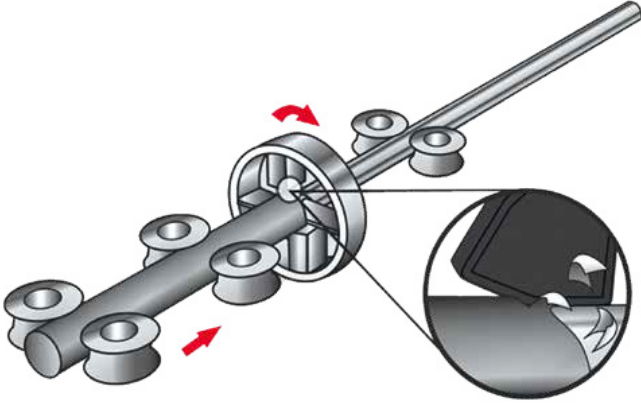

İşlenmemiş çubuğun çapı 4mm'den başlayıp 400 mm'in üzerine çıkabilir.

*The size of blank bar can go from 4 mm (157 inch) to over 400 mm (15.75 inch) in diameter.*

Yüzey kalitesi ve boyutsal toleranslar da yüksektir, bu da daha sonraki aşamalarda daha az işleme gereksinimi doğurur.

*The surface quality and dimensional tolerances are also high, which leads to less machining at later stages.*

Amacımız, aynı zamanda üretkenliğinizi artırmak (maksimum talaş hacmini kaldırarak) ve aynı zamanda yüzey kalite gereksinimlerinizi karşılamak veya aşmaktır. Bu nedenle bar soyulma programımız, her müşteri ihtiyacına özel standart araçları ve aynı zamanda özel özel çözümleri içeren geniş bir yelpazeyi kapsar.

Bu broşür, üretim olanaklarımızın sadece küçük bir bölümünü içermektedir. Lütfen bu broşürde sunulmayan diğer olası geometrilerle ilgili olarak bizimle iletişime geçmekten çekinmeyin.

*Our aim is at the same time improving your productivity (by removing maximal chips volume) and at the same time attending or surpassing your surface quality requirements. This is why our bar peeling program is vast comprising both standard tools and also special custom-made solutions to every customer needs. This flyer has only a small portion of our possible range of production. Please don't hesitate to contact us regarding other possible geometries that we may have although not presented in this brochure.*

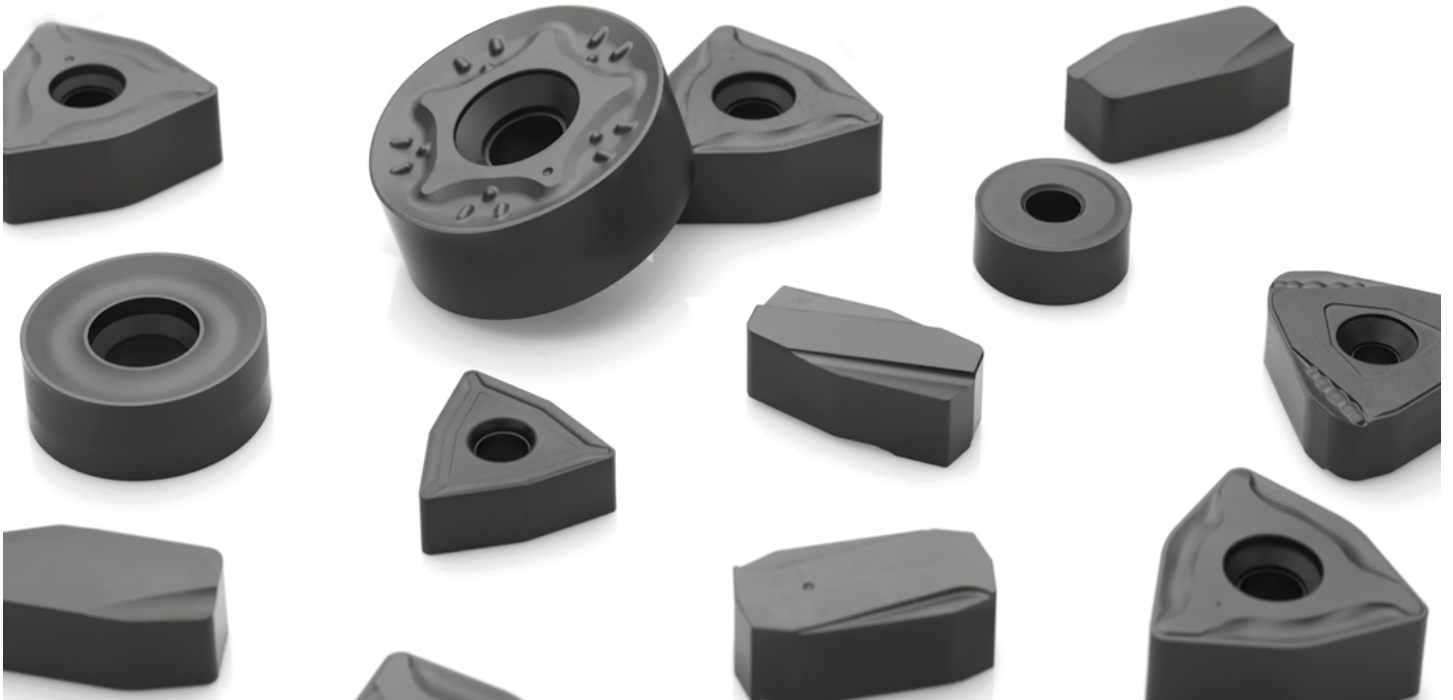

# KABUK SOYMA UÇLARI

## BAR PEELING INSERT



KOD ANAHTAR  
CODE KEY

|          |          |          |          |           |           |           |   |           |
|----------|----------|----------|----------|-----------|-----------|-----------|---|-----------|
| <b>L</b> | <b>N</b> | <b>G</b> | <b>F</b> | <b>20</b> | <b>10</b> | <b>35</b> | - | <b>PM</b> |
| <b>1</b> | <b>2</b> | <b>3</b> | <b>4</b> | <b>5</b>  | <b>6</b>  | <b>7</b>  |   | <b>8</b>  |

| 1 - Uç Şekli / Insert Shape |          |               |               |          |
|-----------------------------|----------|---------------|---------------|----------|
|                             |          |               |               |          |
| <b>I</b>                    | <b>J</b> | <b>L</b>      | <b>R</b>      | <b>S</b> |
| 60°<br>                     |          | 75° / 80°<br> | 85° / 90°<br> |          |
| <b>T</b>                    | <b>U</b> | <b>W</b>      | <b>X</b>      |          |

| 2 - Boşluk Açısı<br>Clearance Angle |  |
|-------------------------------------|--|
| <b>N</b>                            |  |

| 5 - Kesici Kenar Uzunluğu (In)<br>Length of Cutting Edge (In) |              |
|---|--------------|
| 13 mm   | 25 mm        |
| 14 mm   | 27 mm        |
| 15 mm   | 28 mm        |
| 17 mm   | 38 mm        |
| <b>20 mm</b>  | <b>44 mm</b> |
| 22 mm   | 50 mm        |

| 3 - Tolerans / Tolerances |               |               |               |
|---------------------------|---------------|---------------|---------------|
|                           |               |               |               |
| <b>sembol<br/>symbol</b>  | <b>m (mm)</b> | <b>d (mm)</b> | <b>s (mm)</b> |
| <b>A</b>                  | ±0.005        | ±0.025        | ±0.025        |
| <b>F</b>                  | ±0.005        | ±0.013        | ±0.025        |
| <b>C</b>                  | ±0.013        | ±0.025        | ±0.025        |
| <b>H</b>                  | ±0.013        | ±0.013        | ±0.025        |
| <b>E</b>                  | ±0.025        | ±0.025        | ±0.025        |
| <b>G</b>                  | ±0.025        | ±0.025        | ±0.13         |
| <b>J</b>                  | ±0.005        | ±0.05~±0.13   | ±0.025        |
| <b>K*</b>                 | ±0.013        | ±0.05~±0.13   | ±0.025        |
| <b>L*</b>                 | ±0.025        | ±0.05~±0.13   | ±0.025        |
| <b>M*</b>                 | ±0.08~±0.20   | ±0.05~±0.13   | ±0.13         |
| <b>N*</b>                 | ±0.08~±0.20   | ±0.05~±0.13   | ±0.025        |
| <b>U*</b>                 | ±0.13~±0.38   | ±0.08~0.25    | ±0.13         |

\*Kural olarak, bu kesici uçların kenarları sinterlenmiştir. Tolerans kesici uç boyutuna göre değişir, m sınıfının doğruluğu için sağdaki tabloya bakın.  
As a rule the sides of these inserts are as sintered. Tolerance differs with insert size, for the accuracy of class m, refer to the table on the right

| 8 - Talaş Kırıcı / Chip Breaker  |           |
|--|-----------|
| Palbit geometrilerine göre talaş kırıcı<br>Chip breaker according to Palbit geometries |           |
| <b>PF</b>  | <b>HM</b> |
| <b>KF</b>  | <b>RR</b> |
| <b>PM</b>  | <b>HL</b> |

| 4 - Uç Tipi / Insert type |                          |   |  |                             |
|---------------------------|--------------------------|---|--|-----------------------------|
| <b>sembol<br/>symbol</b>  | <b>Tip<br/>Type</b>      | <b>Delik Tipi<br/>Type of hole</b>  | <b>Talaş Kırıcı<br/>Chipbreaker</b>                          | <b>Şekil<br/>Shape</b>      |
| <b>W</b>                  | Delikli<br>With hole     | Yuvarlak delik<br>Bir havşa<br>Round hole<br>one countersink<br>(40°~60°) | Talaş Kırıcı olmadan<br>Without chipbreaker                  |                             |
| <b>T</b>                  | Delikli<br>With hole     | Yuvarlak delik<br>Bir havşa<br>Round hole<br>one countersink<br>(40°~60°) | Tek taraflı<br>talaş kırıcı<br>Chipbreaker<br>on one side    |                             |
| <b>Q</b>                  | Delikli<br>With hole     | Yuvarlak delik<br>Bir havşa<br>Round hole<br>one countersink<br>(40°~60°) | Talaş Kırıcı olmadan<br>Without chipbreaker                  |                             |
| <b>U</b>                  | Delikli<br>With hole     | Yuvarlak delik<br>Bir havşa<br>Round hole<br>one countersink<br>(40°~60°) | Çift taraflı<br>talaş kırıcı<br>Chipbreaker<br>on both sides |                             |
| <b>B</b>                  | Delikli<br>With hole     | Yuvarlak delik<br>Bir havşa<br>Round hole<br>one countersink<br>(70°~90°) | Talaş Kırıcı olmadan<br>Without chipbreaker                  |                             |
| <b>H</b>                  | Delikli<br>With hole     | Yuvarlak delik<br>Bir havşa<br>Round hole<br>one countersink<br>(70°~90°) | Tek taraflı<br>talaş kırıcı<br>Chipbreaker<br>on one side    |                             |
| <b>C</b>                  | Delikli<br>With hole     | Yuvarlak delik<br>Bir havşa<br>Round hole<br>one countersink<br>(70°~90°) | Talaş Kırıcı olmadan<br>Without chipbreaker                  |                             |
| <b>J</b>                  | Delikli<br>With hole     | Yuvarlak delik<br>Bir havşa<br>Round hole<br>one countersink<br>(70°~90°) | Çift taraflı<br>talaş kırıcı<br>Chipbreaker<br>on both sides |                             |
| <b>A</b>                  | Delikli<br>With hole     | Yuvarlak delik<br>Bir havşa<br>Round hole<br>one countersink              | Talaş Kırıcı olmadan<br>Without chipbreaker                  |                             |
| <b>M</b>                  | Delikli<br>With hole     | Yuvarlak delik<br>Bir havşa<br>Round hole<br>one countersink              | Tek taraflı<br>talaş kırıcı<br>Chipbreaker<br>on one side    |                             |
| <b>G</b>                  | Delikli<br>With hole     | Yuvarlak delik<br>Bir havşa<br>Round hole<br>one countersink              | Çift taraflı<br>talaş kırıcı<br>Chipbreaker<br>on both sides |                             |
| <b>N</b>                  | Deliksiz<br>Without hole | --  | Talaş Kırıcı olmadan<br>Without chipbreaker                  |                             |
| <b>R</b>                  | Deliksiz<br>Without hole | --  | Tek taraflı<br>talaş kırıcı<br>Chipbreaker<br>on one side    |                             |
| <b>F</b>                  | Deliksiz<br>Without hole | --  | Çift taraflı<br>talaş kırıcı<br>Chipbreaker<br>on both sides |                             |
| <b>X</b>                  | -                        | -   | --   | İstek üzerine<br>On request |

| 6 - Kalınlık / Thickness (S)  |  |
|---|--|
| İkincil kesme kenarının uzunluğu mm olarak belirtilir.<br>The length of the secondary cutting edge is indicated in mm |  |
| 08 = 8,00 mm  |  |
| 09 = 9,52 mm  |  |
| <b>10 = 10,00 mm</b>  |  |
| 12 = 12,00 mm   |  |
| 12 = 12,70 mm   |  |
| 13 = 13,00 mm   |  |
| 14 = 14,00 mm   |  |
| 18 = 18,00 mm   |  |

| 7 - Talaş Derinliği<br>Depth of Cut (ap)         |  |
|--|--|
| Maksimum kesme derinliği<br>Maximum depth of cut |  |
| 20 = 2,00 mm                                     |  |
| 25 = 2,50 mm                                     |  |
| <b>35 = 3,50 mm</b>                              |  |
| 40 = 4,00 mm                                     |  |
| 80 = 8,00 mm                                     |  |

# KABUK SOYMA UÇLARI

## BAR PEELING INSERT

### Uç Çeşitleri

#### Inserts Range

### INGR Dikdörtgen 90° Negatif

#### INGR Rectangular 90° Negative

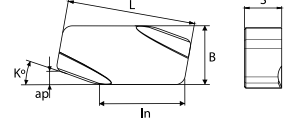

|   | Kalite Kodu<br>Grade Code        |                                    | P       |         | M      |         | K       |       | Boyut<br>Dimensions<br>(mm) |      |       |      |       |            | Kesme Koşulları<br>Cutting Conditions |      |              |      |      |
|---|----------------------------------|------------------------------------|---------|---------|--------|---------|---------|-------|-----------------------------|------|-------|------|-------|------------|---------------------------------------|------|--------------|------|------|
|   |                                  |                                    | L7      | L8      | L8     | P1      | L6      |       |                             |      |       |      |       |            |                                       |      |              |      |      |
|   | ISO Referans<br>ISO<br>Reference | ANSI Referans<br>ANSI<br>Reference | TCT115P | TCT125P | TCT125 | TCT228P | TCT220P | L     | In                          | B    | S     | ap   | K     | ap<br>(mm) | Min                                   | Max  | fn<br>(mm/r) | Min  | Max  |
|  | INGR 221240-PM                   | INGR 221240-PM                     | ☉       | ○       | ○      | ○       | ○       | 38,25 | 22,00                       | 17,5 | 12,00 | 4,00 | 20,00 | 2,00       | 0,40                                  | 4,00 | 3,50         | 1,00 | 8,00 |

☉ Stok Var-İlk Tercih  
Stock Item-First Choice

☉ Stok Var  
Stock Item

○ Talep üzerine mevcuttur  
Available under request

### JNGF Dikdörtgen 90° Negatif

#### JNGF Rectangular 90° Negative

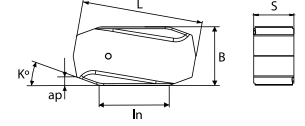

|   | Kalite Kodu<br>Grade Code        |                                    | P       |         | M      |         | K       |       | Boyut<br>Dimensions<br>(mm) |       |       |      |    |            | Kesme Koşulları<br>Cutting Conditions |      |              |      |      |
|---|----------------------------------|------------------------------------|---------|---------|--------|---------|---------|-------|-----------------------------|-------|-------|------|----|------------|---------------------------------------|------|--------------|------|------|
|   |                                  |                                    | L7      | L8      | L8     | P1      | L6      |       |                             |       |       |      |    |            |                                       |      |              |      |      |
|   | ISO Referans<br>ISO<br>Reference | ANSI Referans<br>ANSI<br>Reference | TCT115P | TCT125P | TCT125 | TCT228P | TCT220P | L     | In                          | B     | S     | ap   | K  | ap<br>(mm) | Min                                   | Max  | fn<br>(mm/r) | Min  | Max  |
|  | JNGF 201220-PM                   | JNGF 201220-PM                     | ○       | ☉       | ☉      |         |         | 36,90 | 20,00                       | 18,00 | 12,35 | 2,00 | 20 | 1,50       | 1,00                                  | 2,00 | 3,50         | 1,50 | 6,00 |
|   | JNGF 201220-PM SP1               | JNGF 201220-PM SP1                 | ○       |         |        |         |         | 36,30 | 20,00                       | 18,00 | 12,45 | 2,00 | 20 | 1,50       | 1,00                                  | 2,00 | 3,50         | 1,50 | 6,00 |
|   | JNGF 201220-PM SP2               | JNGF 201220-PM SP2                 | ☉       | ☉       | ☉      |         |         | 36,50 | 20,00                       | 18,00 | 12,45 | 2,00 | 20 | 1,50       | 1,00                                  | 2,00 | 3,50         | 1,50 | 6,00 |
|   | JNGF 271220-PM                   | JNGF 271220-PM                     | ○       |         |        |         |         | 36,90 | 27,00                       | 18,00 | 12,45 | 2,00 | 20 | 1,50       | 1,00                                  | 2,00 | 3,50         | 1,50 | 6,00 |

☉ Stok Var-İlk Tercih  
Stock Item-First Choice

☉ Stok Var  
Stock Item

○ Talep üzerine mevcuttur  
Available under request

### LNGF Dikdörtgen 90° Negatif

#### LNGF Rectangular 90° Negative

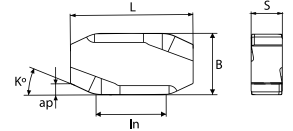

|   | Kalite Kodu<br>Grade Code        |                                    | P       |         | M      |         | K       |       | Boyut<br>Dimensions<br>(mm) |       |       |      |    |            | Kesme Koşulları<br>Cutting Conditions |      |              |      |      |
|---|----------------------------------|------------------------------------|---------|---------|--------|---------|---------|-------|-----------------------------|-------|-------|------|----|------------|---------------------------------------|------|--------------|------|------|
|   |                                  |                                    | L7      | L8      | L8     | P1      | L6      |       |                             |       |       |      |    |            |                                       |      |              |      |      |
|   | ISO Referans<br>ISO<br>Reference | ANSI Referans<br>ANSI<br>Reference | TCT115P | TCT125P | TCT125 | TCT228P | TCT220P | L     | In                          | B     | S     | ap   | K  | ap<br>(mm) | Min                                   | Max  | fn<br>(mm/r) | Min  | Max  |
|  | LNGF 201035-PM                   | LNGF 201035-PM                     | ☉       | ○       | ○      | ○       | ○       | 40,00 | 20,00                       | 20,00 | 10,00 | 3,50 | 25 | 2,00       | 0,80                                  | 3,50 | 2,50         | 1,00 | 6,50 |
|   | LNGF 201235-PM                   | LNGF 201235-PM                     | ☉       | ○       | ○      | ○       | ○       | 40,00 | 20,00                       | 20,00 | 12,00 | 3,50 | 25 | 2,00       | 0,80                                  | 3,50 | 2,50         | 1,00 | 6,50 |

☉ Stok Var-İlk Tercih  
Stock Item-First Choice

☉ Stok Var  
Stock Item

○ Talep üzerine mevcuttur  
Available under request

# KABUK SOYMA UÇLARI

## BAR PEELING INSERT

### Uç Çeşitleri

#### Inserts Range

### UNGF Dikdörtgen 90° Negatif

#### UNGF Rectangular 90° Negative

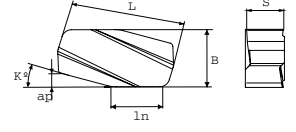

|  | Kalite Kodu<br>Grade Code | ISO Referans<br>ISO Reference | ANSI Referans<br>ANSI Reference | P       |         |        |         |         | M       |         |        |         |         | K       |         |        |         |         | Boyut<br>Dimensions<br>(mm) |      |    |      |      |      | Kesme Koşulları<br>Cutting Conditions |      |      |              |     |     |
|--|---------------------------|-------------------------------|---------------------------------|---------|---------|--------|---------|---------|---------|---------|--------|---------|---------|---------|---------|--------|---------|---------|-----------------------------|------|----|------|------|------|---------------------------------------|------|------|--------------|-----|-----|
|  |                           |                               |                                 | L7      | L8      | L8     | P1      | L6      | L7      | L8      | L8     | P1      | L6      | L7      | L8      | L8     | P1      | L6      | L                           | Ln   | B  | S    | ap   | K    | ap<br>(mm)                            | Min  | Max  | fn<br>(mm/r) | Min | Max |
|  |                           |                               |                                 | TCT115P | TCT125P | TCT125 | TCT228P | TCT220P | TCT115P | TCT125P | TCT125 | TCT228P | TCT220P | TCT115P | TCT125P | TCT125 | TCT228P | TCT220P | L                           | Ln   | B  | S    | ap   | K    | ap<br>(mm)                            | Min  | Max  | fn<br>(mm/r) | Min | Max |
|  | UNGF 171240-PM            | UNGF 171240-PM                |                                 |         |         |        |         |         |         |         |        |         |         |         |         | 36,50  | 17,00   | 18,00   | 12,00                       | 4,00 | 15 | 1,50 | 0,35 | 4,00 | 2,00                                  | 1,00 | 5,00 |              |     |     |

Stok Var-İlk Tercih  
Stock Item-First Choice

Stok Var  
Stock Item

Talep üzerine mevcuttur  
Available under request

### TNMJ Üçgenel 60° Negatif

#### TNMJ Triangular 60° Negative

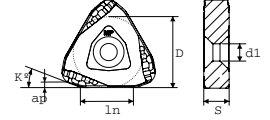

|  | Kalite Kodu<br>Grade Code | ISO Referans<br>ISO Reference | ANSI Referans<br>ANSI Reference | P       |         |        |         |         | M       |         |        |         |         | K       |         |        |         |         | Boyut<br>Dimensions<br>(mm) |      |    |      |      |      | Kesme Koşulları<br>Cutting Conditions |      |      |              |     |     |
|--|---------------------------|-------------------------------|---------------------------------|---------|---------|--------|---------|---------|---------|---------|--------|---------|---------|---------|---------|--------|---------|---------|-----------------------------|------|----|------|------|------|---------------------------------------|------|------|--------------|-----|-----|
|  |                           |                               |                                 | L7      | L8      | L8     | P1      | L6      | L7      | L8      | L8     | P1      | L6      | L7      | L8      | L8     | P1      | L6      | L                           | Ln   | B  | S    | ap   | K    | ap<br>(mm)                            | Min  | Max  | fn<br>(mm/r) | Min | Max |
|  |                           |                               |                                 | TCT115P | TCT125P | TCT125 | TCT228P | TCT220P | TCT115P | TCT125P | TCT125 | TCT228P | TCT220P | TCT115P | TCT125P | TCT125 | TCT228P | TCT220P | L                           | Ln   | B  | S    | ap   | K    | ap<br>(mm)                            | Min  | Max  | fn<br>(mm/r) | Min | Max |
|  | TNMJ 201025-PM            | TNMJ 201025-PM                |                                 |         |         |        |         |         |         |         |        |         |         |         |         | 28,60  | 20,00   | 10,00   | 7,00                        | 2,50 | 20 | 1,00 | 0,70 | 2,50 | 3,00                                  | 1,00 | 5,50 |              |     |     |
|  | TNMJ 201425-PM            | TNMH 2015425-PM               |                                 |         |         |        |         |         |         |         |        |         |         |         |         | 28,60  | 20,00   | 14,00   | 7,00                        | 2,50 | 20 | 1,00 | 0,70 | 2,50 | 3,00                                  | 1,00 | 5,50 |              |     |     |

Stok Var-İlk Tercih  
Stock Item-First Choice

Stok Var  
Stock Item

Talep üzerine mevcuttur  
Available under request

### TNGM Üçgenel 60° Negatif

#### TNGM Triangular 60° Negative

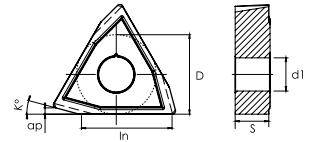

|  | Kalite Kodu<br>Grade Code | ISO Referans<br>ISO Reference | ANSI Referans<br>ANSI Reference | P       |         |        |         |         | M       |         |        |         |         | K       |         |        |         |         | Boyut<br>Dimensions<br>(mm) |      |    |      |      |      | Kesme Koşulları<br>Cutting Conditions |      |       |              |     |     |
|--|---------------------------|-------------------------------|---------------------------------|---------|---------|--------|---------|---------|---------|---------|--------|---------|---------|---------|---------|--------|---------|---------|-----------------------------|------|----|------|------|------|---------------------------------------|------|-------|--------------|-----|-----|
|  |                           |                               |                                 | L7      | L8      | L8     | P1      | L6      | L7      | L8      | L8     | P1      | L6      | L7      | L8      | L8     | P1      | L6      | L                           | Ln   | B  | S    | ap   | K    | ap<br>(mm)                            | Min  | Max   | fn<br>(mm/r) | Min | Max |
|  |                           |                               |                                 | TCT115P | TCT125P | TCT125 | TCT228P | TCT220P | TCT115P | TCT125P | TCT125 | TCT228P | TCT220P | TCT115P | TCT125P | TCT125 | TCT228P | TCT220P | L                           | Ln   | B  | S    | ap   | K    | ap<br>(mm)                            | Min  | Max   | fn<br>(mm/r) | Min | Max |
|  | TNGM 220812-PM            | TNGM 220812-PM                |                                 |         |         |        |         |         |         |         |        |         |         |         |         | 19,05  | 22,00   | 8,00    | 7,96                        | 1,20 | 15 | 0,70 | 0,20 | 1,30 | 14,00                                 | 5,00 | 18,00 |              |     |     |

Stok Var-İlk Tercih  
Stock Item-First Choice

Stok Var  
Stock Item

Talep üzerine mevcuttur  
Available under request

# KABUK SOYMA UÇLARI

## BAR PEELING INSERT

### Uç Çeşitleri

#### Inserts Range

#### TNMM Üçgenel 60° Negatif

#### TNMM Triangular 60° Negative

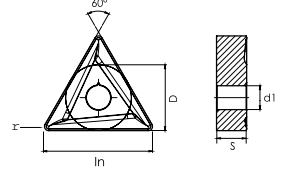

|  | Kalite Kodu<br>Grade Code | ISO Referans<br>ISO<br>Reference | ANSI Referans<br>ANSI<br>Reference | P                                |                                  | M                     |                       | K                     |                       | Boyut<br>Dimensions<br>(mm) |       |       |      |      |            | Kesme Koşulları<br>Cutting Conditions |      |              |      |      |      |
|--|---------------------------|----------------------------------|------------------------------------|----------------------------------|----------------------------------|-----------------------|-----------------------|-----------------------|-----------------------|-----------------------------|-------|-------|------|------|------------|---------------------------------------|------|--------------|------|------|------|
|  |                           |                                  |                                    | L7                               | L8                               | L8                    | P1                    | L6                    | L                     | In                          | B     | S     | ap   | K    | ap<br>(mm) | Min                                   | Max  | fn<br>(mm/r) | Min  | Max  |      |
|  |                           |                                  |                                    | TCT115P                          | TCT125P                          | TCT125                | TCT228P               | TCT220P               |                       |                             |       |       |      |      |            |                                       |      |              |      |      |      |
|  | TNMM 441116-HL            | TNMM 441116-HL                   | <input type="radio"/>              | <input checked="" type="radio"/> | <input checked="" type="radio"/> | <input type="radio"/> | <input type="radio"/> | <input type="radio"/> | <input type="radio"/> | 25,40                       | 44,00 | 11,35 | 9,20 | 1,60 | -          | 12,00                                 | 2,00 | 25,00        | 0,80 | 0,50 | 1,60 |

Stok Var-İlk Tercih  
Stock Item-First Choice

Stok Var  
Stock Item

Talep üzerine mevcuttur  
Available under request

#### XNGF Özel 85° Negatif

#### XNGF Special 85° Negative

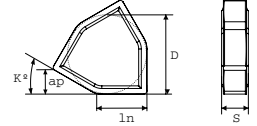

|  | Kalite Kodu<br>Grade Code | ISO Referans<br>ISO<br>Reference | ANSI Referans<br>ANSI<br>Reference | P                     |                       | M                                |                       | K                     |                       | Boyut<br>Dimensions<br>(mm) |       |      |    |      |            | Kesme Koşulları<br>Cutting Conditions |      |              |      |      |       |
|--|---------------------------|----------------------------------|------------------------------------|-----------------------|-----------------------|----------------------------------|-----------------------|-----------------------|-----------------------|-----------------------------|-------|------|----|------|------------|---------------------------------------|------|--------------|------|------|-------|
|  |                           |                                  |                                    | L7                    | L8                    | L8                               | P1                    | L6                    | L                     | In                          | B     | S    | ap | K    | ap<br>(mm) | Min                                   | Max  | fn<br>(mm/r) | Min  | Max  |       |
|  |                           |                                  |                                    | TCT115P               | TCT125P               | TCT125                           | TCT228P               | TCT220P               |                       |                             |       |      |    |      |            |                                       |      |              |      |      |       |
|  | XNGF 150980-PF            | XNGF 150980-PF                   | <input type="radio"/>              | <input type="radio"/> | <input type="radio"/> | <input checked="" type="radio"/> | <input type="radio"/> | <input type="radio"/> | <input type="radio"/> | 28,58                       | 15,00 | 8,88 | -  | 8,00 | 30         | 3,00                                  | 1,00 | 4,50         | 6,00 | 4,00 | 12,00 |

Stok Var-İlk Tercih  
Stock Item-First Choice

Stok Var  
Stock Item

Talep üzerine mevcuttur  
Available under request

#### XNMJ Özel 85° Negatif

#### XNMJ Special 85° Negative

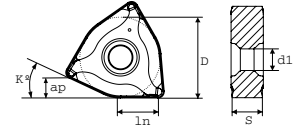

|  | Kalite Kodu<br>Grade Code | ISO Referans<br>ISO<br>Reference | ANSI Referans<br>ANSI<br>Reference | P                                |                                  | M                                |                       | K                     |                       | Boyut<br>Dimensions<br>(mm) |       |       |      |      |            | Kesme Koşulları<br>Cutting Conditions |      |              |      |      |       |
|--|---------------------------|----------------------------------|------------------------------------|----------------------------------|----------------------------------|----------------------------------|-----------------------|-----------------------|-----------------------|-----------------------------|-------|-------|------|------|------------|---------------------------------------|------|--------------|------|------|-------|
|  |                           |                                  |                                    | L7                               | L8                               | L8                               | P1                    | L6                    | L                     | In                          | B     | S     | ap   | K    | ap<br>(mm) | Min                                   | Max  | fn<br>(mm/r) | Min  | Max  |       |
|  |                           |                                  |                                    | TCT115P                          | TCT125P                          | TCT125                           | TCT228P               | TCT220P               |                       |                             |       |       |      |      |            |                                       |      |              |      |      |       |
|  | XNMJ 151380-PM            | XNMJ 151380-PM                   | <input type="radio"/>              | <input checked="" type="radio"/> | <input checked="" type="radio"/> | <input checked="" type="radio"/> | <input type="radio"/> | <input type="radio"/> | <input type="radio"/> | 31,75                       | 15,00 | 13,00 | 9,00 | 8,00 | 25         | 3,00                                  | 1,00 | 6,50         | 6,00 | 4,00 | 12,00 |
|  | XNMJ 151380-HM            | XNMJ 151380-HM                   | <input type="radio"/>              | <input checked="" type="radio"/> | <input checked="" type="radio"/> | <input checked="" type="radio"/> | <input type="radio"/> | <input type="radio"/> | <input type="radio"/> | 31,75                       | 15,00 | 13,00 | 9,00 | 8,00 | 25         | 3,00                                  | 1,00 | 6,50         | 6,00 | 4,00 | 12,00 |

Stok Var-İlk Tercih  
Stock Item-First Choice

Stok Var  
Stock Item

Talep üzerine mevcuttur  
Available under request

# KABUK SOYMA UÇLARI

## BAR PEELING INSERT

### Uç Çeşitleri

#### Inserts Range

#### XNGJ Özel 85° Negatif

#### XNGJ Special 85° Negative

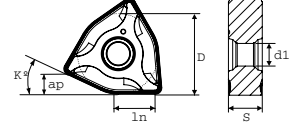

|  | Kalite Kodu<br>Grade Code        |                                    | P       |         | M      |         | K       |       | Boyut<br>Dimensions<br>(mm) |       |      |      |    | Kesme Koşulları<br>Cutting Conditions |      |      |              |      |       |
|--|----------------------------------|------------------------------------|---------|---------|--------|---------|---------|-------|-----------------------------|-------|------|------|----|---------------------------------------|------|------|--------------|------|-------|
|  |                                  |                                    | L7      | L8      | L8     | P1      | L6      |       |                             |       |      |      |    |                                       |      |      |              |      |       |
|  | ISO Referans<br>ISO<br>Reference | ANSI Referans<br>ANSI<br>Reference | TCT115P | TCT125P | TCT125 | TCT228P | TCT220P | L     | ln                          | B     | S    | ap   | K  | ap<br>(mm)                            | Min  | Max  | fn<br>(mm/r) | Min  | Max   |
|  | XNGJ 151380-RR                   | XNGJ 151380-RR                     | ○       | ○       | ○      | ⊗       | ○       | 31,75 | 15,00                       | 13,00 | 9,00 | 8,00 | 25 | 3,00                                  | 1,00 | 6,50 | 6,00         | 4,00 | 12,00 |

⊗ Stok Var-İlk Tercih  
Stock Item-First Choice

⊗ Stok Var  
Stock Item

○ Talep üzerine mevcuttur  
Available under request

#### WNGJ Özel 75° Negatif

#### WNGJ Special 75° Negative

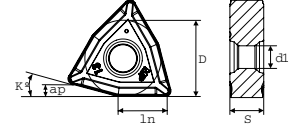

|  | Kalite Kodu<br>Grade Code        |                                    | P       |         | M      |         | K       |       | Boyut<br>Dimensions<br>(mm) |      |      |      |    | Kesme Koşulları<br>Cutting Conditions |      |      |              |      |       |
|--|----------------------------------|------------------------------------|---------|---------|--------|---------|---------|-------|-----------------------------|------|------|------|----|---------------------------------------|------|------|--------------|------|-------|
|  |                                  |                                    | L7      | L8      | L8     | P1      | L6      |       |                             |      |      |      |    |                                       |      |      |              |      |       |
|  | ISO Referans<br>ISO<br>Reference | ANSI Referans<br>ANSI<br>Reference | TCT115P | TCT125P | TCT125 | TCT228P | TCT220P | L     | ln                          | B    | S    | ap   | K  | ap<br>(mm)                            | Min  | Max  | fn<br>(mm/r) | Min  | Max   |
|  | WNGJ 130950-PM                   | WNGJ 130950-PM                     | ○       | ⊗       | ⊗      | ⊗       | ⊗       | 22,23 | 13,00                       | 9,56 | 7,93 | 5,00 | 15 | 3,00                                  | 0,50 | 5,00 | 6,00         | 3,00 | 11,00 |

⊗ Stok Var-İlk Tercih  
Stock Item-First Choice

⊗ Stok Var  
Stock Item

○ Talep üzerine mevcuttur  
Available under request

#### RNMX Yuvarlak R° Negatif

#### RNMX Round R° Negative

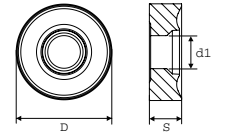

|  | Kalite Kodu<br>Grade Code        |                                    | P       |         | M      |         | K       |       | Boyut<br>Dimensions<br>(mm) |       |       |    |   | Kesme Koşulları<br>Cutting Conditions |      |       |              |      |       |
|--|----------------------------------|------------------------------------|---------|---------|--------|---------|---------|-------|-----------------------------|-------|-------|----|---|---------------------------------------|------|-------|--------------|------|-------|
|  |                                  |                                    | L7      | L8      | L8     | P1      | L6      |       |                             |       |       |    |   |                                       |      |       |              |      |       |
|  | ISO Referans<br>ISO<br>Reference | ANSI Referans<br>ANSI<br>Reference | TCT115P | TCT125P | TCT125 | TCT228P | TCT220P | L     | ln                          | B     | S     | ap | K | ap<br>(mm)                            | Min  | Max   | fn<br>(mm/r) | Min  | Max   |
|  | RNMX 318200-PM                   | RNMX 381200-PM                     | ○       | ○       | ○      | ⊗       | ○       | 38,10 | -                           | 12,70 | 13,00 | -  | - | 4,00                                  | 2,00 | 8,00  | 2,00         | 1,00 | 4,00  |
|  | RNMX 5018MO-PM                   | RNMX 5018MO-PM                     | ○       | ○       | ○      | ⊗       | ○       | 50,00 | -                           | 18,00 | 12,70 | -  | - | 6,00                                  | 2,00 | 12,00 | 3,50         | 2,50 | 6,50  |
|  | RNMX 5018MO-RR                   | RNMX 5018MO-RR                     | ○       | ○       | ○      | ⊗       | ○       | 5,00  | -                           | 18,00 | 12,70 | -  | - | 6,00                                  | 2,00 | 12,00 | 6,00         | 4,00 | 10,50 |

⊗ Stok Var-İlk Tercih  
Stock Item-First Choice

⊗ Stok Var  
Stock Item

○ Talep üzerine mevcuttur  
Available under request

# KABUK SOYMA UÇLARI

## BAR PEELING INSERT

### Uç Çeşitleri

#### Inserts Range

 **RNMG Round R° Negatif**  
**RNMG Yuvarlak R° Negatif**

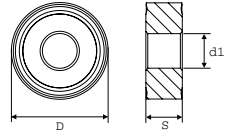

|   | Kalite Kodu<br>Grade Code        |                                    | P                     |                       | M                     |                       | K                                |   | Boyut<br>Dimensions<br>(mm) |   |      |      |   |            | Kesme Koşulları<br>Cutting Conditions |      |              |      |      |      |
|---|----------------------------------|------------------------------------|-----------------------|-----------------------|-----------------------|-----------------------|----------------------------------|---|-----------------------------|---|------|------|---|------------|---------------------------------------|------|--------------|------|------|------|
|   |                                  |                                    | L7                    | L8                    | L8                    | P1                    | L6                               | L | In                          | B | S    | ap   | K | ap<br>(mm) | Min                                   | Max  | fn<br>(mm/r) | Min  | Max  |      |
|   | ISO Referans<br>ISO<br>Reference | ANSI Referans<br>ANSI<br>Reference | TCT115P               | TCT125P               | TCT125                | TCT228P               | TCT220P                          |   |                             |   |      |      |   |            |                                       |      |              |      |      |      |
|  | RNMG 250900-KF                   | RNMG 860-KF                        | <input type="radio"/> | <input type="radio"/> | <input type="radio"/> | <input type="radio"/> | <input checked="" type="radio"/> |   | 25,40                       | - | 9,52 | 9,12 | - | -          | 5,00                                  | 2,50 | 10,00        | 1,00 | 0,25 | 2,50 |

 **Stok Var-İlk Tercih**  
**Stock Item-First Choice**

 **Stok Var**  
**Stock Item**

**Talep üzerine mevcuttur**  
**Available under request**





**[www.euroloy.com](http://www.euroloy.com)**

**Head Office - Via Leonardo Da Vinci, 4  
- 20054, Segrate  
Milano MI ITALIA**

**Euroloy Italia (+39) 0282398309  
Euroloy Turkey (+90) 850 933 3408**

**✉ [info@euroloy.com](mailto:info@euroloy.com)**

**📷 [@euroloytools](https://www.instagram.com/euroloytools)**