

2023/09-1



EURLEY

KARBÜR TAKIMLAR

CARBIDE TOOLS



KARBÜR FREZE KODLAMA SİSTEMİ

CARBIDE ENDMILL CODING SYSTEM

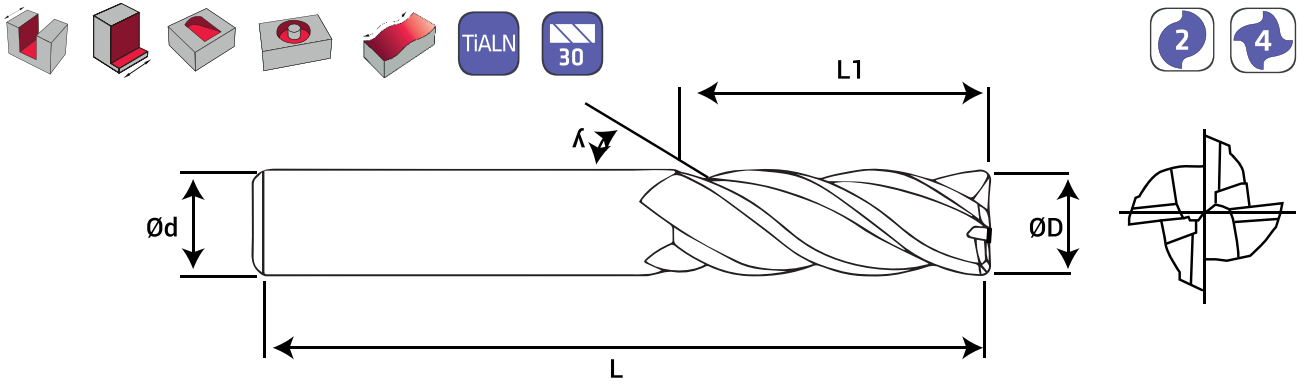
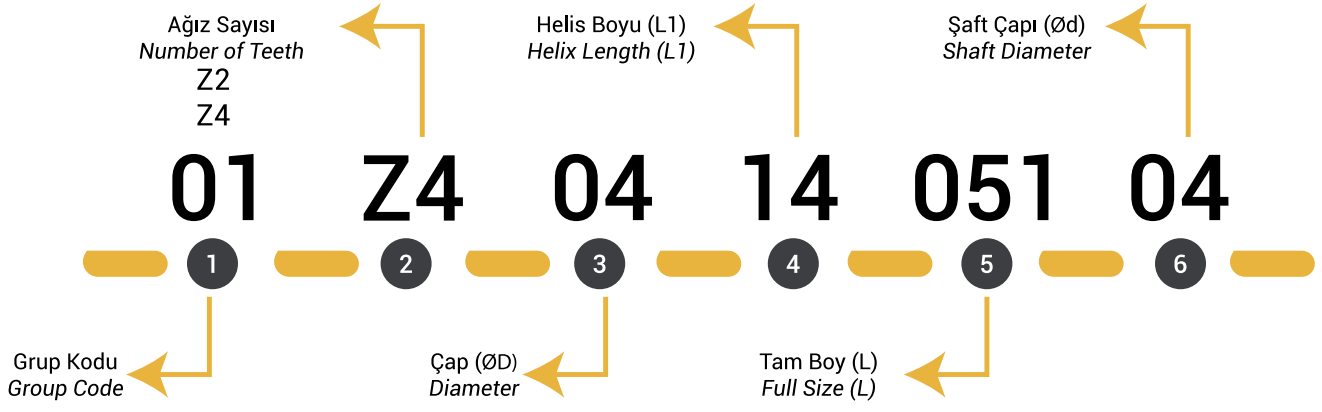

Grup Kodu / Group Code

01 Z4 04 14 051 04

- | | | | | | |
|----|--|----|--|----|--|
| 01 | Karbür Düz Freze (45HRC)
Flat Carbide Endmill (45HRC) | 02 | Karbür Uzun Düz Freze (45HRC)
Long Flat Carbide Endmill (45HRC) | 03 | Karbür Küre Freze (45HRC & 60HRC)
Ball Nose Carbide Endmill (45HRC & 60HRC) |
| 04 | Karbür Uzun Küre Freze (45HRC & 60HRC)
Ball Nose Long Carbide Endmill (45HRC & 60HRC) | 05 | Karbür Pirr Freze (60HRC)
Carbide Pirr Endmill (60HRC) | 06 | Karbür Köşe Radyüs Freze (55≤HRC)
Corner Radius Carbide Endmill (55≤HRC) |
| 07 | Karbür Köşe Radyüs Uzun Freze (55≤HRC)
Corner Radius Long Carbide Endmill (55≤HRC) | 08 | Karbür Alüminyum Finiş Freze
Carbide Aluminium Finishing Endmill | 09 | Karbür Alüminyum Uzun Finiş Freze
Long Carbide Aluminium Finishing Endmill |
| 10 | Karbür Alüminyum Performans Freze
Carbide Aluminium Performance Endmill | 11 | Karbür Alüminyum Uzun Performans Freze
Long Carbide Aluminium Performance Endmill | 12 | Karbür Alüminyum Küre Freze
Ball Nose Carbide Aluminium Endmill |
| 13 | Karbür Alüminyum Uzun Küre Freze
Ball Nose Long Carbide Aluminium Endmill | 14 | Karbür Kaba Talaş Freze
Ball Roughing Endmill | 15 | Karbür Uzun Kaba Talaş Freze
Long Roughing Endmill |
| 16 | Karbür Finiş Freze Z6
Carbide Finishing Endmill Z6 | 17 | Karbür Uzun Finiş Freze Z6
Long Carbide Finishing Endmill Z6 | 18 | Karbür Finiş Freze Z8
Carbide Finishing Endmill Z8 |
| 19 | Karbür Uzun Finiş Freze Z8
Long Carbide Finishing Endmill Z8 | 20 | Karbür Konik Düz Ağızlı Freze
Tapered Flat Carbide Endmill | 21 | Karbür Konik Küre Ağızlı Freze
Tapered Ball Nose Carbide Endmill |
| 22 | Karbür İç Bükey Freze
Carbide Rounding Concave Cutter | 25 | 3D Karbür Matkap
3D Carbide Drill | 26 | 5D Karbür Matkap
5D Carbide Drill |
| | Karbür Ekstra Uzun Matkap
Extra Long Carbide Drill | 29 | Karbür Helis Raybalar
Carbide Helic Reamers | | |

01

KARBÜR DÜZ FREZE (45HRC)

FLAT CARBIDE ENDMILL (45HRC)

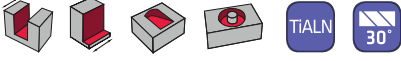
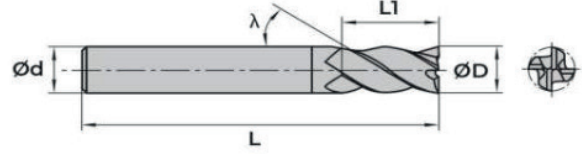

ØD(mm)	L1(mm)	L(mm)	Ød(mm)	Euroloy Kod Euroloy Code	Euroloy Kod Euroloy Code
3	12	50	3	01Z2031205003	01Z4031205003
4	14	51	4	01Z2041405104	01Z4041405104
5	16	51	5	01Z2051605105	01Z4051605105
6	19	58	6	01Z2061905806	01Z4061905806
8	20	64	8	01Z2082006408	01Z4082006408
10	21	73	10	01Z2102107310	01Z4102107310
12	25	84	12	01Z2122508412	01Z4122508412
14	32	84	14	01Z2143208414	01Z4143208414
16	32	93	16	01Z2163209316	01Z4163209316
18	35	93	18	01Z2183509318	01Z4183509318
20	38	100	20	01Z2203810020	01Z4203810020

Uygulama Application

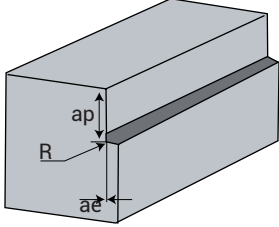

Dik kenar frezeleme derinliği (ap)
ve radyal derinlik (ae)
Shoulder milling depth (ap)
and radial depth (ae)

ap: $\leq 1.5D$ (Tüm çaplar)
ae: $\leq 0.1D$ ($D \leq \emptyset 3$)
 $\leq 0.2D$ ($D > \emptyset 3$)

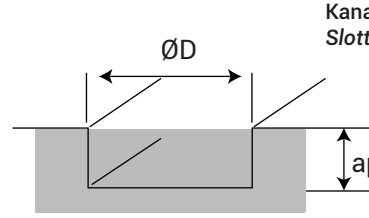

Kanal işleme derinliği (ap)
Slotting processing depth (ap)

ap: $\leq 0.1D$ ($D \leq \emptyset 2$)
 $\leq 0.2D$ ($D > \emptyset 2$)

(Hrc 38~Hrc 45)		2		4	
Dış Çap Out Dia.	Devir (dk-1) RPM (min-1)	Dik Kenar Frezeleme Shouldering MM/DK	Kanal Açma Slotting	Dik Kenar Frezeleme Shouldering MM/DK	Kanal Açma Slotting
2,0	15,000	600	480	900	720
2,5	12,000	600	480	900	720
3,0	10,000	600	480	900	720
4,0	7,500	600	480	900	720
5,0	6,000	600	480	900	720
6,0	5,000	600	480	900	720
8,0	4,000	520	410	780	620
10,0	3,200	450	360	680	540
12,0	2,700	410	320	620	490
16,0	2,000	240	190	360	280
20,0	1,600	200	160	360	240

02

KARBÜR UZUN DÜZ FREZE (45HRC)

LONG FLAT CARBIDE ENDMILL (45HRC)

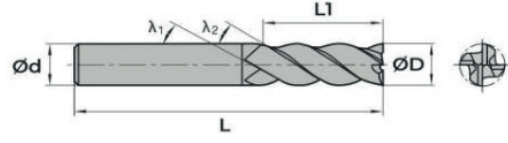

ØD(mm)	L1(mm)	L(mm)	Ød(mm)	Euroloy Kod Euroloy Code	Euroloy Kod Euroloy Code
3	20	75	3	02Z2032007503	02Z4032007503
4	20	75	4	02Z2042007504	02Z4042007504
5	25	75	5	02Z2052507505	02Z4052507505
6	25	75	6	02Z2062507506	02Z4062507506
8	30	75	8	02Z2083007508	02Z4083007508
3	20	100	3	02Z2032010003	02Z4032010003
4	20	100	4	02Z2042010004	02Z4042010004
5	25	100	5	02Z2052510005	02Z4052510005
6	30	100	6	02Z2063010006	02Z4063010006
8	30	100	8	02Z2083010008	02Z4083010008
10	45	100	10	02Z2104510010	02Z4104510010
12	45	100	12	02Z2124510012	02Z4124510012
14	45	100	14	02Z2144510014	02Z4144510014
16	45	100	16	02Z2164510016	02Z4164510016
18	45	100	18	02Z2184510020	02Z4184510020
20	45	100	20	02Z22045100220	02Z42045100220
8	65	150	8	02Z2086515008	02Z4086515008
10	65	150	10	02Z2106515010	02Z4106515010
12	65	150	12	02Z2126515012	02Z4126515012
14	65	150	14	02Z2146515014	02Z4146515014
16	75	150	16	02Z2167515016	02Z4167515016
18	75	150	18	02Z2187515018	02Z42187515018
20	75	150	20	02Z2207515020	02Z4207515020
8	65	150	8	02Z2086515008	02Z4086515008
10	65	150	10	02Z2106515010	02Z4106515010
12	65	150	12	02Z2126515012	02Z4126515012
14	65	150	14	02Z2146515014	02Z4146515014
16	75	150	16	02Z2167515016	02Z4167515016
18	75	150	18	02Z2187515018	02Z4187515018
20	75	150	20	02Z2207515020	02Z4207515020

02

KARBÜR UZUN DÜZ FREZE (45HRC)

LONG FLAT CARBIDE ENDMILL (45HRC)

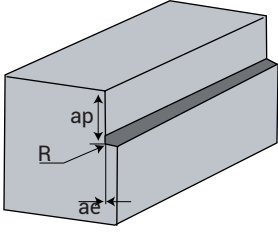
Uygulama
Application

Dik kenar frezeleme derinliği (ap)
ve radyal derinlik (ae)
Shoulder milling depth (ap)
and radial depth (ae)

ap: $\leq 1.5D$ (Tüm çaplar)
ae: $\leq 0.1D$ ($D \leq \emptyset 3$)
 $\leq 0.2D$ ($D > \emptyset 3$)

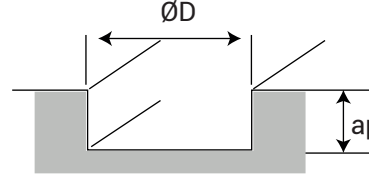

Kanal işleme derinliği (ap)
Slotting processing depth (ap)

ap: $\leq 0.1D$ ($D \leq \emptyset 2$)
 $\leq 0.2D$ ($D > \emptyset 2$)

(Hrc 38~Hrc 45)		2		4	
Dış Çap Out Dia.	Devir (dk-1) RPM (min-1)	Dik Kenar Frezeleme Shouldering MM/DK	Kanal Açma Slotting	Dik Kenar Frezeleme Shouldering MM/DK	Kanal Açma Slotting
2,0	15,000	600	480	900	720
2,5	12,000	600	480	900	720
3,0	10,000	600	480	900	720
4,0	7,500	600	480	900	720
5,0	6,000	600	480	900	720
6,0	5,000	600	480	900	720
8,0	4,000	520	410	780	620
10,0	3,200	450	360	680	540
12,0	2,700	410	320	620	490
16,0	2,000	240	190	360	280
20,0	1,600	200	160	360	240

03

KARBÜR KÜRE FREZE (45HRC & 60HRC)

BALL NOSE CARBIDE ENDMILL 845HRC & 60HRC)

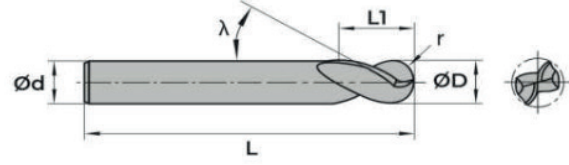

ØD(mm)	L1(mm)	L(mm)	Ød(mm)	Euroloy Kod Euroloy Code	Euroloy Kod Euroloy Code
3	12	50	3	03Z2031205003A	03Z4031205003A
4	14	51	4	03Z2041405104A	03Z4041405104A
5	16	51	5	03Z2051605105A	03Z4051605105A
6	19	58	6	03Z2061905806A	03Z4061905806A
8	20	64	8	03Z2082006408A	03Z4082006408A
10	21	73	10	03Z201021073010A	03Z401021073010A
12	25	84	12	03Z201225084012A	03Z401225084012A
14	32	84	14	03Z201432084014A	03Z401432084014A
16	32	93	16	03Z201632093016A	03Z401632093016A
18	35	93	18	03Z201835093018A	03Z401835093018A
20	38	100	20	03Z2020380100020A	03Z4020380100020A

Uygulama Application

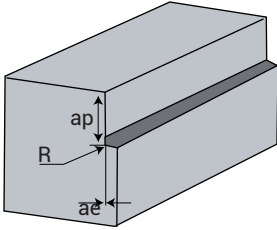

Dik kenar frezeleme derinliği (ap)
ve radyal derinlik (ae)
Shoulder milling depth (ap)
and radial depth (ae)

ap: ≤1.5D (Tüm çaplar)
ap: ≤0.1D (D ≤ Ø3)

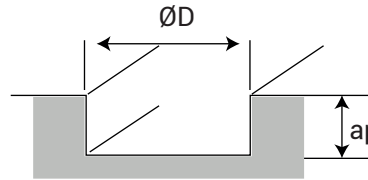

Kanal işleme derinliği (ap)
Slotting processing depth (ap)

ap: ≤0,3D

(Hrc 38~Hrc 45)				2	4
Dış Çap Out Dia.	Devir (dk-1) RPM (min-1)	Dik Kenar Frezeleme Shouldering MM/DK	Kanal Açma Slotting	Dik Kenar Frezeleme Shouldering MM/DK	Kanal Açma Slotting
2,0	11,000	180	140	360	280
3,0	8,500	200	160	400	320
4,0	7,200	360	290	720	580
5,0	6,000	380	300	760	600
6,0	5,300	420	340	840	680
8,0	4,000	450	360	900	720
10,0	3,200	390	310	780	620
12,0	2,700	330	260	660	520

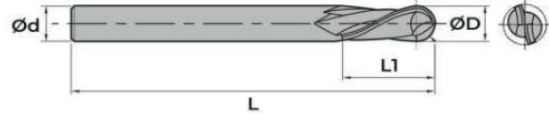

ØD(mm)	L1(mm)	L(mm)	Ød(mm)	Euroloy Kod Euroloy Code	Euroloy Kod Euroloy Code
3	20	75	3	04Z203207503A	04Z403207503A
4	20	75	4	04Z204207504A	04Z404207504A
5	25	75	5	04Z205257505A	04Z405257505A
6	25	75	6	04Z206257506A	04Z406257506A
8	30	75	8	04Z208307508A	04Z408307508A
3	20	100	3	04Z2032010003A	04Z4032010003A
4	20	100	4	04Z2042010004A	04Z4042010004A
5	25	100	5	04Z2052510005A	04Z4052510005A
6	30	100	6	04Z2063010006A	04Z4063010006A
8	30	100	8	04Z2083010008A	04Z4083010008A
10	45	100	10	04Z2104510010A	04Z4104510010A
12	45	100	12	04Z2124510012A	04Z4124510012A
14	45	100	14	04Z2144510014A	04Z4144510014A
16	45	100	16	04Z2164510016A	04Z4164510016A
18	45	100	18	04Z2184510018A	04Z4184510018A
20	45	100	20	04Z2204510020A	04Z4204510020A

Uygulama Application

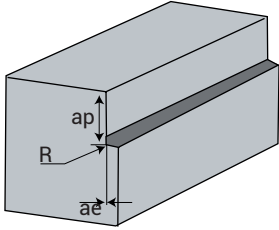

Dik kenar frezeleme derinliği (ap)
ve radyal derinlik (ae)
Shoulder milling depth (ap)
and radial depth (ae)

ap: ≤1.5 (Tüm çaplar)
ap: ≤0.1D (D ≤ Ø3)

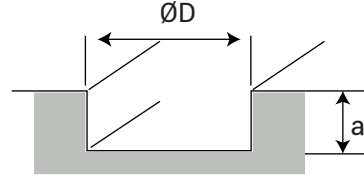

Kanal işleme derinliği (ap)
Slotting processing depth (ap)

ap: ≤0,3D

(Hrc 38~Hrc 45)		2		4	
Dış Çap Out Dia.	Devir (dk-1) RPM (min-1)	Dik Kenar Frezeleme Shouldering MM/DK	Kanal Açma Slotting	Dik Kenar Frezeleme Shouldering MM/DK	Kanal Açma Slotting
2,0	11,000	180	140	360	280
3,0	8,500	200	160	400	320
4,0	7,200	360	290	720	580
5,0	6,000	380	300	760	600
6,0	5,300	420	340	840	680
8,0	4,000	450	360	900	720
10,0	3,200	390	310	780	620
12,0	2,700	330	260	660	520

05

KARBÜR PİRR FREZE (60HRC)

CARBIDE PIRR ENDMILL (60HRC)

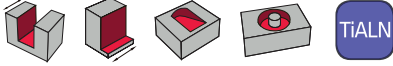
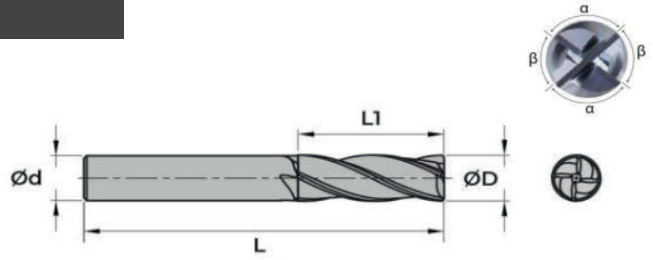

ØD(mm)	L1(mm)	L(mm)	Ød(mm)	Euroloy Kod Euroloy Code
6	19	58	6	05Z406195806
8	20	64	8	05Z408206408
10	21	73	10	05Z410217310
12	25	84	12	05Z412258412
14	32	84	14	05Z414328414
16	32	93	16	05Z416329316
18	35	93	18	05Z418359318
20	38	100	20	05Z4203810020

Uygulama Application

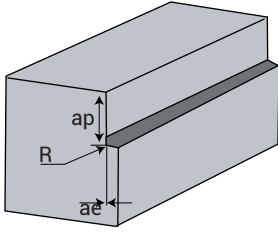

Dik kenar işleme derinliği (ap)
ve radyal derinlik (ae)
Vertical edge processing depth (ap)
and radial depth (ae)
ap= 1,0D
ae= 0,05D

*İş parçası sıkı sıkıya bağlanmalı. Titreşim durumunda devir ve ilerleme oranını aynı oranda azaltın.
The workpiece should be securely fastened. In case of vibration, reduce the spindle speed and feed rate proportionally.

(Hrc 38~Hrc 45)			
Dış Çap Out Dia.	Devir (dk-1) RPM (min-1)	Dik Kenar Frezeleme Shouldering MM/DK	Kanal Açma Slotting
2	11,560	280	168
3	8,920	320	192
4	7,560	570	342
5	6,300	600	360
6	5,560	660	396
8	4,200	710	426
10	3,260	610	366
12	2,740	520	312
16	2,200	410	246

06

KARBÜR KÖŞE RADYÜS FREZE (55≤HRC)

CORNER RADIUS CARBIDE ENDMILL (55≤HRC)

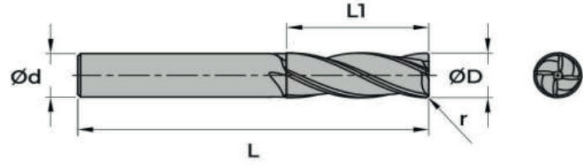

ØD(mm)	L1(mm)	L(mm)	Ød(mm)	Euroloy Kod Euroloy Code	Euroloy Kod Euroloy Code
3	12	50	3	06Z20312503#	06Z40312503#
4	14	51	4	06Z204145104#	06Z404145104#
5	16	51	5	06Z205165105#	06Z405165105#
6	19	58	6	06Z206195806#	06Z406195806#
8	20	64	8	06Z208206408#	06Z408206408#
10	21	73	10	06Z210217310#	06Z410217310#
12	25	84	12	06Z212258412#	06Z412258412#
14	32	84	14	06Z214328414#	06Z414328414#
16	32	93	16	06Z216329316#	06Z416329316#
18	35	93	18	06Z218359318#	06Z418359318#
20	38	100	20	06Z2203810020#	06Z4203810020#

Not: Köşe radyüs sipariş esnasında kodun devamına eklenecektir. #

Note: The corner radius will be added to the code during the ordering process. #

Uygulama Application

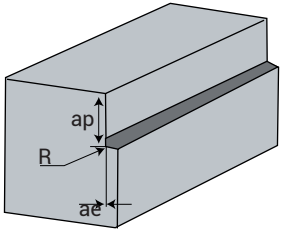

Dik kenar frezeleme derinliği (ap)
Shoulder milling depth (ap)

$D \leq 2,5(ap=1,5D, ae=0,05D)$
 $D \leq 2,5(ap=1,5D, ae=0,1D)$

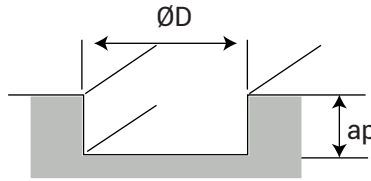

Kanal işleme derinliği (ap)
Slotting processing depth (ap)

$D \leq 2,5(ap=0,3D)$
 $D \leq 2,5(ap=0,5D)$

*İş parçası sıkı sıkıya bağlanmalı. Titreşim durumunda devir ve ilerleme oranını aynı oranda azaltın.
The workpiece should be tightly secured. In case of vibration, reduce the speed and feed rate proportionally.

(Hrc 38~Hrc 45)			2		4
Dış Çap Out Dia.	Devir (dk-1) RPM (min-1)	Dik Kenar Frezeleme Shouldering MM/DK	Kanal Açma Slotting	Dik Kenar Frezeleme Shouldering MM/DK	Kanal Açma Slotting
1	19,745	175	105	-	-
2	11,560	190	114	280	168
3	8,920	210	126	320	192
4	7,560	300	180	570	342
5	6,300	320	192	600	360
6	5,560	350	210	660	396
8	4,200	380	228	710	426
10	3,260	330	198	610	366
12	2,740	280	168	520	312
16	2,200	220	132	410	246
18	1,950	195	117	351	210
20	1,750	175	105	350	189

07

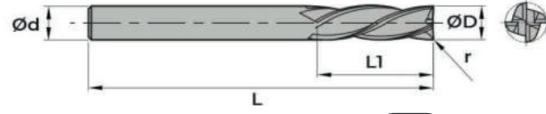
KARBÜR KÖŞE RAYDÜS UZUN FREZE (55HRC_≤)CORNER RADIUS LONG CARBIDE ENDMILL(55HRC_≤)

ØD(mm)	L1(mm)	L(mm)	Ød(mm)	Euroloy Kod Euroloy Code	Euroloy Kod Euroloy Code
3	20	75	3	07Z2032007503r#	07Z4032007503r#
4	20	75	4	07Z2042007504r#	07Z4042007504r#
5	25	75	5	07Z2052507506r#	07Z4052507506r#
6	25	75	6	07Z2062507506r#	07Z4062507506r#
8	30	75	8	07Z2083007508r#	07Z4083007508r#
3	20	100	3	07Z2032010003r#	07Z4032010003r#
4	20	100	4	07Z2042010004r#	07Z4042010004r#
5	25	100	5	07Z2052510005r#	07Z4052510005r#
6	30	100	6	07Z2063010006r#	07Z4063010006r#
8	30	100	8	07Z2083010008r#	07Z4083010008r#
10	45	100	10	07Z2104510010r#	07Z4104510010r#
12	45	100	12	07Z2124510012r#	07Z4124510012r#
14	45	100	14	07Z2144510014r#	07Z4144510014r#
16	45	100	16	07Z2164510016r#	07Z4164510016r#
18	45	100	18	07Z2184510018r#	07Z4184510018r#
20	45	100	20	07Z2204510020r#	07Z4204510020r#

Not: Köşe radyüs sipariş esnasında kodun devamına eklenecektir. #

Note: The corner radius will be added to the code during the ordering process. #

Uygulama Application

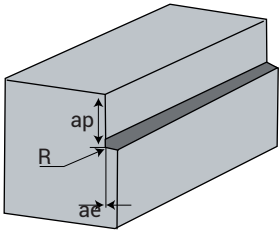

Dik kenar frezeleme derinliği (ap)
Shoulder milling depth (ap)

$$D \leq \frac{\phi}{2,5} (ap=1,5D, ae=0,05D)$$

$$D \leq \frac{\phi}{2,5} (ap=1,5D, ae=0,1D)$$

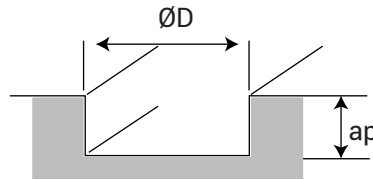

Kanal işleme derinliği (ap)
Slotting processing depth (ap)

$$D \leq \frac{\phi}{2,5} (ap=0,3D)$$

$$D \leq \frac{\phi}{2,5} (ap=0,5D)$$

*İş parçası sıkı sıkıya bağlanmalı. Titreşim durumunda devir ve ilerleme oranını aynı oranda azaltın.
The workpiece should be tightly secured. In case of vibration, reduce the speed and feed rate proportionally.

(Hrc 38~Hrc 45)			2	4	
Dış Çap Out Dia.	Devir (dk-1) RPM (min-1)	Dik Kenar Frezeleme Shouldering MM/DK	Kanal Açma Slotting	Dik Kenar Frezeleme Shouldering MM/DK	Kanal Açma Slotting
1	19,745	175	105	-	-
2	11,560	190	114	280	168
3	8,920	210	126	320	192
4	7,560	300	180	570	342
5	6,300	320	192	600	360
6	5,560	350	210	660	396
8	4,200	380	228	710	426
10	3,260	330	198	610	366
12	2,740	280	168	520	312
16	2,200	220	132	410	246
18	1,950	195	117	351	210
20	1,750	175	105	350	189

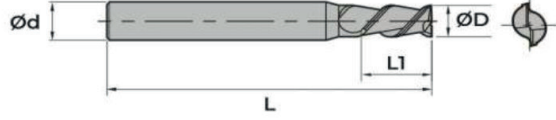

ØD(mm)	L1(mm)	L(mm)	Ød(mm)	Euroloy Kod Euroloy Code	Euroloy Kod Euroloy Code
3	12	50	3	08Z2031205003	08Z3031205003
4	14	51	4	08Z2041405105	08Z3041405105
5	16	51	5	08Z2051605105	08Z3051605105
6	19	58	6	08Z2082006408	08Z3082006408
8	20	64	8	08Z2102107310	08Z3102107310
10	21	73	10	08Z2122508412	08Z3122508412
12	25	84	12	08Z2122508412	08Z3122508412
14	32	84	14	08Z2143208414	08Z3143208414
16	32	93	16	08Z2163209316	08Z3163209316
18	35	93	18	08Z2183509318	08Z3183509318
20	38	100	20	08Z2203810020	08Z3203810020

Uygulama Application

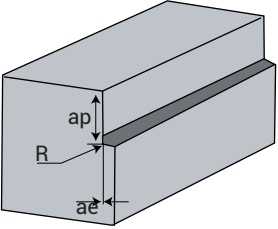

Dik kenar frezeleme paso miktarı (ap)
Stepover for square edge milling (ap)

$$ae: \leq 0,2D \quad (D < \emptyset 3)$$

$$: \leq 0,5D \quad (D < \emptyset 3)$$

$$ap: \leq 2,0D$$

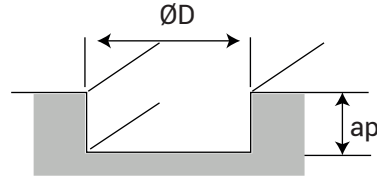

Kanal işleme paso miktarı (ap)
Stepover for channel processing (ap)

$$ap: \leq D \text{ (Maks: 12mm)}$$

*İş parçası sıkı sıkıya bağlanmalı. Titreşim durumunda devir ve ilerleme oranını aynı oranda azaltın.
The workpiece should be tightly secured. In case of vibration, reduce the speed and feed rate proportionally.

(Hrc 38~Hrc 45)					
Dış Çap Out Dia.	Devir (dk-1) RPM (min-1)	Dik Kenar Frezeleme Shouldering MM/DK	Kanal Açma Slotting	Dik Kenar Frezeleme Shouldering MM/DK	Kanal Açma Slotting
3	32,000	1,120	760	1,680	1,140
4	24,000	1,200	800	1,800	1,200
5	19,000	1,280	800	1,920	1,200
6	16,000	1,520	880	2,280	1,320
8	12,000	1,520	960	2,280	1,440
10	9,500	1,520	960	2,280	1,440
12	8,000	1,520	960	2,280	1,440
14	6,800	1,520	960	2,280	1,440
16	6,000	1,520	800	2,280	1,200
18	5,300	1,300	780	1,950	1,170
20	4,800	1,200	776	1,800	1,164

09

KARBÜR ALÜMİNYUM UZUN FİNİŞ FREZE

LONG CARBIDE ALUMINIUM FINISHING ENDMILL

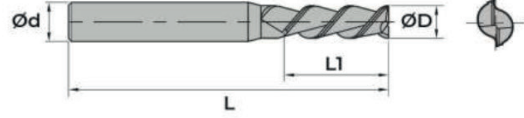

ØD(mm)	L1(mm)	L(mm)	Ød(mm)	Euroloy Kod Euroloy Code	Euroloy Kod Euroloy Code
3	20	75	3	09Z2032007503	09Z3032007503
4	20	75	4	09Z2042007504	09Z3042007504
5	25	75	5	09Z2052507505	09Z3052507505
6	25	75	6	09Z2062507506	09Z3062507506
8	30	75	8	09Z2083007508	09Z3083007508
3	20	100	3	09Z2032010003	09Z3032010003
4	20	100	4	09Z2042010004	09Z3042010004
5	25	100	5	09Z2052510005	09Z3052510005
6	30	100	6	09Z2063010006	09Z3063010006
8	30	100	8	09Z2083010008	09Z3083010008
10	45	100	10	09Z2104510010	09Z3104510010
12	45	100	12	09Z2124510012	09Z3124510012
14	45	100	14	09Z2144510014	09Z3144510014
16	45	100	16	09Z2164510016	09Z3164510016
18	45	100	18	09Z2184510018	09Z3184510018
20	45	100	20	09Z2204510020	09Z3204510020

Uygulama Application

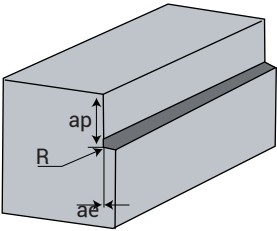

Dik kenar frezeleme paso miktarı (ap)
Stepover for square edge milling (ap)

$$ae: \leq 0,2D \quad (D < \varnothing 3)$$

$$: \leq 0,5D \quad (D < \varnothing 3)$$

$$ap: \leq 2,0D$$

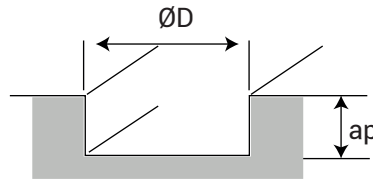

Kanal işleme paso miktarı (ap)
Stepover for channel processing (ap)

$$ap: \leq D \text{ (Maks: 12mm)}$$

*İş parçası sıkı sıkıya bağlanmalı. Titreşim durumunda devir ve ilerleme oranını aynı oranda azaltın.
The workpiece should be tightly secured. In case of vibration, reduce the speed and feed rate proportionally.

(Hrc 38~Hrc 45)		2		3	
Dış Çap Out Dia.	Devir (dk-1) RPM (min-1)	Dik Kenar Frezeleme Shouldering MM/DK	Kanal Açma Slotting	Dik Kenar Frezeleme Shouldering MM/DK	Kanal Açma Slotting
3	32,000	1,120	760	1,680	1,140
4	24,000	1,200	800	1,800	1,200
5	19,000	1,280	800	1,920	1,200
6	16,000	1,520	880	2,280	1,320
8	12,000	1,520	960	2,280	1,440
10	9,500	1,520	960	2,280	1,440
12	8,000	1,520	960	2,280	1,440
14	6,800	1,520	960	2,280	1,440
16	6,000	1,520	800	2,280	1,200
18	5,300	1,300	780	1,950	1,170
20	4,800	1,200	776	1,800	1,164

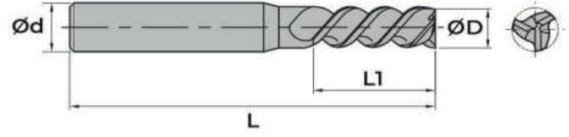

ØD(mm)	L1(mm)	L(mm)	Ød(mm)	Euroloy Kod Euroloy Code	Euroloy Kod Euroloy Code
3	12	50	3	10Z2031205003	10Z303120Z5003
4	14	51	4	10Z2041405104	10Z3041405104
5	16	51	5	10Z2051605105	10Z3051605105
6	19	58	6	10Z2061905806	10Z3061905806
8	20	64	8	10Z2082006408	10Z3082006408
10	21	73	10	10Z2102107310	10Z3102107310
12	25	84	12	10Z2122508412	10Z3122508412
14	32	84	14	10Z2143208414	10Z3143208414
16	32	93	16	10Z2163209316	10Z3163209316
18	35	93	18	10Z2183509318	10Z3183509318
20	38	100	20	10Z2203810020	10Z3203810020

Uygulama Application

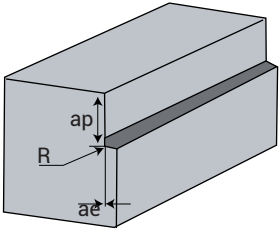

Dik kenar frezeleme paso miktarı (ap)
Stepover for square edge milling (ap)

$$ae: \leq 0,2D \quad (D < \emptyset 3)$$

$$: \leq 0,5D \quad (D < \emptyset 3)$$

$$ap: \leq 2,0D$$

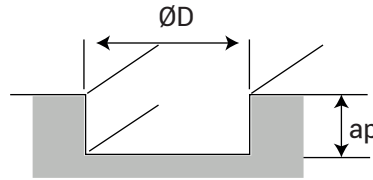

Kanal işleme paso miktarı (ap)
Stepover for channel processing (ap)

$$ap: \leq D \text{ (Maks: 12mm)}$$

*İş parçası sıkı sıkıya bağlanmalı. Titreşim durumunda devir ve ilerleme oranını aynı oranda azaltın.
The workpiece should be tightly secured. In case of vibration, reduce the speed and feed rate proportionally.

(Hrc 38~Hrc 45)					
Dış Çap Out Dia.	Devir (dk-1) RPM (min-1)	Dik Kenar Frezeleme Shouldering MM/DK	Kanal Açma Slotting	Dik Kenar Frezeleme Shouldering MM/DK	Kanal Açma Slotting
3	32,000	1,120	760	1,680	1,140
4	24,000	1,200	800	1,800	1,200
5	19,000	1,280	800	1,920	1,200
6	16,000	1,520	880	2,280	1,320
8	12,000	1,520	960	2,280	1,440
10	9,500	1,520	960	2,280	1,440
12	8,000	1,520	960	2,280	1,440
14	6,800	1,520	960	2,280	1,440
16	6,000	1,520	800	2,280	1,200
18	5,300	1,300	780	1,950	1,170
20	4,800	1,200	776	1,800	1,164

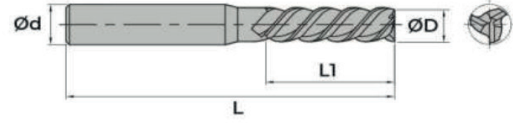

ØD(mm)	L1(mm)	L(mm)	Ød(mm)	Euroloy Kod Euroloy Code	Euroloy Kod Euroloy Code
3	20	75	3	11Z2032007503	11Z3032007503
4	20	75	4	11Z2052007504	11Z3052007504
5	25	75	5	11Z2052507505	11Z3052507505
6	25	75	6	11Z2062507506	11Z3062507506
8	30	75	8	11Z2083007508	11Z3083007508
3	20	100	3	11Z2032010003	11Z3032010003
4	20	100	4	11Z2042010004	11Z3042010004
5	25	100	5	11Z2052510005	11Z3052510005
6	30	100	6	11Z2063010006	11Z3063010006
8	30	100	8	11Z2083010008	11Z3083010008
10	45	100	10	11Z2104510010	11Z3104510010
12	45	100	12	11Z2124510012	11Z3124510012
14	45	100	14	11Z2144510014	11Z3144510014
16	45	100	16	11Z2164510016	11Z3164510016
18	45	100	18	11Z2184510018	11Z3184510018
20	45	100	20	11Z2204510020	11Z3204510020

Uygulama Application

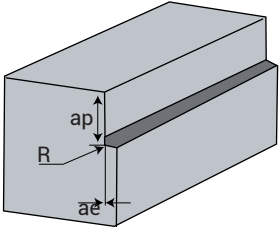

Dik kenar frezeleme paso miktarı (ap)
Stepover for square edge milling (ap)

$$ae: \leq 0,2D \quad (D < \emptyset 3)$$

$$: \leq 0,5D \quad (D < \emptyset 3)$$

$$ap: \leq 2,0D$$

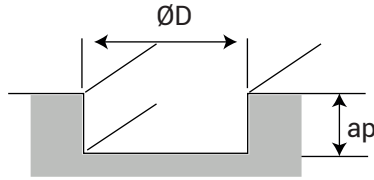

Kanal işleme paso miktarı (ap)
Stepover for channel processing (ap)

$$ap: \leq D \text{ (Maks: 12mm)}$$

*İş parçası sıkı sıkıya bağlanmalı. Titreşim durumunda devir ve ilerleme oranını aynı oranda azaltın.
The workpiece should be tightly secured. In case of vibration, reduce the speed and feed rate proportionally.

(Hrc 38~Hrc 45)					
Dış Çap Out Dia.	Devir (dk-1) RPM (min-1)	Dik Kenar Frezeleme Shouldering MM/DK	Kanal Açma Slotting	Dik Kenar Frezeleme Shouldering MM/DK	Kanal Açma Slotting
3	32,000	1,120	760	1,680	1,140
4	24,000	1,200	800	1,800	1,200
5	19,000	1,280	800	1,920	1,200
6	16,000	1,520	880	2,280	1,320
8	12,000	1,520	960	2,280	1,440
10	9,500	1,520	960	2,280	1,440
12	8,000	1,520	960	2,280	1,440
14	6,800	1,520	960	2,280	1,440
16	6,000	1,520	800	2,280	1,200
18	5,300	1,300	780	1,950	1,170
20	4,800	1,200	776	1,800	1,164

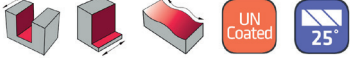
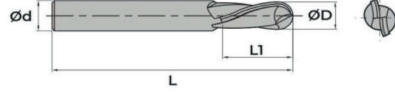

ØD(mm)	L1(mm)	L(mm)	Ød(mm)	Euroloy Kod Euroloy Code
3	12	50	3	12Z2031205003
4	14	51	4	12Z2041405104
5	16	51	5	12Z2051605105
6	19	58	6	12Z2061905806
8	20	64	8	12Z2082006408
10	21	73	10	12Z2102107310
12	25	84	12	12Z2122508412
14	32	84	14	12Z2143208414
16	32	93	16	12Z2163209316
18	35	93	18	12Z2183509318
20	38	100	20	12Z2203810020

Uygulama Application

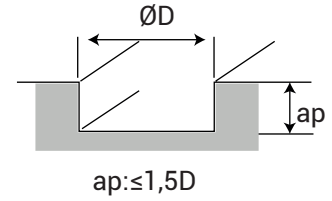
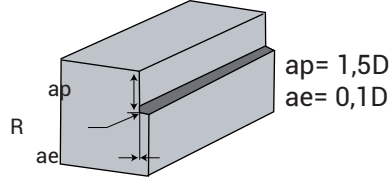
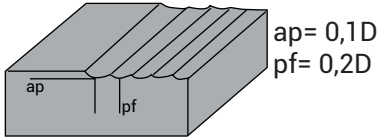

*İş parçası sıkı sıkıya bağlanmalı. Titreşim durumunda devir ve ilerleme oranını aynı oranda azaltın.
The workpiece should be tightly secured. In case of vibration, reduce the speed and feed rate proportionally.

(Hrc 38~Hrc 45)			2
Dış Çap Out Dia.	Devir (dk-1) RPM (min-1)	Dik Kenar Frezeleme Shouldering MM/DK	Kanal Açma Slotting
3	32,000	1,120	760
4	24,000	1,200	800
5	19,000	1,280	800
6	16,000	1,520	880
8	12,000	1,520	960
10	9,500	1,520	960
12	8,000	1,520	960
14	6,800	1,520	960
16	6,000	1,520	800
18	5,300	1,300	780
20	4,800	1,200	776

13

KARBÜR ALÜMİNYUM UZUN KÜRE FREZE

BALL NOSE LONG CARBIDE ALUMINIUM ENDMILL

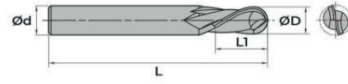

2

ØD(mm)	L1(mm)	L(mm)	Ød(mm)	Euroloy Kod Euroloy Code
3	20	75	3	13Z2032007503
4	20	75	4	13Z2042007504
5	25	75	5	13Z2052507505
6	25	75	6	13Z2062507506
8	30	75	8	13Z2083007508
3	20	100	3	13Z2032010003
4	20	100	4	13Z2042010004
5	25	100	5	13Z2052510005
6	30	100	6	13Z2063010006
8	30	100	8	13Z2083010008
10	45	100	10	13Z2104510010
12	45	100	12	13Z2124510012
14	45	100	14	13Z2144510014
16	45	100	16	13Z2164510016
18	45	100	18	13Z2184510018
20	45	100	20	13Z2204510020

Uygulama Application

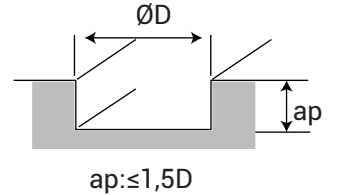
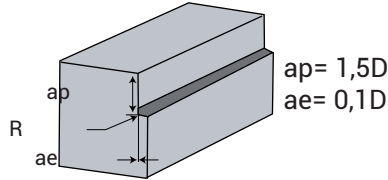
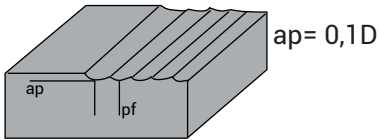

(Hrc 38~Hrc 45)

2

Dış Çap Out Dia.	Devir (dk-1) RPM (min-1)	Dik Kenar Frezeleme Shouldering MM/DK	Kanal Açma Slotting
3	32,000	1,120	760
4	24,000	1,200	800
5	19,000	1,280	800
6	16,000	1,520	880
8	12,000	1,520	960
10	9,500	1,520	960
12	8,000	1,520	960
14	6,800	1,520	960
16	6,000	1,520	800
18	5,300	1,300	780
20	4,800	1,200	776

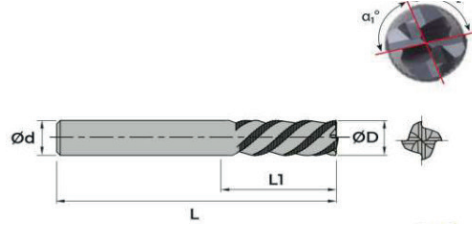

ØD(mm)	L1(mm)	L(mm)	Ød(mm)	Euroloy Kod Euroloy Code
6	19	57	6	14Z4061905706
8	20	63	8	14Z4082006308
10	21	72	10	14Z4102107210
12	25	83	12	14Z4122508312
14	32	83	14	14Z4143208314
16	32	92	16	14Z4163209216
18	35	92	18	14Z4183509218
20	38	104	20	14Z4209810420
22	38	104	22	14Z4223810422
24	38	104	24	14Z4243810424
25	38	104	25	14Z4253810425
28	38	104	28	14Z4283810428

Uygulama Application

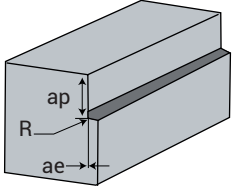

Dik kenar işleme derinliği (ap)
Vertical edge processing depth (ap)
ap: $\leq 1,0D$
ae: $\leq 0,5D$ ($\leq \text{HRC}25$)
: $\leq 0,35D$ (HRC25 ~40)

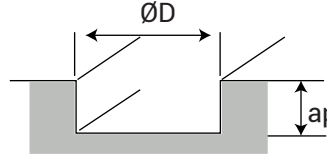

Kanal işleme derinliği (ap)
Stepover processing depth (ap)
ap: $\leq 1,0D$ ($\leq \text{HRC}25$)
 $\leq 0,8D$ (HRC25 ~40)

*İş parçası sıkı sıkıya bağlanmalı. Titreşim durumunda devir ve ilerleme oranını aynı oranda azaltın.
The workpiece should be tightly secured. In case of vibration, reduce the speed and feed rate proportionally.

(Hrc 38~Hrc 45)			4
Dış Çap Out Dia.	Devir (dk-1) RPM (min-1)	Dik Kenar Frezeleme Shouldering MM/DK	Kanal Açma Slotting
6	12,00	1,090	654
8	9,000	1,160	696
10	7,200	1,160	696
12	6,000	1,080	648
14	5,200	1,080	648
16	4,500	1,080	648
18	4,400	1,000	600
20	3,600	930	558
22	3,600	930	558
24	3,200	840	500
25	3,200	840	500
28	2,800	740	440

15

KARBÜR UZUN KABA TALAŞ FREZE

LONG CARBIDE ROUGHING ENDMILL

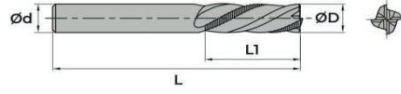

ØD(mm)	L1(mm)	L(mm)	Ød(mm)	Euroloy Kod Euroloy Code
6	30	100	6	15Z4063010006
8	30	100	8	15Z4083010008
8	65	150	8	15Z4086515008
10	65	150	10	15Z4104515010
12	65	150	12	15Z4126515012
14	65	150	14	15Z4146515014
16	75	150	16	15Z4167515016
18	75	150	18	15Z4187515018
20	75	150	20	15Z4207515020
22	75	150	22	15Z4227515022
24	75	150	24	15Z4247515024
25	75	150	25	15Z4257515025

Uygulama Application

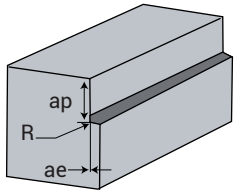

Dik kenar işleme derinliği (ap)
Vertical edge processing depth (ap)
ap: ≤ 1,0D
ae: ≤ 0,5D (≤HRC25)
: ≤0,35D (HRC25 ~40)

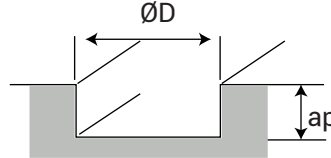

Kanal işleme derinliği (ap)
Stepover processing depth (ap)
ap: ≤1,0D(≤HRC25)
≤0,8D(HRC25 ~40)

*İş parçası sıkı sıkıya bağlanmalı. Titreşim durumunda devir ve ilerleme oranını aynı oranda azaltın.
The workpiece should be tightly secured. In case of vibration, reduce the speed and feed rate proportionally.

(Hrc 38~Hrc 45)			4
Dış Çap Out Dia.	Devir (dk-1) RPM (min-1)	Dik Kenar Frezeleme Shouldering MM/DK	Kanal Açma Slotting
6	12,000	1,090	654
8	9,000	1,160	696
10	7,200	1,160	696
12	6,000	1,080	648
14	5,200	1,080	648
16	4,500	1,080	648
18	4,400	1,000	600
20	3,600	930	558
22	3,600	930	558
24	3,200	840	500
25	3,200	840	500
28	2,800	740	440

16 KARBÜR FİNİŞ FREZE Z6

CARBIDE FINISHING ENDMILL Z6

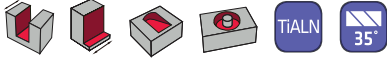
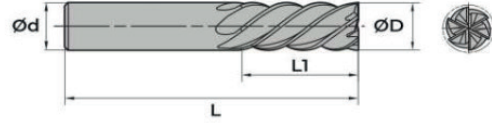

ØD(mm)	L1(mm)	L(mm)	Ød(mm)	Euroloy Kod Euroloy Code
6	19	58	6	16Z6061905806
8	20	64	8	16Z6082006408
10	21	73	10	16Z6102107310
12	25	84	12	16Z6122508412
14	32	84	14	16Z6143208414
16	32	93	16	16Z6163209316
18	35	93	18	16Z6183509318
20	38	100	20	16Z6203810020
22	38	100	22	16Z6223810022
24	38	100	24	16Z6243810024
25	38	100	25	16Z6253810025
28	38	100	28	16Z6283810028

(Hrc 38~Hrc 45)				6
Dış Çap Out Dia.	Devir (dk-1) RPM (min-1)	Dik Kenar Frezeleme Shouldering MM/DK	Kanal Açma Slotting	
6	3,200	900	540	
8	2,400	905	541	
10	1,950	840	500	
12	1,600	720	432	
14	1,400	720	432	
16	1,200	840	500	
18	1,000	720	432	
20	1,750	720	432	
22	1,592	716	431	
24	1,459	700	400	
25	1,400	672	385	

17

KARBÜR UZUN FİNİŞ FREZE Z6

LONG CARBIDE FINISHING ENDMILL Z6

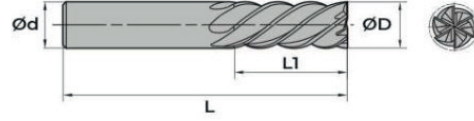

ØD(mm)	L1(mm)	L(mm)	Ød(mm)	Euroloy Kod Euroloy Code
6	30	100	6	17Z6063010006
8	30	100	8	17Z6083010008
8	65	150	8	17Z6086515008
10	65	150	10	17Z6106515010
12	65	150	12	17Z6126515012
14	65	150	14	17Z6146515014
16	75	150	16	17Z6167515016
18	75	150	18	17Z6187515018
20	75	150	20	17Z6207515020
22	75	150	22	17Z6227515022
24	75	150	24	17Z6247515024
25	75	150	25	17Z6257515025

(Hrc 38~Hrc 45)			6
Dış Çap Out Dia.	Devir (dk-1) RPM (min-1)	Dik Kenar Frezeleme Shouldering MM/DK	Kanal Açma Slotting
6	3,200	900	540
8	2,400	905	541
10	1,950	840	500
12	1,600	720	432
14	1,400	720	432
16	1,200	840	500
18	1,000	720	432
20	1,750	720	432
22	1,592	716	431
24	1,459	700	400
25	1,400	672	385

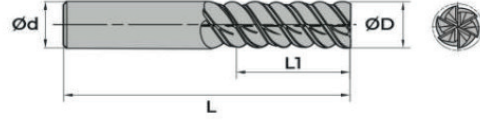

ØD(mm)	L1(mm)	L(mm)	Ød(mm)	Euroloy Kod Euroloy Code
10	21	73	10	18Z8102107310
12	25	84	12	18Z8122508412
14	32	84	14	18Z8143208414
16	32	93	16	18Z8163209316
18	35	93	18	18Z8183509318
20	38	100	20	18Z8203810020
22	38	100	22	18Z8223810022
24	38	100	24	18Z8243810024
25	38	100	25	18Z8253810025
28	38	100	28	18Z8283810028

(Hrc 38~Hrc 45)			
Dış Çap Out Dia.	Devir (dk-1) RPM (min-1)	Dik Kenar Frezeleme Shouldering MM/DK	Kanal Açma Slotting
10	2,865	687	410
12	1,857	650	356
14	1,592	636	380
16	1,393	612	367
18	1,238	544	326
20	1,114	534	320
22	1,013	486	291
24	928	445	267
25	891	427	256
28	796	382	230

19

KARBÜR UZUN FİNİŞ FREZE Z8

LONG CARBIDE FINISHING ENDMILL Z8

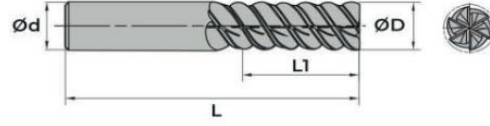

ØD(mm)	L1(mm)	L(mm)	Ød(mm)	Euroloy Kod Euroloy Code
10	45	100	10	19Z8104510010
12	45	100	12	19Z8124510012
14	45	100	14	19Z8144510014
10	65	150	10	19Z8106515010
12	65	150	12	19Z8126515012
14	65	150	14	19Z8146515014
16	75	150	16	19Z8167515016
18	75	150	18	19Z8187515018
20	75	150	20	19Z8207515020
22	75	150	22	19Z8227515022
24	75	150	24	19Z8247515024
25	75	150	25	19Z8257515025

(Hrc 38~Hrc 45)			
Dış Çap Out Dia.	Devir (dk-1) RPM (min-1)	Dik Kenar Frezeleme Shouldering MM/DK	Kanal Açma Slotting
10	2,865	687	410
12	1,857	650	356
14	1,592	636	380
16	1,393	612	367
18	1,238	544	326
20	1,114	534	320
22	1,013	486	291
24	928	445	267
25	891	427	256
28	796	382	230

20 KARBÜR KONİK DÜZ AĞIZLI FREZE

TAPERED FLAT CARBIDE ENDMILL

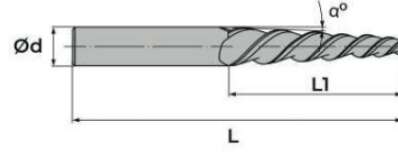

ØD(mm)	L1(mm)	L(mm)	Ød(mm)	α°	Euroloy Kod Euroloy Code
2	20	75	3	0,5°	20Z4022007503
3	25	75	3	0,5°	20Z4032507503
4	30	75	5	0,5°	20Z4043007505
5	30	75	6	0,5°	20Z4053007506
6	40	100	8	0,5°	20Z4064010008
8	45	100	10	0,5°	20Z4084510010
10	45	100	12	0,5°	20Z4104510012
12	45	100	14	0,5°	20Z4124510014
2	20	75	3	1°	20Z4022007503
3	28	75	3	1°	20Z4032807503
4	28	75	5	1°	20Z4042807505
5	28	75	6	1°	20Z4052807506
6	40	100	8	1°	20Z4064010008
8	45	100	10	1°	20Z4084510010
10	45	100	12	1°	20Z4104510012
12	45	100	14	1°	20Z4124510014
2	20	75	3	1,5°	20Z4022007503
3	28	75	3	1,5°	20Z4032807503
4	28	75	5	1,5°	20Z4042807505
5	28	75	6	1,5°	20Z4052807506
6	40	100	8	1,5°	20Z4064010008
8	45	100	10	1,5°	20Z4084510010
10	45	100	12	1,5°	20Z4104510012
12	45	100	14	1,5°	20Z4124510014
2	20	75	3	2°	20Z4022007503
3	25	75	3	2°	20Z4032507503
4	30	75	5	2°	20Z4043007505
5	30	75	6	2°	20Z4053007506
6	40	100	8	2°	20Z4064010008
8	45	100	10	2°	20Z4084510010
10	45	100	12	2°	20Z4104510012
12	45	100	14	2°	20Z4124510014

20 KARBÜR KONİK DÜZ AĞIZLI FREZE

TAPERED FLAT CARBIDE ENDMILL

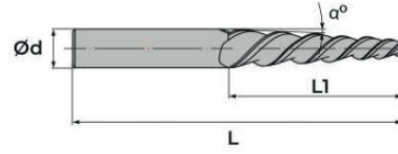

ØD(mm)	L1(mm)	L(mm)	Ød(mm)	α°	Euroloy Kod Euroloy Code
2	20	75	3	3°	20Z4022007503M30
3	28	75	3	3°	20Z4032507503M30
4	28	75	5	3°	20Z4043007505M30
5	28	75	6	3°	20Z4053007506M30
6	40	100	8	3°	20Z4064010008M30
8	45	100	10	3°	20Z4084510010M30
10	45	100	12	3°	20Z4154510012M30
12	45	100	14	3°	20Z4124510014M30
2	20	75	3	5°	20Z4022007503M50
3	28	75	3	5°	20Z4032507503M50
4	28	75	5	5°	20Z4045007505M50
5	28	75	6	5°	20Z4055007506M50
6	40	100	8	5°	20Z4064010008M50
8	45	100	10	5°	20Z4084510010M50
10	45	100	12	5°	20Z4154510012M50
12	45	100	14	5°	20Z4124510014M50

(Hrc 38~Hrc 45)			
Dış Çap Out Dia.	Devir (dk-1) RPM (min-1)	Dik Kenar Frezeleme Shouldering MM/DK	Kanal Açma Slotting
2	11,110	170	102
3	7,400	150	100
4	5,500	135	81
5	4,400	160	96
6	3,700	160	96
8	2,700	160	96
10	2,200	170	102
12	1,800	180	108

21 KARBÜR KONİK KÜRE AĞIZLI FREZE

TAPERED BALL NOSE CARBIDE ENDMILL

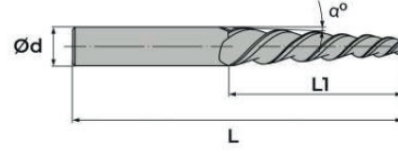

ØD(mm)	L1(mm)	L(mm)	Ød(mm)	a°	Euroloy Kod Euroloy Code
2	20	75	3	0,5°	21Z4022007503M05
3	28	75	3	0,5°	21Z4032507503M05
4	28	75	5	0,5°	21Z4043007505M05
5	28	75	6	0,5°	21Z4053007506M05
6	40	100	8	0,5°	21Z4064010008M05
8	45	100	10	0,5°	21Z4084510010M05
10	45	100	12	0,5°	21Z4154510012M05
12	45	100	14	0,5°	21Z4124510014M05
2	20	75	3	1°	21Z4022007503M10
3	28	75	3	1°	21Z4032507503M10
4	28	75	5	1°	21Z4043007505M10
5	28	75	6	1°	21Z4053007506M10
6	40	100	8	1°	21Z4064010008M10
8	45	100	10	1°	21Z4084510010M10
10	45	100	12	1°	21Z4154510012M10
12	45	100	14	1°	21Z4124510014M10
2	20	75	3	1,5°	21Z4022007503M15
3	28	75	3	1,5°	21Z4032507503M15
4	28	75	5	1,5°	21Z4043007505M15
5	28	75	6	1,5°	21Z4053007506M15
6	40	100	8	1,5°	21Z4064010008M15
8	45	100	10	1,5°	21Z4084510010M15
10	45	100	12	1,5°	21Z4154510012M15
12	45	100	14	1,5°	21Z4124510014M15
2	20	75	3	2°	21Z4022007503M20
3	25	75	3	2°	21Z4032507503M20
4	30	75	5	2°	21Z4043007505M20
5	30	75	6	2°	21Z4053007506M20
6	40	100	8	2°	21Z4064010008M20

21 KARBÜR KONİK KÜRE AĞIZLI FREZE

TAPERED BALL NOSE CARBIDE ENDMILL

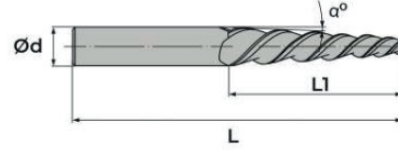

ØD(mm)	L1(mm)	L(mm)	Ød(mm)	α°	Euroloy Kod Euroloy Code
2	20	75	3	3°	21Z4022007503M30
3	28	75	3	3°	21Z4032507503M30
4	28	75	5	3°	21Z4043007505M30
5	28	75	6	3°	21Z4053007506M30
6	40	100	8	3°	21Z4064010008M30
8	45	100	10	3°	21Z4084510010M30
10	45	100	12	3°	21Z4154510012M30
12	45	100	14	3°	21Z4124510014M30
2	20	75	3	5°	21Z4022007503M50
3	28	75	3	5°	21Z4032507503M50
4	28	75	5	5°	21Z4043007505M50
5	28	75	6	5°	21Z4053007506M50
6	40	100	8	5°	21Z4064010008M50
8	45	100	10	5°	21Z4084510010M50
10	45	100	12	5°	21Z4154510012M50
12	45	100	14	5°	21Z4124510014M50

(Hrc 38~Hrc 45)			
Dış Çap Out Dia.	Devir (dk-1) RPM (min-1)	Dik Kenar Frezeleme Shouldering MM/DK	Kanal Açma Slotting
2	11,110	170	102
3	7,400	150	100
4	5,500	135	81
5	4,400	160	96
6	3,700	160	96
8	2,700	160	96
10	2,200	170	102
12	1,800	180	108

22 KARBÜR İÇ BÜKEY FREZE

CARBIDE ROUNDING CONCAVE CUTTER

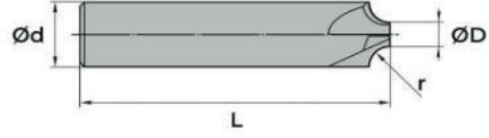

r(mm)	L(mm)	Ød(mm)	Euroloy Kod Euroloy Code	Euroloy Kod Euroloy Code
1	63	8	22Z3061006308	22Z4061006308
1,5	67	9	22Z3061506709	22Z4061506709
2	72	10	22Z3062007210	22Z4062007210
2,5	75	11	22Z3062507511	22Z4062507511
3	83	12	22Z3063008312	22Z4063008312
3,5	83	13	22Z3063508313	22Z4063508313
4	83	14	22Z3064008314	22Z4064008314
4,5	92	15	22Z3064509215	22Z4064509215
5	92	16	22Z3065009216	22Z4065009216
6	92	18	22Z3066009218	22Z4066009218
8	100	22	22Z3068010022	22Z4068010022

(Hrc 38~Hrc 45)		3		4	
Dış Çap Out Dia.	Devir (dk-1) RPM (min-1)	Dik Kenar Frezeleme Shouldering MM/DK	Kanal Açma Slotting	Dik Kenar Frezeleme Shouldering MM/DK	Kanal Açma Slotting
4	7,200	720	432	960	576
6	4,800	570	342	760	456
8	3,570	570	342	760	456
10	2,800	850	510	1,133	680
12	2,400	760	456	1,013	608
16	1,800	710	426	946	568
18	1,600	710	426	946	568
22	1,300	710	426	946	568

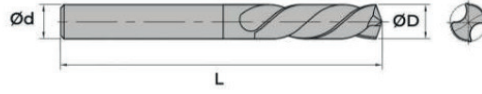

Çap Diameter ØD(mm)	Tam Boy Overall Length L(mm)	Şaft Çapı Schaft Dia. Ød(mm)	Euroloy Kod Euroloy Code
3,0	46	3	250303D04603
3,1	55	4	250313D05504
3,2	55	4	250323D05504
3,3	55	4	250333D05504
3,4	55	4	250343D05504
3,5	55	4	250353D05504
3,6	55	4	250363D05504
3,7	55	4	250373D05504
3,8	55	4	250383D05504
3,9	55	4	250393D05504
4,0	62	5	250403D06205
4,1	62	5	250413D06205
4,2	62	5	250423D06205
4,3	62	5	250433D06205
4,4	62	5	250443D06205
4,5	62	5	250453D06205
4,6	62	5	250463D06205
4,7	62	5	250473D06205
4,8	62	5	250483D06205
4,9	62	5	250493D06205
5,0	62	5	250503D06205
5,1	66	6	250513D06606
5,2	66	6	250523D06606
5,3	66	6	250533D06606
5,4	66	6	250543D06606
5,5	66	6	250553D06606
5,6	66	6	250563D06606
5,7	66	6	250573D06606
5,8	66	6	250583D06606
5,9	66	6	250593D06606
6,0	66	6	250603D06606
6,1	74	7	250613D07407
6,2	74	7	250623D07407
6,3	74	7	250633D07407
6,4	74	7	250643D07407

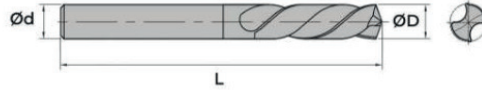

Çap Diameter ØD(mm)	Tam Boy Overall Length L(mm)	Şaft Çapı Schaft Dia. Ød(mm)	Euroloy Kod Euroloy Code
6,5	74	7	250653S07407
6,6	74	7	250663S07407
6,7	74	7	250673S07407
6,8	74	7	250683S07407
6,9	74	8	250693D07408
7,0	74	8	250703D07408
7,1	79	8	250713D07908
7,2	79	8	250723D07908
7,3	79	8	250733D07908
7,4	79	8	250743D07908
7,5	79	8	250753D07908
7,6	79	8	250763D07908
7,7	79	8	250773D07908
7,8	79	8	250783D07908
7,9	79	8	250793D07908
8,0	79	8	250803D07908
8,1	84	9	250813D08409
8,2	84	9	250823D08409
8,3	84	9	250833D08409
8,4	84	9	250843D08409
8,5	84	9	250853D08409
8,6	84	9	250863D08409
8,7	84	9	250873D08409
8,8	84	9	250883D08409
8,9	84	9	250903D08409
9,0	89	10	250913D08910
9,1	89	10	250923D08910
9,2	89	10	250933D08910
9,3	89	10	250943D08910
9,4	89	10	250953D08910
9,5	89	10	250963D08910
9,6	89	10	250963D08910
9,7	89	10	250973D08910
9,8	89	10	250983D08910
9,9	89	10	250993D08910

25

3D KARBÜR MATKAP

3D CARBIDE DRILL

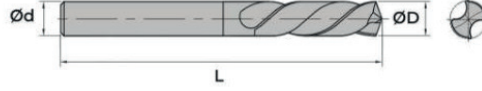

Çap Diameter ØD(mm)	Tam Boy Overall Length L(mm)	Şaft Çapı Shaft Dia. Ød(mm)	Euroloy Kod Euroloy Code
10	89	10	251003D08910
10,5	95	11	251053D09511
11	95	11	251103D09511
11,5	102	12	251153D10212
12	102	12	251203D10212
12,5	102	13	251253D10213
13	102	13	251303D10213
13,5	107	14	251353D10714
14	107	14	251403D10714
14,5	111	15	251453D11115
15	111	15	251503D11115
15,5	115	16	251553D11516
16	115	16	251603D11516
16,5	115	17	251653D11517
17	115	17	251703D11517
17,5	115	18	251753D11518
18	123	18	251803D12318
18,5	123	19	251853D12319
19	123	19	251903D12319
19,5	131	20	251953D13120
20	131	20	252003D13120

3D	f ilerleme mm / dev												Vc
P	0,14	0,16	0,19	0,22	0,25	0,32	0,36	0,42	0,46	0,5	0,5	0,55	155-230
M	0,075	0,095	0,11	0,13	0,15	0,19	0,22	0,25	0,28	0,3	0,3	0,32	70-110
K	0,15	0,18	0,22	0,25	0,28	0,36	0,42	0,48	0,5	0,55	0,6	0,65	125-175
N	0,13	0,16	0,19	0,22	0,26	0,32	0,38	0,42	0,46	0,5	0,55	0,55	225-350
S	0,07	0,085	0,095	0,11	0,12	0,14	0,17	0,19	0,22	0,24	0,25	0,26	39-70
H	0,065	0,08	0,09	0,1	0,12	0,14	0,16	0,19	0,2	0,22	0,24	0,24	55-80

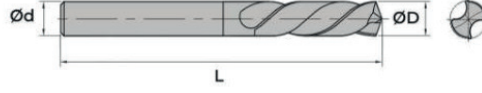

Çap Diameter ØD(mm)	Tam Boy Overall Length L(mm)	Şaft Çapı Schaft Dia. Ød(mm)	Euroloy Kod Euroloy Code
3,0	66	6	260305D06606
3,1	66	6	260315D06606
3,2	66	6	260325D06606
3,3	66	6	260335D06606
3,4	66	6	260345D06606
3,5	66	6	260355D06606
3,6	66	6	260365D06606
3,7	66	6	260375D06606
3,8	77	6	260385D06606
3,9	77	6	260395D06606
4,0	77	6	260405D07406
4,1	77	6	260415D07406
4,2	77	6	260425D07406
4,3	77	6	260435D07406
4,4	77	6	260445D07406
4,5	77	6	260455D07406
4,6	77	6	260465D07406
4,7	82	6	260475D07406
4,8	82	6	260475D08206
4,9	82	6	260495D08206
5,0	82	6	260505D08206
5,1	82	6	260515D08206
5,2	82	6	260525D08206
5,3	82	6	260535D08206
5,4	82	6	260545D08206
5,5	82	6	260555D08206
5,6	82	6	260565D08206
5,7	82	6	260575D08206
5,8	82	6	260585D08206
5,9	82	6	260595D08206
6,0	82	6	260605D08206
6,1	91	8	260615D09108
6,2	91	8	260625D09108
6,3	91	8	260635D09108
6,4	91	8	260645D09108

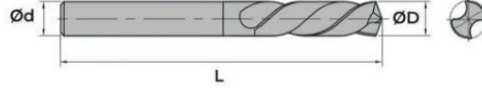

Çap Diameter ØD(mm)	Tam Boy Overall Length L(mm)	Şaft Çapı Shaft Dia. Ød(mm)	Euroloy Kod Euroloy Code
6,5	91	8	260655D09108
6,6	91	8	260665D09108
6,7	91	8	260675D09108
6,8	91	8	260685D09108
6,9	91	8	260695D09108
7,0	91	8	260705D09108
7,1	91	8	260715D09108
7,2	91	8	260725D09108
7,3	91	8	260735D09108
7,4	91	8	260745D09108
7,5	91	8	260755D09108
7,6	91	8	260765D09108
7,7	91	8	260775D09108
7,8	91	8	260785D09108
7,9	91	8	260795D09108
8,0	91	8	260805D09108
8,1	103	10	260815D10310
8,2	103	10	260825D10310
8,3	103	10	260835D10310
8,4	103	10	260845D10310
8,5	103	10	260855D10310
8,6	103	10	260865D10310
8,7	103	10	260875D10310
8,8	103	10	260885D10310
8,9	103	10	260895D10310
9,0	103	10	260905D10310
9,1	103	10	260915D10310
9,2	103	10	260925D10310
9,3	103	10	260935D10310
9,4	103	10	260945D10310
9,5	103	10	260955D10310
9,6	103	10	260965D10310
9,7	103	10	260975D10310
9,8	103	10	260985D10310
9,9	103	10	260995D10310
10	103	10	261005D10310

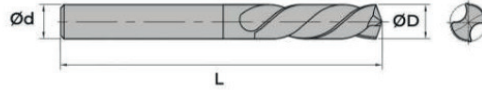

Çap Diameter ØD(mm)	Tam Boy Overall Length L(mm)	Şaft Çapı Shaft Dia. Ød(mm)	Euroloy Kod Euroloy Code
105	118	12	261055D11812
11,0	118	12	261105D11812
11,5	118	12	261155D11812
12,0	118	12	261205D11812
12,5	124	14	261265D12414
13,0	124	14	261305D12414
13,5	124	14	261355D12414
14,0	124	14	261405D12414
14,5	133	16	261455D13316
15,0	133	16	261505D13316
15,5	133	16	261555D13316
16,0	133	16	261605D13316
16,5	143	18	261655D14318
17,0	143	18	261705D14318
17,5	143	18	261755D14318
18,0	143	20	261805D14318
18,5	153	20	261855D15320
19,0	153	20	261905D15320
19,5	153	20	261955D15320
20,0	153	20	262005D15320

5D	f ilerleme mm / dev												Vc
P	0,14	0,17	0,2	0,24	0,26	0,32	0,38	0,44	0,48	0,5	0,55	0,6	155-230
M	0,075	0,095	0,11	0,13	0,15	0,19	0,22	0,25	0,28	0,3	0,3	0,32	70-110
K	0,15	0,18	0,22	0,25	0,28	0,36	0,42	0,48	0,5	0,55	0,6	0,65	125-175
N	0,13	0,16	0,19	0,22	0,26	0,32	0,38	0,42	0,46	0,5	0,55	0,55	225-350
S	0,07	0,085	0,095	0,11	0,12	0,14	0,17	0,19	0,22	0,24	0,25	0,26	39-70
H	0,085	0,1	0,12	0,13	0,15	0,18	0,16	0,19	0,2	0,22	0,24	0,24	55-80

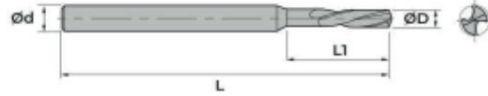

Çap Diameter ØD(mm)	Helis Boyu Length Of Cut L1 (mm)	Tam Boy Overall Length L(mm)	Şaft Çapı Shaft Dia. Ød(mm)	Euroloy Kod Euroloy Code
1	8	50	3	2701000805003
1,1	8	50	3	2701100805003
1,2	8	50	3	2701200805003
1,3	8	50	3	2701300805003
1,4	10	50	3	27014008505003
1,5	10	50	3	2701500805003
1,6	10	50	3	2701600805003
1,7	10	50	3	2701700805003
1,8	12	50	3	2701800805003
1,9	12	50	3	2701900805003
2	12	50	3	2702000805003
2,1	12	50	3	2702101205003
2,2	12	50	3	2702201205003
2,3	14	50	3	2702301405003
2,4	14	50	3	2702401405003
2,5	14	50	3	2702501405003
2,6	14	50	3	2702601405003
2,7	14	50	3	2702701405003
2,8	14	50	3	2702801405003
2,9	14	50	3	2702901405003

MICRO D	f İlerleme mm / dev					Vc
P	0,055	0,065	0,07	0,075	0,08	145-200
M	0,055	0,065	0,075	0,08	0,1	60-100
K	0,095	0,11	0,12	0,13	0,15	115-165

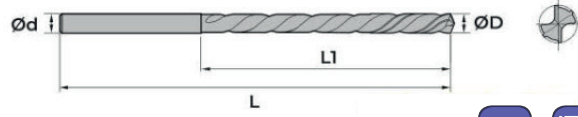

Çap Diameter ØD(mm)	Helis Boyu Length Of Cut L1 (mm)	Tam Boy Overall Length L(mm)	Şaft Çapı Schaft Dia. Ød(mm)
3,0	33	61	4
3,1	33	75	4
3,2	33	75	4
3,3	33	75	4
3,4	33	75	4
3,5	39	75	4
3,6	39	75	4
3,7	39	75	4
3,8	39	75	4
3,9	39	75	4
4,0	43	75	4
4,1	43	86	5
4,2	43	86	5
4,3	43	86	5
4,4	43	86	5
4,5	47	86	5
4,6	47	86	5
4,7	47	86	5
4,8	47	86	5
4,9	47	86	5
5,0	52	86	5
5,1	52	93	6
5,2	52	93	6
5,3	52	93	6
5,4	52	93	6
5,5	57	93	6
5,6	57	93	6
5,7	57	93	6
5,8	57	93	6
5,9	57	93	6
6,0	57	93	6
6,1	57	109	7
6,2	57	109	7
6,3	57	109	7
6,4	57	109	7

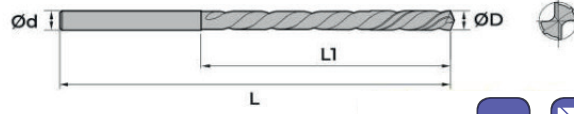

Çap Diameter ØD(mm)	Helis Boyu Length Of Cut L1 (mm)	Tam Boy Overall Length L(mm)	Şaft Çapı Schaft Dia. Ød(mm)
6,5	33	61	4
6,6	33	75	4
6,7	33	75	4
6,8	33	75	4
6,9	33	75	4
7,0	39	75	4
7,1	39	75	4
7,2	39	75	4
7,3	39	75	4
7,4	39	75	4
7,5	43	75	4
7,6	43	86	5
7,7	43	86	5
7,8	43	86	5
7,9	43	86	5
8,0	47	86	5
8,1	47	86	5
8,2	47	86	5
8,3	47	86	5
8,4	47	86	5
8,5	52	86	5
8,6	52	93	6
8,7	52	93	6
8,8	52	93	6
8,9	52	93	6
9,0	57	93	6
9,1	57	93	6
9,2	57	93	6
9,3	57	93	6
9,4	57	93	6
9,5	57	93	6
9,6	57	109	7
9,7	57	109	7
9,8	57	109	7
9,9	57	109	7

28

KARBÜR EKSTRA UZUN MATKAP

EXTRA LONG CARBIDE DRILL

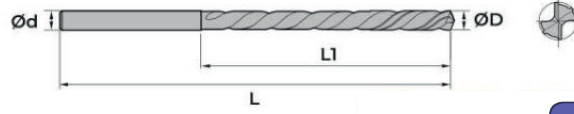

TIALN

30°



Çap Diameter ØD(mm)	Helis Boyu Length Of Cut L1 (mm)	Tam Boy Overall Length L(mm)	Şaft Çapı Shaft Dia. Ød(mm)	Euroloy Kod Euroloy Code
10	87	133	10	2810008713310
10,5	87	142	11	2810508714211
11	94	142	11	2811008414211
11,5	94	151	12	2811509415112
12	101	151	12	2812010115112
12,5	101	151	13	2812510115113
13	101	151	13	2813010115113
13,5	101	151	14	2813510115114
14	101	151	14	2814010115114

EXTRA D	f ilerleme mm / dev												Vc
P	0,1	0,12	0,14	0,16	0,18	0,22	0,25	0,28	0,3	0,32	0,34	0,36	145-200
M	0,04	0,055	0,07	0,08	0,095	0,12	0,14	0,16	0,18	0,19	0,2	0,22	60-100
K	0,08	0,1	0,11	0,13	0,15	0,18	0,2	0,24	0,25	0,28	0,28	0,3	115-165
H	0,048	0,055	0,065	0,075	0,085	0,1	0,12	0,14	0,15	0,16	0,17	0,17	40-70

29 KARBÜR DÜZ RAYBALAR

29 CARBIDE FLAT REAMERS

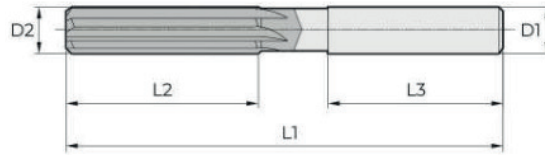

Takım Kodu Order Code	D1	D2(h6)	L1	L2	L3	Ağız Sayısı
EDR-H7-0400	4	4	70	28	20	6
EDR-H7-0500	5	5	70	28	22	6
EDR-H7-0600	6	6	100	36	22	6
EDR-H7-0700	7	7	110	42	25	6
EDR-H7-0800	8	8	110	42	25	6
EDR-H7-0900	9	9	110	42	25	6
EDR-H7-1000	10	10	110	38	25	6
EDR-H7-1100	11	11	110	38	28	6
EDR-H7-1200	12	12	110	38	28	6
EDR-H7-1300	13	13	110	38	28	6
EDR-H7-1400	14	14	110	38	32	6
EDR-H7-1500	15	15	110	38	32	6
EDR-H7-1600	16	16	150	52	32	6
EDR-H7-1800	18	18	150	52	36	6
EDR-H7-2000	20	20	150	50	36	6

29 KARBÜR HELİS RAYBALAR

CARBIDE HELIC REAMERS

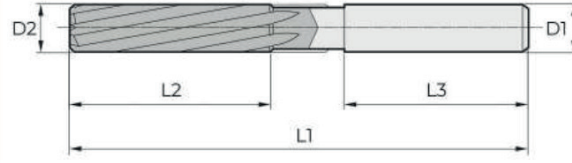

Takım Kodu Order Code	D1	D2(h6)	L1	L2	L3	Ağız Sayısı
EDR-H7-0400	4	4	70	28	20	6
EDR-H7-0450	5	5	70	28	22	6
EDR-H7-0500	6	6	100	36	22	6
EDR-H7-0600	7	7	110	42	25	6
EDR-H7-0700	8	8	110	42	25	6
EDR-H7-0800	9	9	110	42	25	6
EDR-H7-0900	10	10	110	38	25	6
EDR-H7-1000	11	11	110	38	28	6
EDR-H7-1100	12	12	110	38	28	6
EDR-H7-1150	13	13	110	38	28	6
EDR-H7-1200	14	14	110	38	32	6
EDR-H7-1500	15	15	110	38	32	6
EDR-H7-1600	16	16	150	52	32	6
EDR-H7-1800	18	18	150	52	36	6
EDR-H7-2000	20	20	150	50	36	6



www.euroloy.com

Head Office - Via Leonardo Da Vinci, 4
- 20054, Segrate
Milano MI ITALIA

Euroloy Italia (+39) 0282398309
Euroloy Turkey (+90) 850 933 3408

✉ info@euroloy.com

📷 [@euroloytools](https://www.instagram.com/euroloytools)

